

# 5255 N EDGEWOOD DRIVE

FOR SALE OR LEASE



## PROPERTY DETAILS

5255 N. Edgewood Drive, Provo, Utah 84604

- Minimum of 1,542 SF up to 65,217 SF of Class "A" office space
- Sales Price: \$6,038,355 - \$19,239,015 (\$295 PSF)
  - » First Floor: 20,469 RSF
  - » Second Floor: 21,290 RSF
  - » Third Floor: 22,762 RSF
- Lease Price: \$24.50 PSF / Full Service
- Fiber optic network
- Beautiful views of Timpanogos
- 40 underground parking stalls and storage spaces available
- Close to shops at Riverwoods and numerous restaurants
- Adjacent to the Provo River with direct access to the Provo River Trail
- Located off of University Avenue in Provo, with access to Canyon Parkway and I-15
- Ten miles from the Sundance Mountain Resort and nine miles from the Provo Airport

### Surrounding Tenants



## 2025 DEMOS

### EST. POPULATION

- 1 MILE » 8,958
- 3 MILE » 90,533
- 5 MILE » 219,524

### EST. HOUSEHOLDS

- 1 MILE » 2,570
- 3 MILE » 28,255
- 5 MILE » 67,146

### EST. AVERAGE HH INCOME

- 1 MILE » \$173,305
- 3 MILE » \$122,344
- 5 MILE » \$109,303



**CODY BLACK**  
 cody@summitutahcre.com  
 direct: 801.687.0094  
 office: 801.435.5005  
[View Profile](#)

FULL SERVICE COMMERCIAL REAL ESTATE 1875 S State St. Suite 1000, P.O. Box 970432, Orem, UT 84097



**CODY BLACK**

[cody@summitutahcre.com](mailto:cody@summitutahcre.com)

direct: 801.687.0094

office: 801.435.5005

[View Profile](#)

**FULL SERVICE COMMERCIAL REAL ESTATE 1875 S State St. Suite 1000, P. O. Box 970432, Orem, UT 84097**

This statement with the information it contains is given with the understanding that all negotiations relating to the purchase, renting or leasing of the property described above shall be conducted through this office.



**CODY BLACK**

[cody@summitutahre.com](mailto:cody@summitutahre.com)

direct: 801.687.0094

office: 801.435.5005

[View Profile](#)

**FULL SERVICE COMMERCIAL REAL ESTATE 1875 S State St. Suite 1000, P. O. Box 970432, Orem, UT 84097**

This statement with the information it contains is given with the understanding that all negotiations relating to the purchase, renting or leasing of the property described above shall be conducted through this office.

# 5255 N EDGEWOOD DRIVE

## Basement

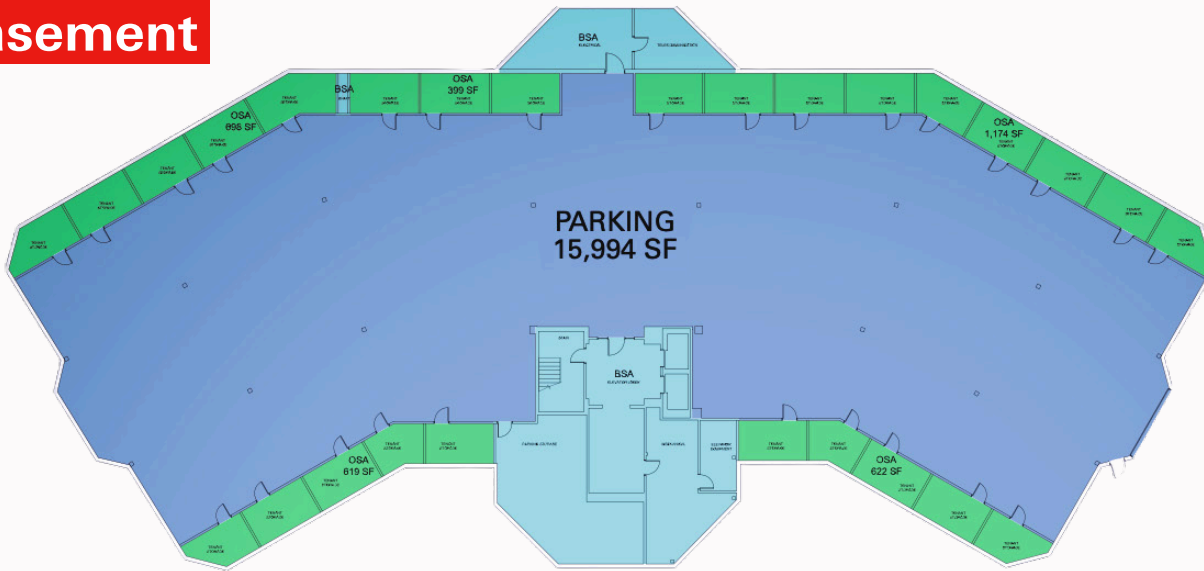

FLOOR PLAN

## Level 1

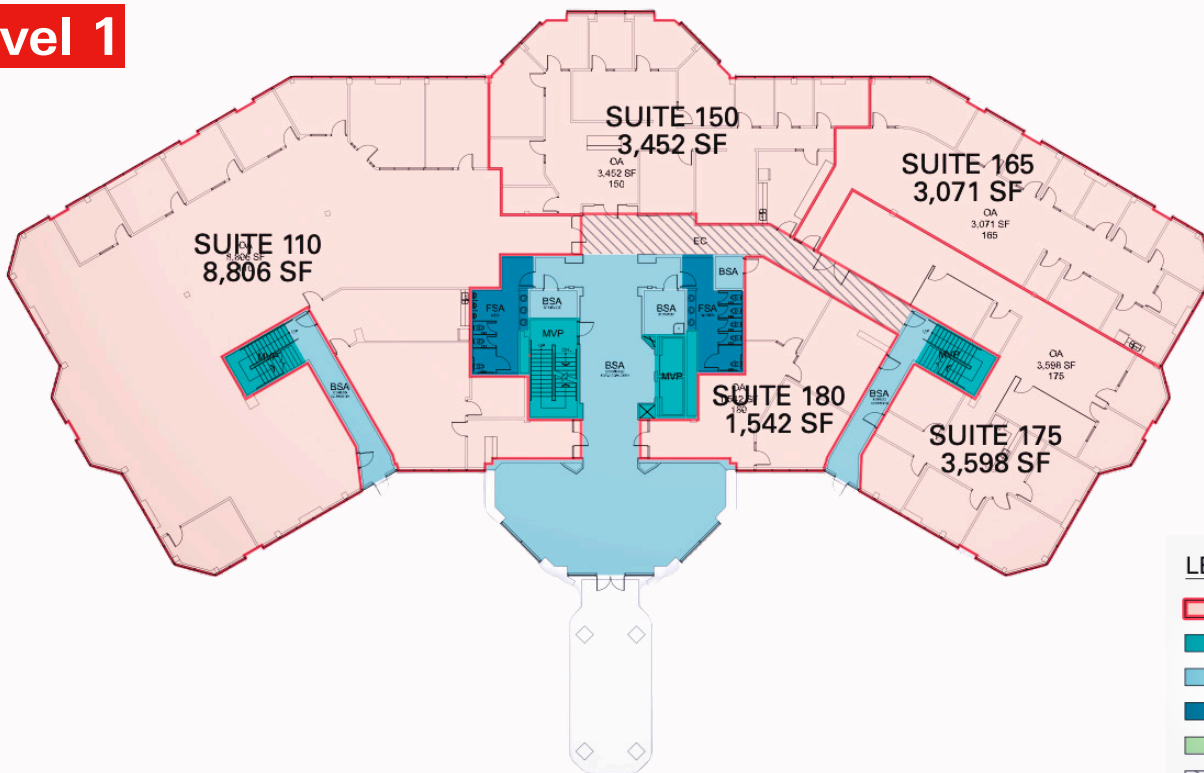

### LEGEND

- OCCUPANT AREA - OA
- MAJOR VERTICAL PENETRATION - MVP
- BUILDING SERVICE AREA - BSA
- FLOOR SERVICE AREA - FSA
- BASE BUILDING CIRCULATION - BBC
- EXTENDED CIRCULATION - EC



### CODY BLACK

cody@summitutahcre.com

direct: 801.687.0094

office: 801.435.5005

[View Profile](#)

FULL SERVICE COMMERCIAL REAL ESTATE 1875 S State St. Suite 1000, P. O. Box 970432, Orem, UT 84097

This statement with the information it contains is given with the understanding that all negotiations relating to the purchase, renting or leasing of the property described above shall be conducted through this office.

# 5255 N EDGEWOOD DRIVE

## Level 2

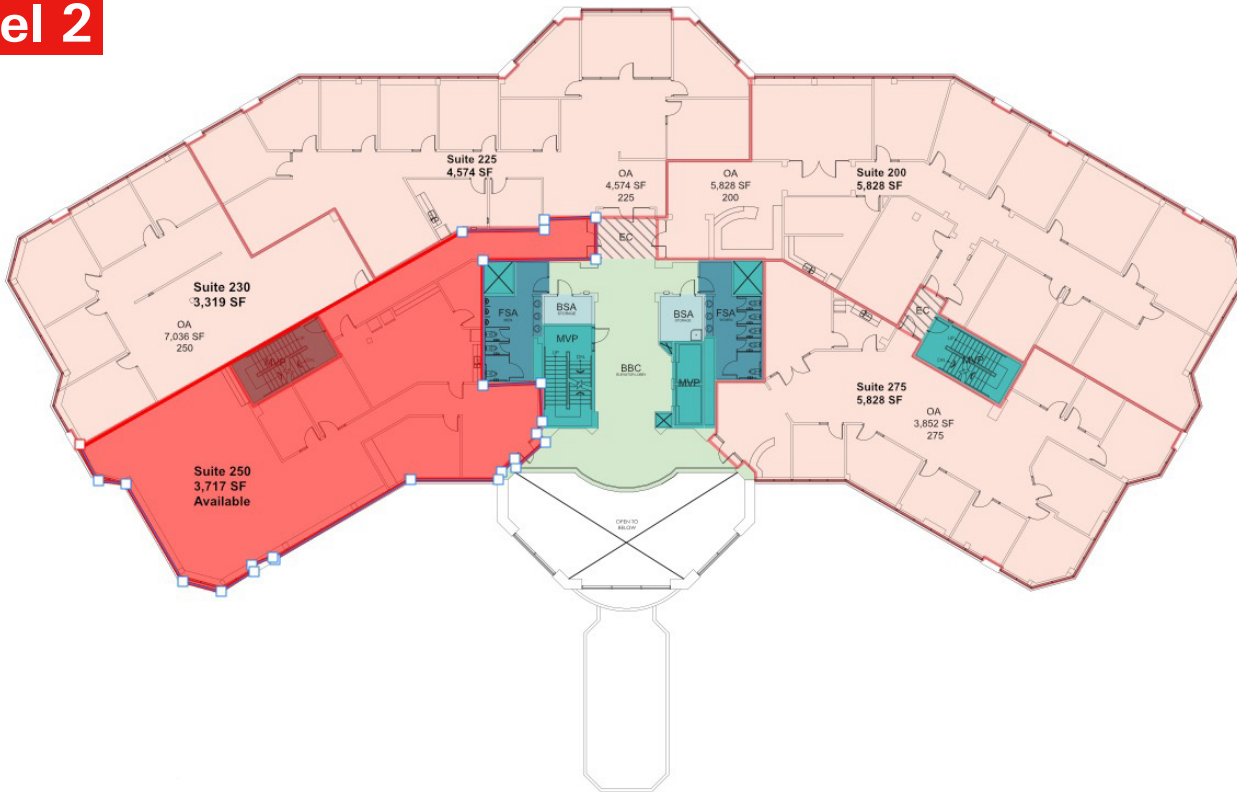

## Level 3

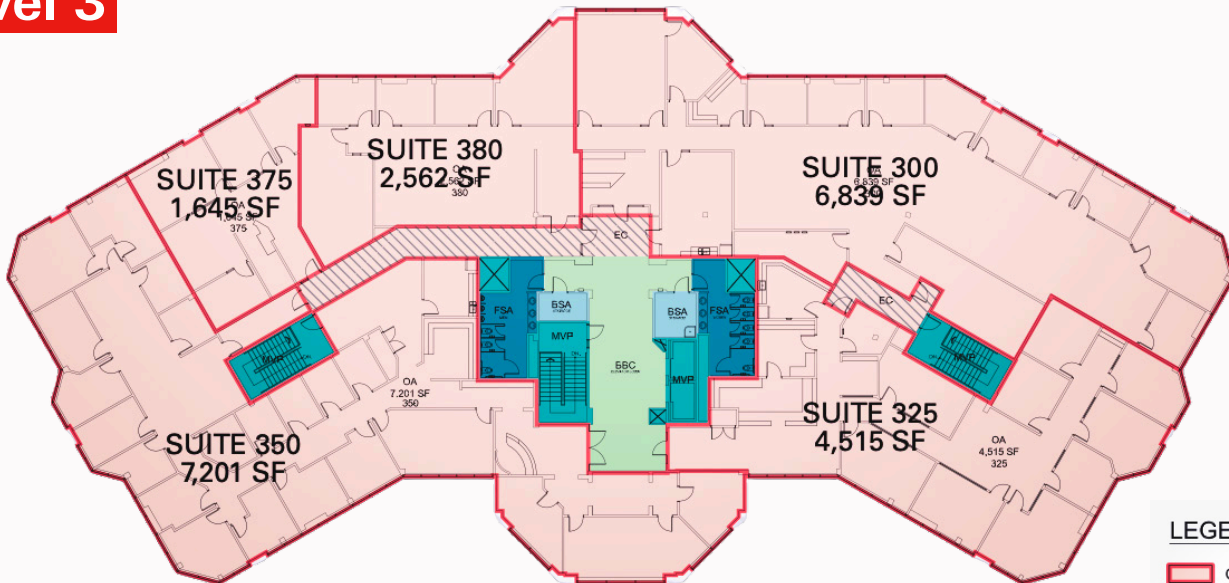

### LEGEND

- ▭ OCCUPANT AREA - OA
- ▭ MAJOR VERTICAL PENETRATION - MVP
- ▭ BUILDING SERVICE AREA - BSA
- ▭ FLOOR SERVICE AREA - FSA
- ▭ BASE BUILDING CIRCULATION - BBC
- ▭ EXTENDED CIRCULATION - EC

FLOOR PLAN



### CODY BLACK

cody@summitutahcre.com

direct: 801.687.0094

office: 801.435.5005

[View Profile](#)

FULL SERVICE COMMERCIAL REAL ESTATE 1875 S State St. Suite 1000, P. O. Box 970432, Orem, UT 84097