

N/F
BUTLER ENTERPRISES INC.
PIN: 26U6V6-00A018000

N/F
NEW AGE DEVEL CO. INC.
PIN: 26U6-00A018000
DB 2318, PG 408

N/F
NEW AGE DEVEL CO. INC.
PIN: 26U6-00A018000
DB 2318, PG 408

N/F
NEW AGE DEVEL CO. INC.
PIN: 26U6-00A018000
DB 2318, PG 408

N/F
PENNANT FOODS COMPANY LLC
PIN: 26U6S3-00106U000

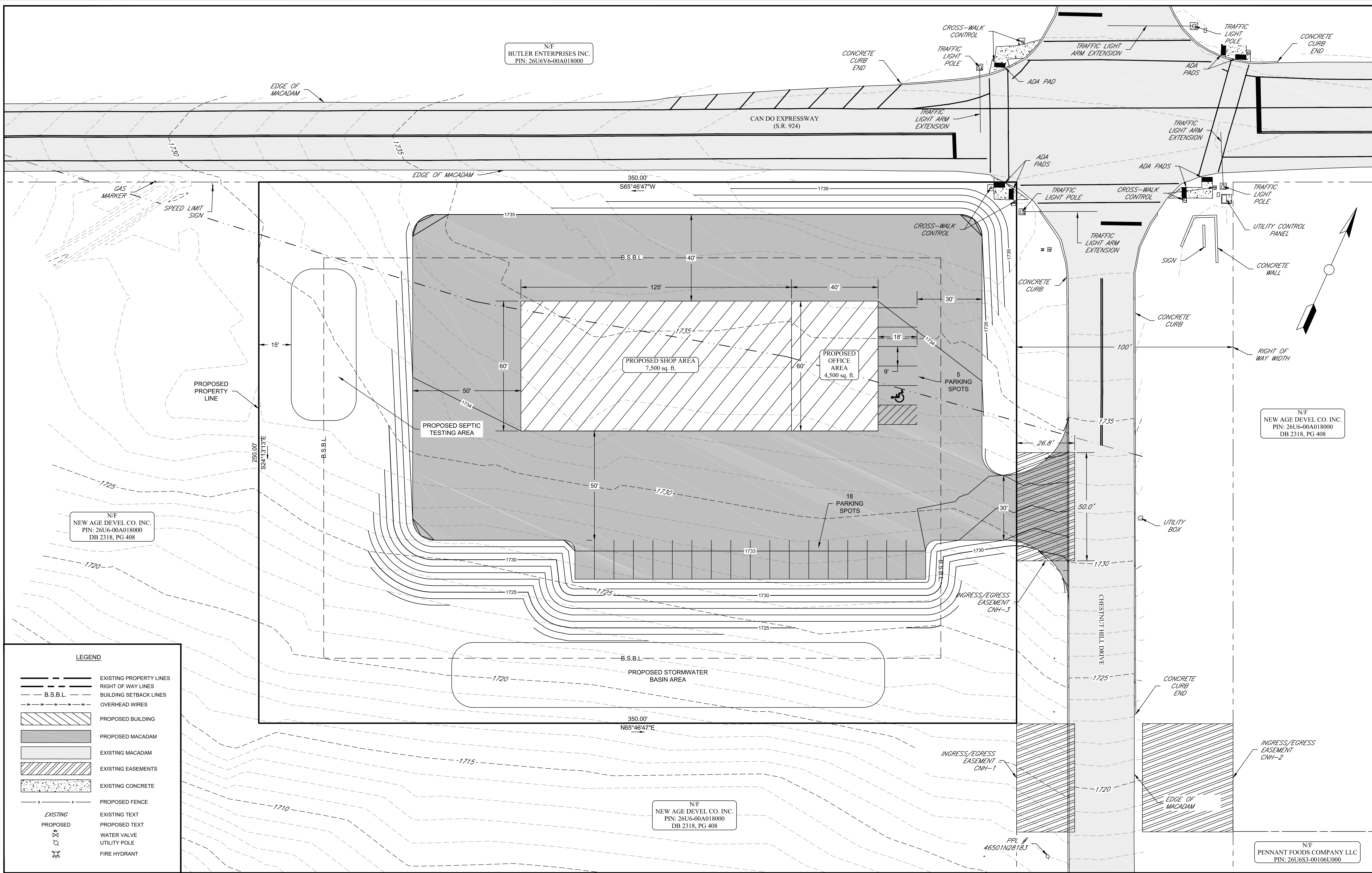

LEGEND

- EXISTING PROPERTY LINES
- - - RIGHT OF WAY LINES
- - - B.S.B.L. BUILDING SETBACK LINES
- - - OVERHEAD WIRES
- ▨ PROPOSED BUILDING
- ▨ PROPOSED MACADAM
- ▨ EXISTING MACADAM
- ▨ EXISTING EASEMENTS
- ▨ EXISTING CONCRETE
- - - PROPOSED FENCE
- EXISTING
- PROPOSED
- EXISTING TEXT
- PROPOSED TEXT
- WATER VALVE
- UTILITY POLE
- FIRE HYDRANT

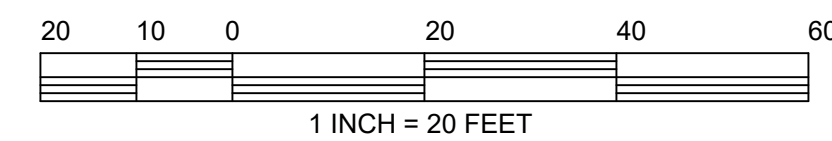

DATE	REVISIONS	BY

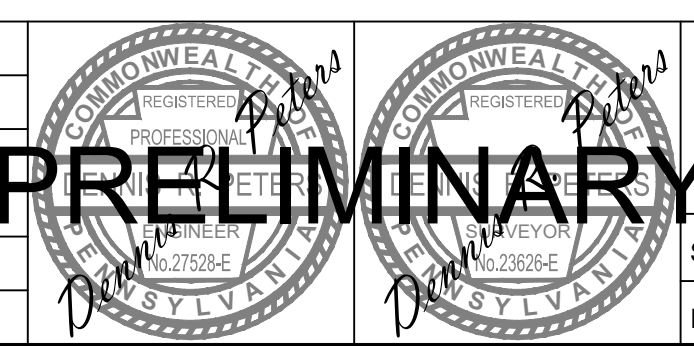

PETERS CONSULTANTS, INC.
CONSULTING ENGINEERS/LAND SURVEYORS
info@petersconsultants.com - www.petersconsultants.com
2701 Columbia Blvd., Bloomsburg, PA, 17815
Phone Number: 707-752-4433

Date: 02/08/24
Ck. By: DRP
Sheet 1 of 1

PROPOSED SITE PLAN
LANDS OF
NEW AGE DEVELOPMENT COMPANY INC.
PIN: 26U6-00A018000 - DEED BOOK: 2318, PAGE: 408
PREPARED FOR
LP INNOVATIONS, LLC.
HAZLE TOWNSHIP - LUZERNE COUNTY - PENNSYLVANIA

PROJECT: 3516 - DRAWING: 3516-LP-Innovation.dwg - LAYOUT: Plan

COPYRIGHT PETERS CONSULTANTS, INC. 2023. THESE PLANS ARE INSTRUMENTS OF SERVICE AND REMAIN THE EXCLUSIVE PROPERTY OF PETERS CONSULTANTS, INC. THE CLIENT IS GRANTED A NON-EXCLUSIVE LICENSE TO USE THE PLANS HEREIN TO CONSTRUCT THE PROJECT DESCRIBED ON THE PLANS. THE PLANS MAY NOT BE MODIFIED IN ANY WAY AND MAY NOT BE USED FOR SUBSEQUENT ADDITIONS, REVISIONS, MODIFICATIONS OR ALTERATIONS TO THE PROJECT WITHOUT THE EXPRESS WRITTEN CONSENT OF PETERS CONSULTANTS, INC. PETERS CONSULTANTS, INC. ASSUMES NO LIABILITY FOR USE OF THE PLANS BEYOND THE NON-EXCLUSIVE LICENSE GRANTED HEREIN.