

# 8501 Younger Creek Drive

POWER INN SUBMARKET

SACRAMENTO, CA

±10,833 SF Industrial Building including ±1,080 SF Office



## Contact Us

**Zac Sweet** SIOR

Senior Vice President  
+1 916 717 4768  
zac.sweet@cbre.com  
Lic. 01352800

**Jeff Kvarme**

First Vice President  
+1 916 203 5257  
jeff.kvarme@cbre.com  
Lic. 01924968

**Tyler Howell**

Senior Associate  
+1 916 781 4835  
tyler.howell1@cbre.com  
Lic. 02100245

**Courtney Lee**

Associate  
+1 916 906 5544  
courtney.lee@cbre.com  
Lic. 02031694

**Stacy Ladd**

Senior Asset Manager, Buzz Oates  
+1 916 379 3847  
stacyladd@buzzoates.com  
Lic. 01214064

# PROPERTY INFORMATION

## 8501 YOUNGER CREEK DRIVE SACRAMENTO, CA 95828

- Building Area: ±10,833 SF\*
- ±9,753 SF Warehouse\*
- ±1,080 SF Office\*
- Clear Height: 16'-19'
- 1 (12x14') Grade Level Door  
Ability to expand to 6 Grade Level Doors
- Zoning: M-2S Heavy Industrial\*
- Good Access to Highway 50
- Visibility on Florin Perkins Road
- 800 amps 277/480V\*



\*TENANT TO INDEPENDENTLY VERIFY PRIOR TO ENTERING BINDING AGREEMENT

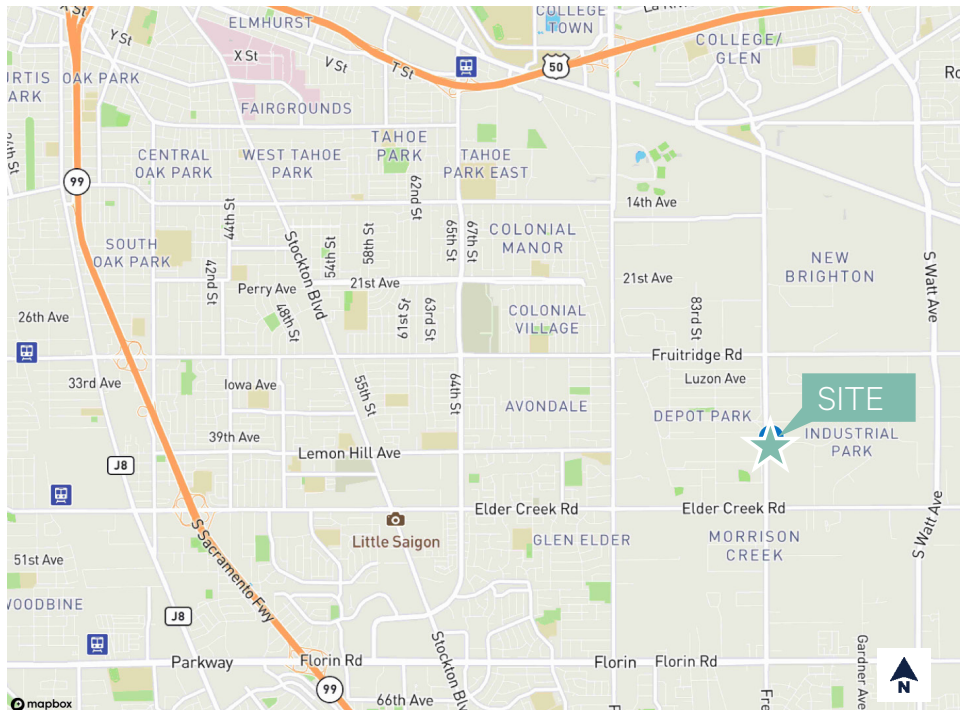

# PROPERTY IMAGES



# FLOOR PLAN

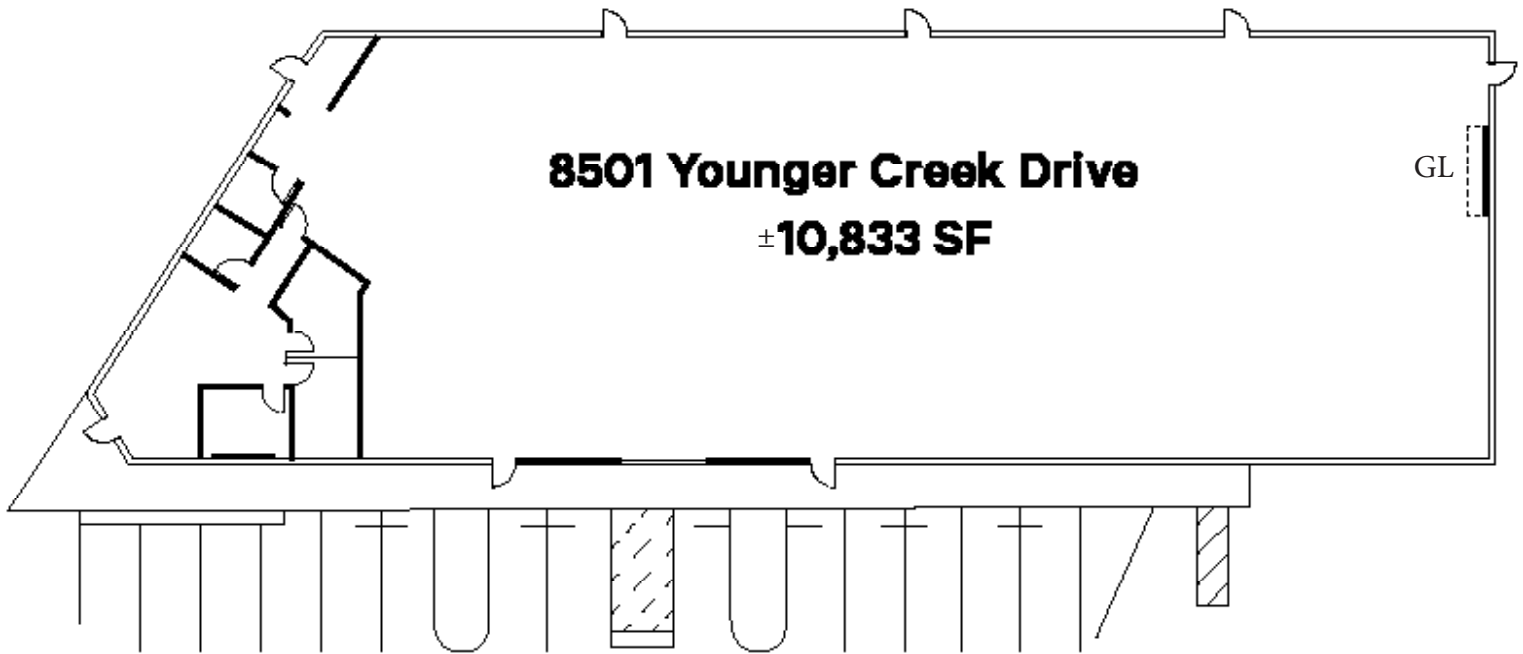

*Floorplan not to scale*  
*GL : Grade Level Door*

## Contact Us

**Zac Sweet SIOR**

Senior Vice President  
+1 916 717 4768  
zac.sweet@cbre.com  
Lic. 01352800

**Jeff Kvarme**

First Vice President  
+1 916 203 5257  
jeff.kvarme@cbre.com  
Lic. 01924968

**Tyler Howell**

Senior Associate  
+1 916 781 4835  
tyler.howell1@cbre.com  
Lic. 02100245

**Courtney Lee**

Associate  
+1 916 906 5544  
courtney.lee@cbre.com  
Lic. 02031694

**Stacy Ladd**

Senior Asset Manager, Buzz Oates  
+1 916 379 3847  
stacyladd@buzzoates.com  
Lic. 01214064