

# CHESTERFIELD PROFESSIONAL PARK

FOR LEASE

2-4 West Drive  
Chesterfield, MO 63017



# PROPERTY FEATURES



- 993 SF first floor office space with private suite entry available at Chesterfield Professional Park
- Great opportunity for professional services firm or conversion to medical office
- Exterior building and monument signage available
- Conveniently located at Highway 40/Olive Blvd near numerous retail amenities
- Lease Rate: \$18.00/SF NNN

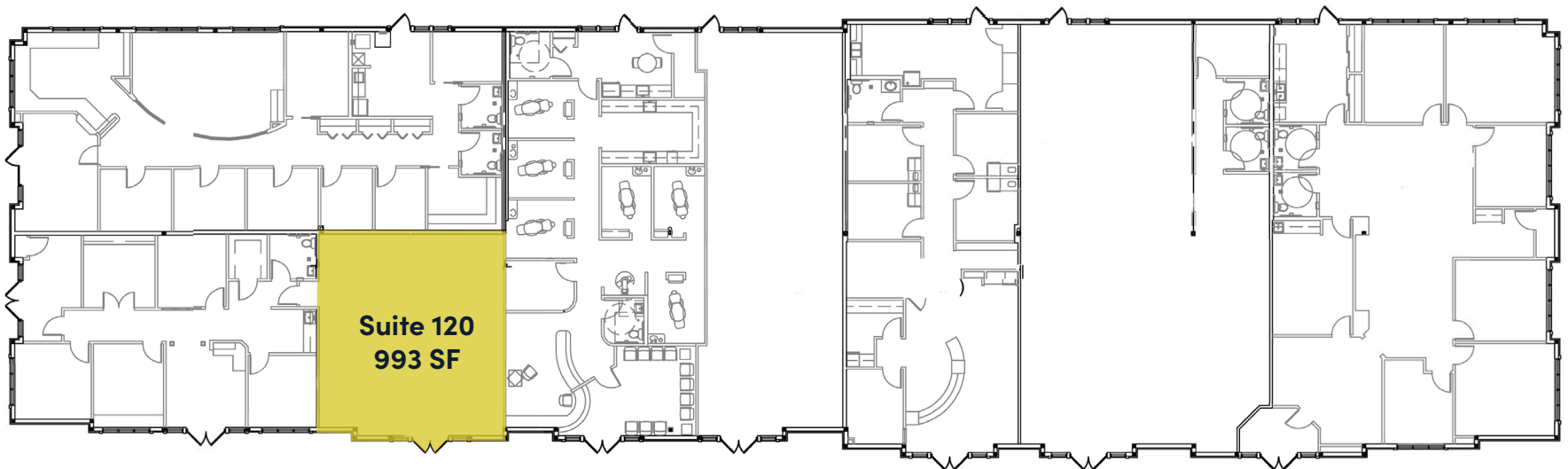

Total Building 16,751 gross sq. ft.

 **Space Plan**  
Scale: 1/16" = 1'-0"

# PRIME LOCATION



**DIERBERGS MARKET PLACE**  
Dierbergs, Billy G's, Starbucks

**CLARKSON SQUARE**  
US Bank, Total Wine, IMOS, Jimmy Johns, McDonalds

**CHESTERFIELD CROSSING**  
Trader Joe's, Smashburger, Sauce on the Side, Crazy Bowls & Wraps, Commerce Bank

**WILDHORSE CREEK DEVELOPMENT**

**CHESTERFIELD OAKS**  
Barnes & Nobel, The Alpine Shop, Crumbl, St. Louis Bread Co

**Future Downtown Chesterfield Development**

**DREW STATION**  
Central Bank, FedEx, Crushed Red, Fin, Chipotle

Sonesta Suites

Fairfield Inn

Mercy

Waterway Car Wash

Starbucks

Walgreens

Hyatt

YaYa's Bistro

Pfizer

Hampton Inn

Edgewild

Bishop's Post

Chesterfield YMCA

Ruth's Chris Steakhouse

AC Hotel

RGA

**HILLTOWN VILLAGE CENTER I**  
Schnucks, Mellow Mushroom, Thai Sawadee, US Bank, First Watch, Harpos

Homewood Suites



OLIVE BLVD

OLIVE BLVD

CONTACT THE BROKER



**ED BAKER | SIOR**

Principal

(314)744-8997

[ebacker@intcre.com](mailto:ebacker@intcre.com)

