

FOR LEASE

Colliers

1200 Hampton Park Blvd.
Capitol Heights, MD 20743

Suite 200 | 35,475 SF with 3,035 SF of Office Space



Brian Watts

Executive Vice President
+1 410 319 2408
Brian.Watts@colliers.com

Jason Sullivan, SIOR

Executive Vice President
+1 410 319 2409
Jason.Sullivan@colliers.com

Melissa Parrish

Associate Vice President
+1 410 319 2412
Melissa.Parrish@colliers.com

Brian Siegel, SIOR

Executive Vice President
+1 410 319 2410
Brian.Siegel@colliers.com

Tom Gentner

Executive Vice President
+1 410 319 2407
Tom.Gentner@colliers.com

Property Overview

1200 Hampton Park Blvd.
Capitol Heights, MD 20743

Total Building Size	176,978 SF
Ceiling Height	32' Clear
Column Spacing	50' W x 50' D
Sprinkler Systems	ESFR
Power	4,000a/277 - 480v 3p 4w Heavy
Year Built	2015
Class	A
Amenities	Multitude within walking distance



Space Highlights

1200 Hampton Park Blvd.
Capitol Heights, MD 20743

Suite 200	
Available Space	35,475 SF
Existing Office	3,035 SF
Docks	5 loading docks
Parking	Abundant parking at main entrance
Condition	First generation space. Office space is in excellent condition.
Lighting	LED in warehouse

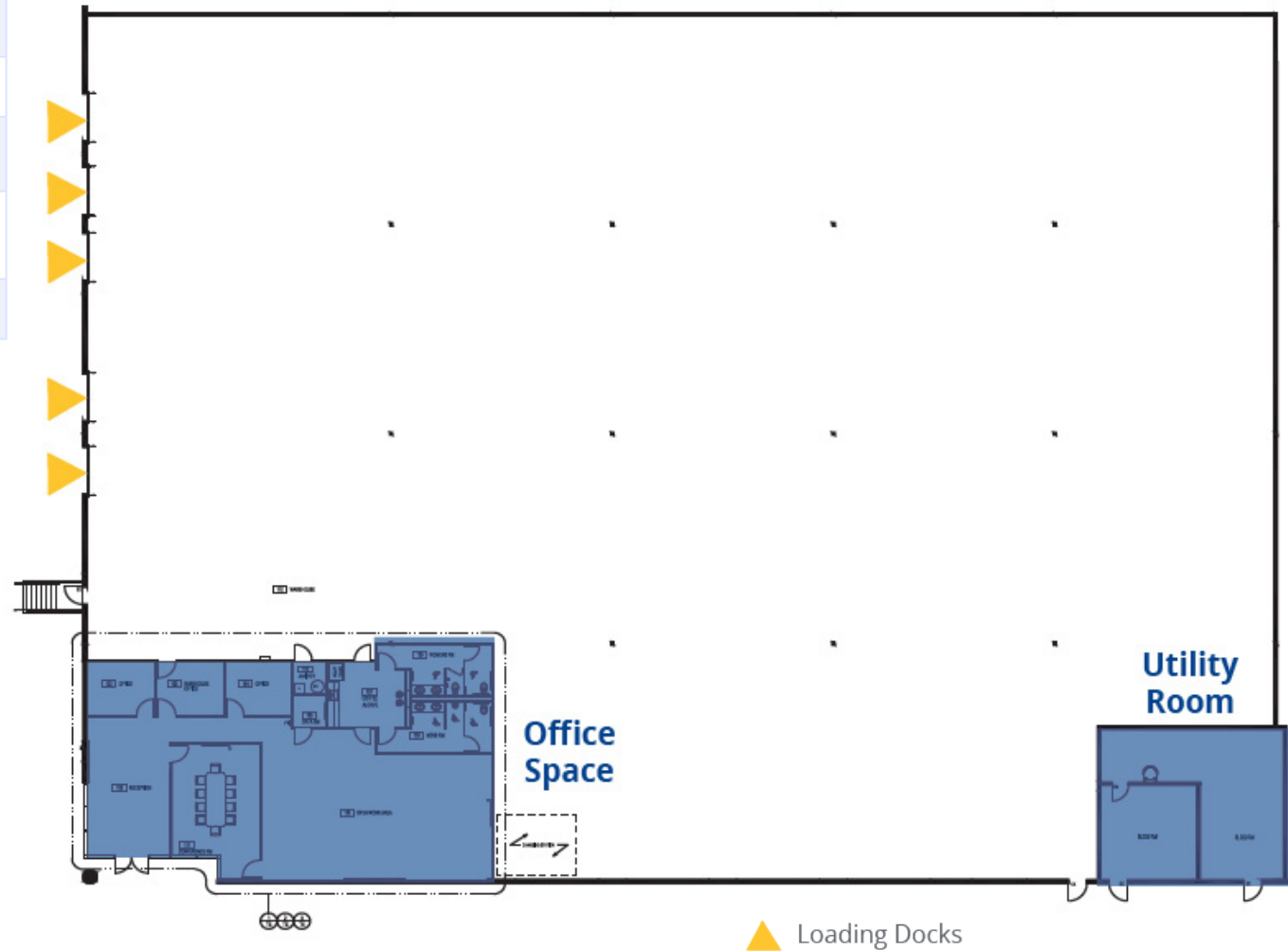

Contact

Brian Watts

Executive Vice President
+1 410 319 2408
brian.watts@colliers.com

Jason Sullivan, SIOR

Executive Vice President
+1 410 319 2409
jason.sullivan@colliers.com

Melissa Parrish

Associate Vice President
+1 410 319 2412
melissa.parrish@colliers.com

Brian Siegel, SIOR

Executive Vice President
+1 410 319 2410
brian.siegel@colliers.com

Tom Gentner

Executive Vice President
+1 410 319 2407
tom.gentner@colliers.com



7001 Columbia Gateway Dr
Suite 220
Columbia, MD 21046

1200 Hampton Park Blvd.
Capitol Heights, MD 20743

