



- Ample parking
- Multi-building light industrial complex on 9.77 acres.
- Pylon signage and building signage available
- Store room with direct outside access.
- Dedicated main entry and reception area
- Less than 2 miles to I-90 ramps at Sullivan Road.
- Common area restrooms and kitchenette

Tenants include Cosmos Granite, Interstate Battery, Complete Suite Furniture, Hardwoods, Inc., College Hunks Movers, Kokua Volleyball Club and Evergreen Railroad Club.

AVAILABLE SPACE	SIZE	BASE RENT
Bldg. 1 Suites A&B	3,938 SF	\$2,250/Month
Bldg. 1 Fenced Yard	4,400 SF	\$250/Month
Total		\$2,500/Month/NNN

CONTACT

DAVE DOWERS
509.606.5092
daved@tokcommercial.com

HIGHLIGHTS



DETAILS



CENTER SIZE	173,360 SF	LEASE TYPE	NNN
PROPERTY TYPE	Office/Warehouse	EST. NNN'S	\$0.25/SF
POWER	400 A, 480/227 V	AVAILABLE	Immediately

3014 N. FLORA ROAD BUILDING ONE OFFICE

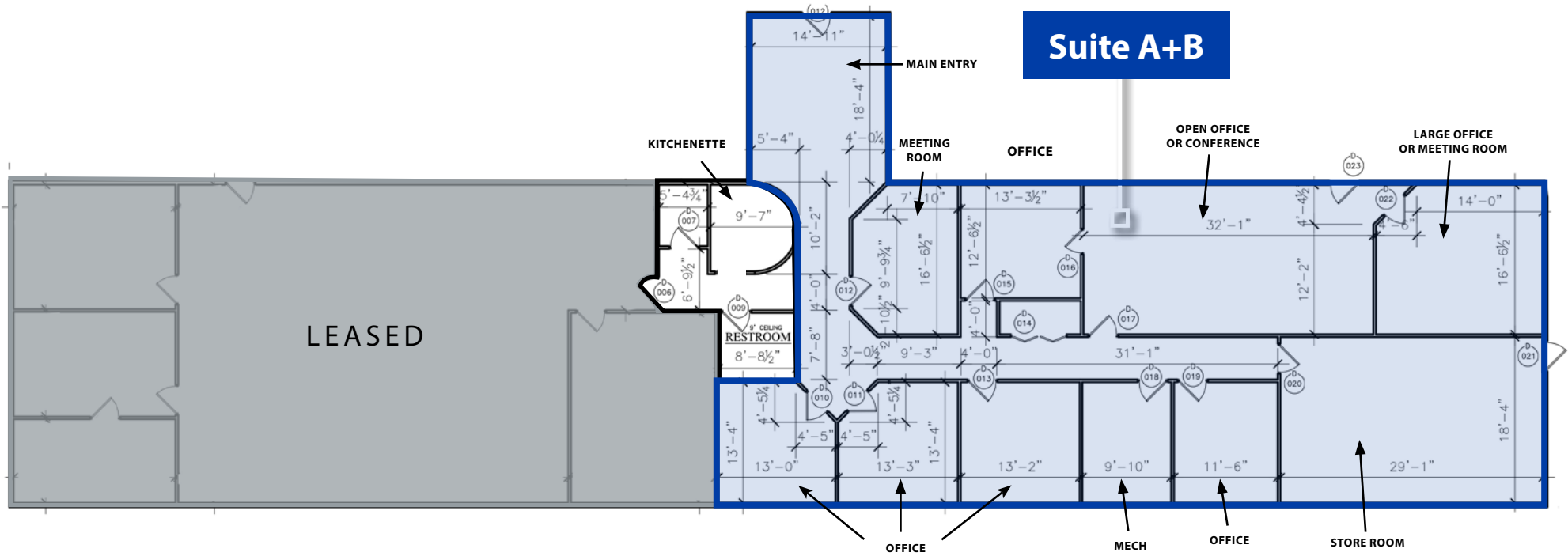



BUILDING ONE





THE PARK

3,181 VPD

5,632 VPD

EEUCLID AVE

EEUCLID AVE

SUITE A&B

N FLORA RD

FENCED YARD





← 3 MIN DRIVE TO STATE HWY 290 →

SITE

- Olive Garden
- OUTBACK STEAKHOUSES
- pure barre
- Staples
- Cafe Rio MEXICAN GRILL
- BUFFALO WILD WINGS
- DAVID'S BRIDAL
- T.J. MAXX
- JCPenney
- ★ macy's
- Red Robin
- IHOP
- Krispy Kreme DOUGHNUTS
- Arby's

← 5 MIN DRIVE TO I-90
DIRECT CONNECTION TO
WEST-EAST FREEWAY →