

FOR SUBLEASE

±19,114^{SF}
Industrial Unit

4495 Wall St, Unit 101 | Ontario, CA 91761



- ▷ ±19,114 SF Industrial Unit
- ▷ ±1,200 SF of Office Space
- ▷ 0.60 GPM / 3,000 SF Sprinkler System
- ▷ Four (4) Dock High Doors
- ▷ One (1) Ground Level Door
- ▷ 28' Minimum Clear Height
- ▷ Excellent I-10 and I-15 Access
- ▷ High Visibility Corner Unit
- ▷ Sublease Expiration Date: February 28, 2030

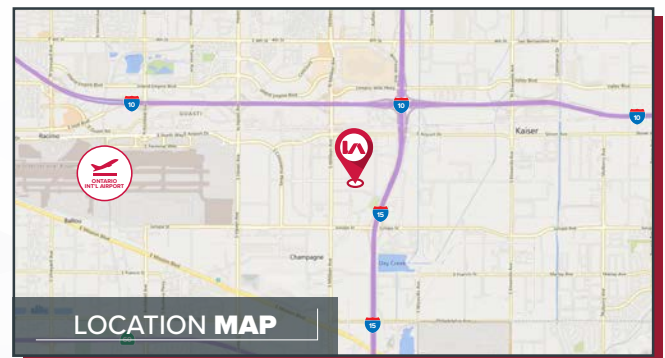
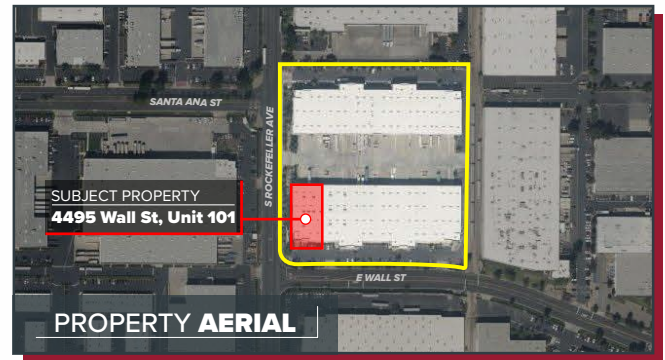

PROPERTY FEATURES

For more information please contact



KEVIN CHING, SIOR
Senior Vice President | Lic ID # 01899995
P 626.701.2405
E kching@lee-associates.com



JUSTIN CHIANG
Senior Vice President | Lic ID # 01903437
P 626.701.2401
E jchiang@lee-associates.com



JERRY HU
Lic ID # 02157943
P 626.701.2406
E jhu@lee-associates.com

FOR SUBLEASE

±19,114^{SF}
Industrial Unit

4495 Wall St, Unit 101 | Ontario, CA 91761

PROPERTY SITE PLAN

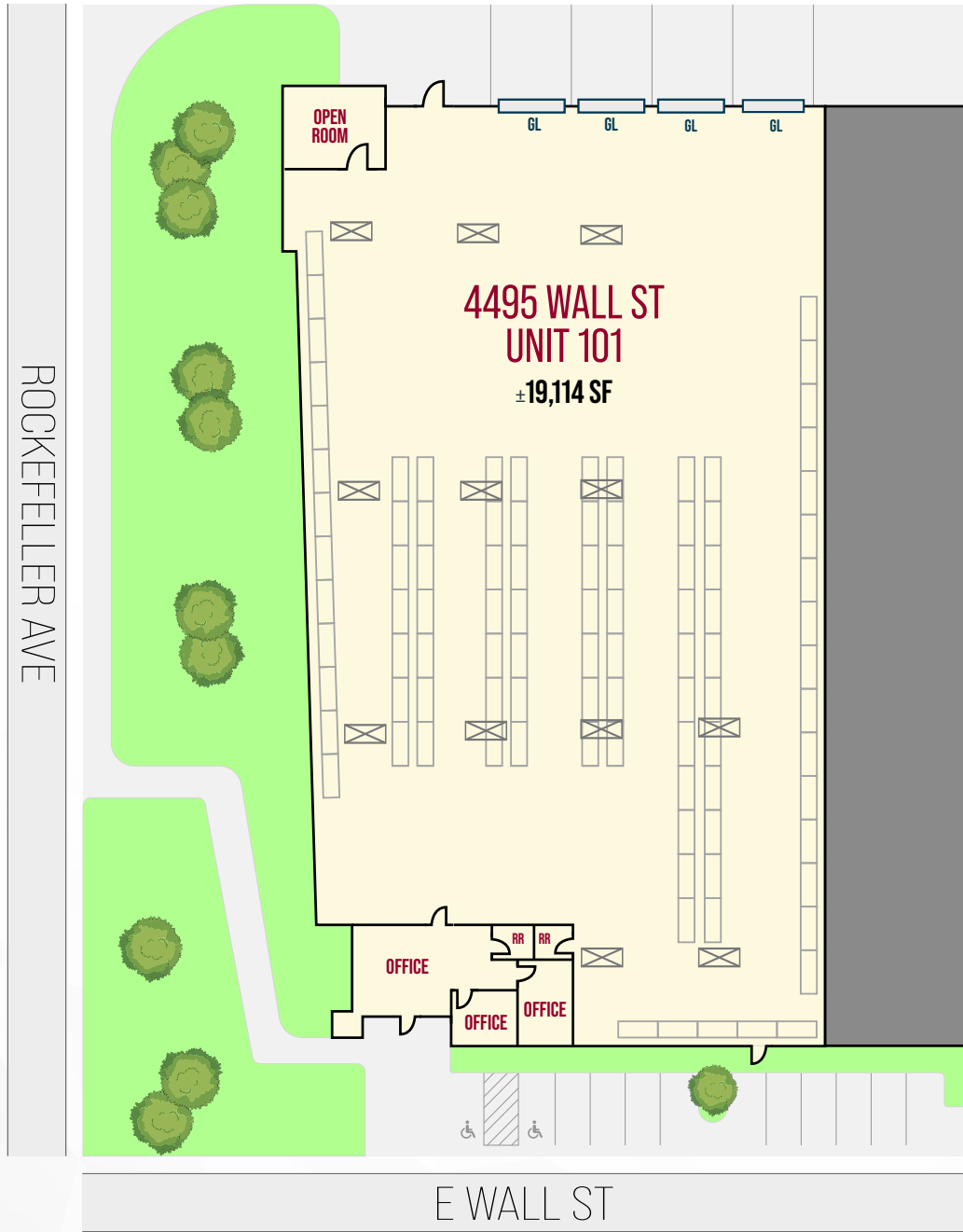

NOTE: All measurements shown on this floor plan are approximate and provided for general reference only. They have not been verified by a licensed architect or professional and should not be relied upon for exact dimensions.

For more information please contact



KEVIN CHING, SIOR
Senior Vice President | Lic ID # 01899995
P 626.701.2405
E kching@lee-associates.com



JUSTIN CHIANG
Senior Vice President | Lic ID # 01903437
P 626.701.2401
E jchiang@lee-associates.com



JERRY HU
Lic ID # 02157943
P 626.701.2406
E jhu@lee-associates.com