

► SUITE 1005

► **PRICING SUMMARY:**
Size: 1,880 SF
Base Rent: \$9.50 PSF/yr.
Triple Nets: \$8.16 PSF/yr.
Total: \$2,766.73/mo.

- **COMMENTS**
- Open Ceiling
 - Bathroom
 - Overhead Door (currently covered by drywall)

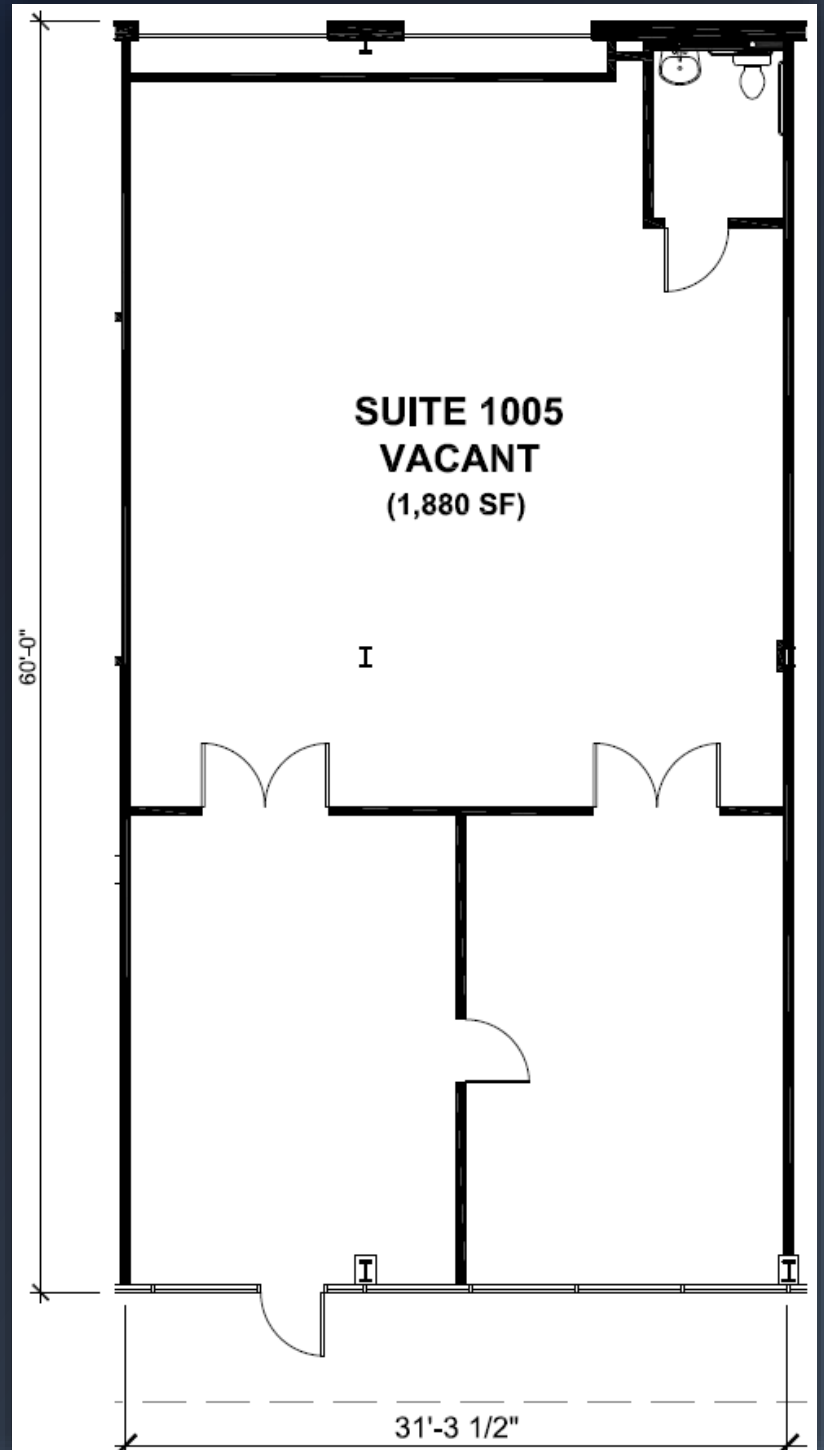

Phillip Carameros (832.937.5900) phillip@gordonpartners.com | Jenny Nguyen (409.900.2060) jenny@gordonpartners.com