

**185 HARRY S. TRUMAN PKWY**  
SUITE 100 | ANNAPOLIS, MD

Professional Office Space  
**Annapolis Corporate Park**  
**FOR SUBLEASE**



**ROSSO**  
COMMERCIAL

[www.RossoCRE.com](http://www.RossoCRE.com)

MOVING COMMERCIAL REAL ESTATE GOALS **FORWARD.**

# 185 HARRY S. TRUMAN PKWY

SUITE 100 | ANNAPOLIS, MD



## PROPERTY HIGHLIGHTS:

- 2,756 SF+/- medical office space
- Fully built-out, high-end ground-floor entry with multiple private offices, consultation rooms, and large conference space and reception area
- Excellent access just off Route 50 and Route 665 in a professional campus setting with convenient parking
- Term Remaining: Through April 2029 (~35 months)
- Contact Broker for additional information

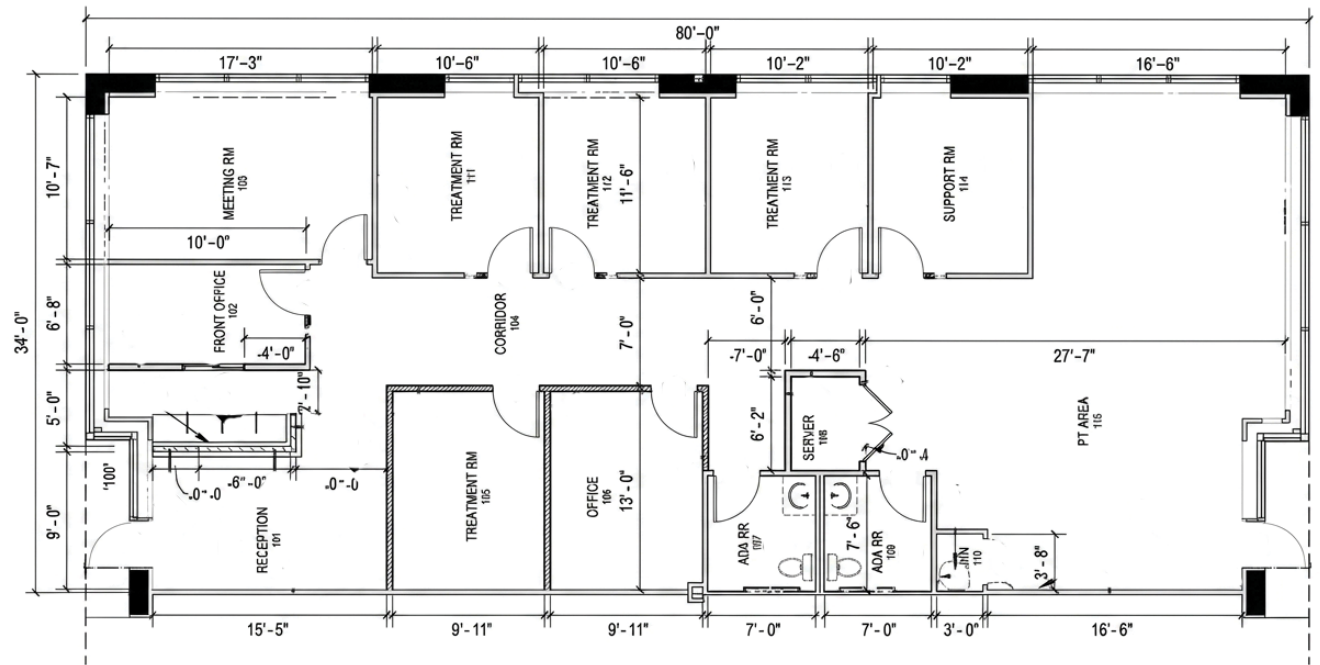

## BUILDING HIGHLIGHTS:

|                       |                       |
|-----------------------|-----------------------|
| <b>SQUARE FOOTAGE</b> | 31,280 SF             |
| <b>LEED</b>           | Certified Gold        |
| <b>CEILING HEIGHT</b> | 10 ft. Clear Minimum  |
| <b>PARKING</b>        | 5 spaces per 1,000 SF |
| <b>HEATING</b>        | Gas                   |
| <b>ZONING</b>         | C-2                   |



MOVING COMMERCIAL REAL ESTATE GOALS **FORWARD.**

While we have no reason to doubt the accuracy of any of the information supplied, we cannot, and do not, guarantee its accuracy. All information should be independently verified prior to a purchase or lease of the property. We are not responsible for errors, omissions, misuse, or misinterpretation of information contained herein and make no warranty of any kind, express or implied, with respect to the property or any other matters.

# Property Overview



Prime Office  
Space Available  
in Annapolis  
Corporate Park



# Area Overview



**ANNAPOLIS CORPORATE PARK**  
**185 HARRY S. TRUMAN PKWY**  
 SUITE 100 | ANNAPOLIS, MD

**GATEWAY VILLAGE**

SAFeway, PET SMART, Staples, BEST BUY, lemongrass, DICK'S SPORTING GOODS

UNCLE JULIO'S MEXICAN from Scratch, WELLS FARGO, THE LODGE ANNEBOROUGH, RED LOBSTER FRESH FISH-LIVE LOBSTER

**ANNAPOLIS MALL**

Apple, Crate & Barrel, macy's, The Container Store, noodles, THE NORTH FACE, MAGGIANO'S LITTLE ITALY, californina PIZZA KITCHEN

**ANNAPOLIS TOWN CENTER**

PF. CHANG'S, WILLIAMS SONOMA CALIFORNIA, WHOLE FOODS MARKET, AT&T, POTTERY BARN, J. ALEXANDER'S RESTAURANT, COOPER'S HAWK WINERY & RESTAURANTS, ANTHROPOLOGIE, TARGET, TRUE FOOD KITCHEN

**FESTIVAL AT RIVA**

WINDMILL WINDS, Tronera, MOD, Giant, petco, TJ-maxx, five BELOW, Michaels, Party City

**FOREST PLAZA**

THE HOME DEPOT, DOLLAR TREE, Bliss, Julep, OUTBACK STEAKHOUSE

**ANNAPOLIS TECHNOLOGY PARK**

CVS pharmacy, Squish, TRUIST, SUBWAY, INGRANO, Corner Cafe

**ANNAPOLIS HARBOUR CENTER**

THE FRESH MARKET, Starbucks, POTBELLY, ROBESK, FRIDAYS, BARNES & NOBLE BOOKSELLERS, OLD NAVY, pure barre, PLAYA BOWLS

While we have no reason to doubt the accuracy of any of the information supplied, we cannot, and do not, guarantee its accuracy. All information should be independently verified prior to a purchase or lease of the property. We are not responsible for errors, omissions, misuse, or misinterpretation of information contained herein and make no warranty of any kind, express or implied, with respect to the property or any other matters.

# 185 **HARRY S. TRUMAN PKWY**

---

SUITE 100 | ANNAPOLIS, MD

**Ryan J. Brant**

rbrant@rossocre.com

C | 301.768.2710



One Annapolis Street | Suite 101 | Annapolis, MD 21401 | [www.RossoCRE.com](http://www.RossoCRE.com)

While we have no reason to doubt the accuracy of any of the information supplied, we cannot, and do not, guarantee its accuracy. All information should be independently verified prior to a purchase or lease of the property. We are not responsible for errors, omissions, misuse, or misinterpretation of information contained herein and make no warranty of any kind, express or implied, with respect to the property or any other matters.