



## **Kietzke Plaza Office Complex**

4600 Kietzke Ln, Reno, NV 89502

**Fred Desiderio**

Desiderio Properties

4600 Kietzke Ln, Suite G-170, Reno, NV 89502

[desi3@prodigy.net](mailto:desi3@prodigy.net)

(775) 825-5311



# Kietzke Plaza Office Complex

\$21.00 /SF/YR

This property features over 100,000 square feet of leasable office space within fourteen single-story buildings, set in a landscaped garden environment in Reno, Nevada. Tenant improvement allowances are available. For further details, please contact (775) 825-5311.

The location offers convenient access to Highway 395 and the Reno/Tahoe International Airport. It is situated within walking distance of one of Reno's major shopping areas and is directly across from the Reno/Sparks Convention Center. Utilities and weekday janitorial services are included. Tenants may reserve the on-site conference room with advance notice, and Business Class High Speed Internet service is also available....

- Close to Reno/Tahoe International Airport, restaurants, shopping. Easy access to US395. Across the street from the Reno/Sparks Convention Center.



Rental Rate:	\$21.00 /SF/YR
Property Type:	Office
Building Class:	C
Rentable Building Area:	112,116 SF
Year Built:	1974
Walk Score ®:	50 (Fairly friendly)
Transit Score ®:	30 (Somewhat friendly)
Rental Rate Mo:	\$1.75 /SF/MO

## 1st Floor Ste A100

Space Available	777 SF
Rental Rate	\$21.00 /SF/YR
Date Available	April 28, 2026
Service Type	Full Service
Built Out As	Standard Office
Space Type	Relet
Space Use	Office
Lease Term	3 - 5 Years

Could handle two users or two businesses with common entryway. (3) Large offices with large reception area.

1

## 1st Floor Ste C121

Space Available	830 SF
Rental Rate	\$21.00 /SF/YR
Date Available	May 01, 2026
Service Type	Full Service
Built Out As	Standard Office
Space Type	Relet
Space Use	Office
Lease Term	3 - 5 Years

(3) Private offices with receptions area. Break area includes sink.

2

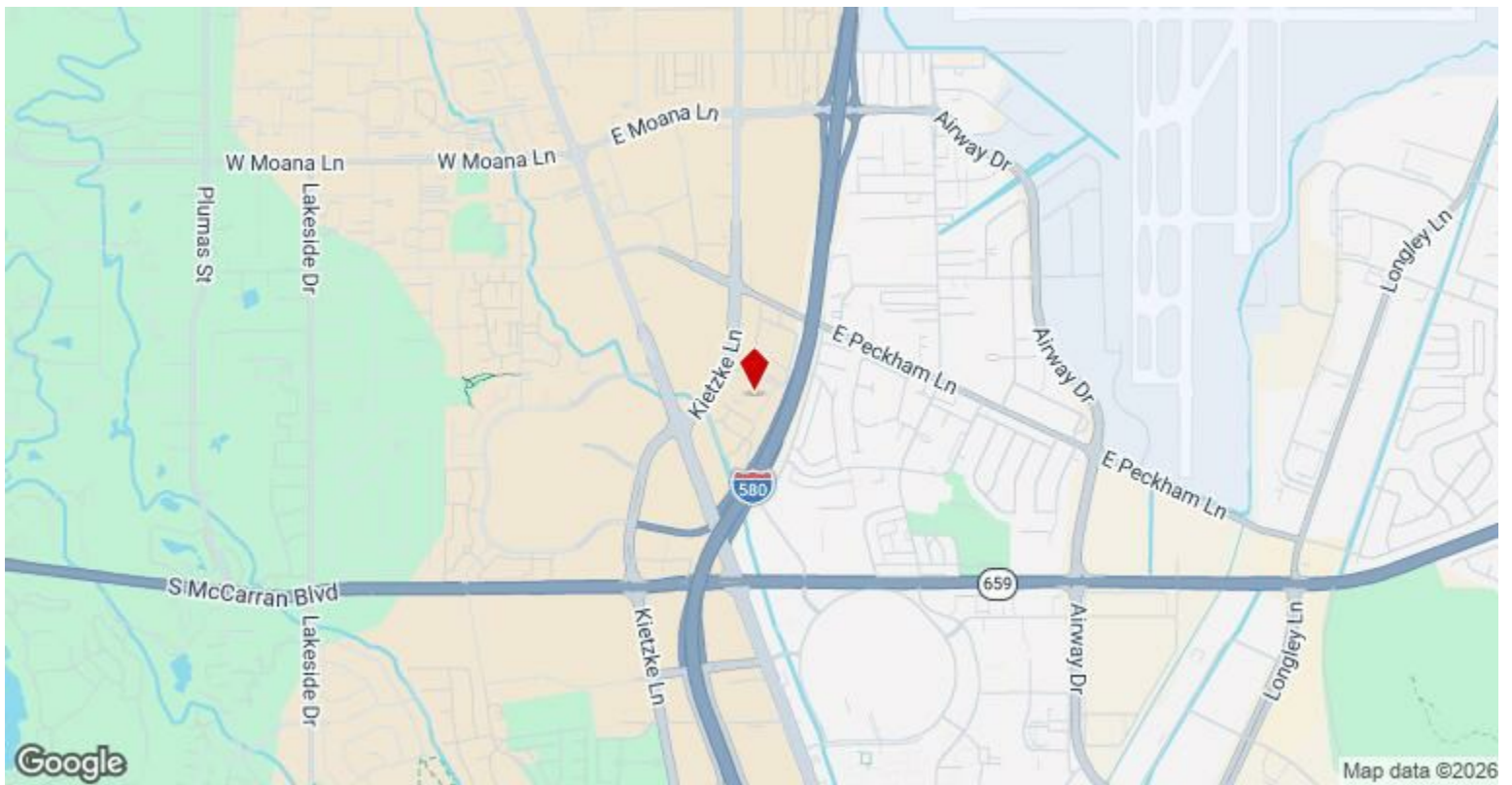

## 4600 Kietzke Ln, Reno, NV 89502

This property features over 100,000 square feet of leasable office space within fourteen single-story buildings, set in a landscaped garden environment in Reno, Nevada. Tenant improvement allowances are available. For further details, please contact (775) 825-5311.

The location offers convenient access to Highway 395 and the Reno/Tahoe International Airport. It is situated within walking distance of one of Reno's major shopping areas and is directly across from the Reno/Sparks Convention Center. Utilities and weekday janitorial services are included. Tenants may reserve the on-site conference room with advance notice, and Business Class High Speed Internet service is also available.

# Property Photos

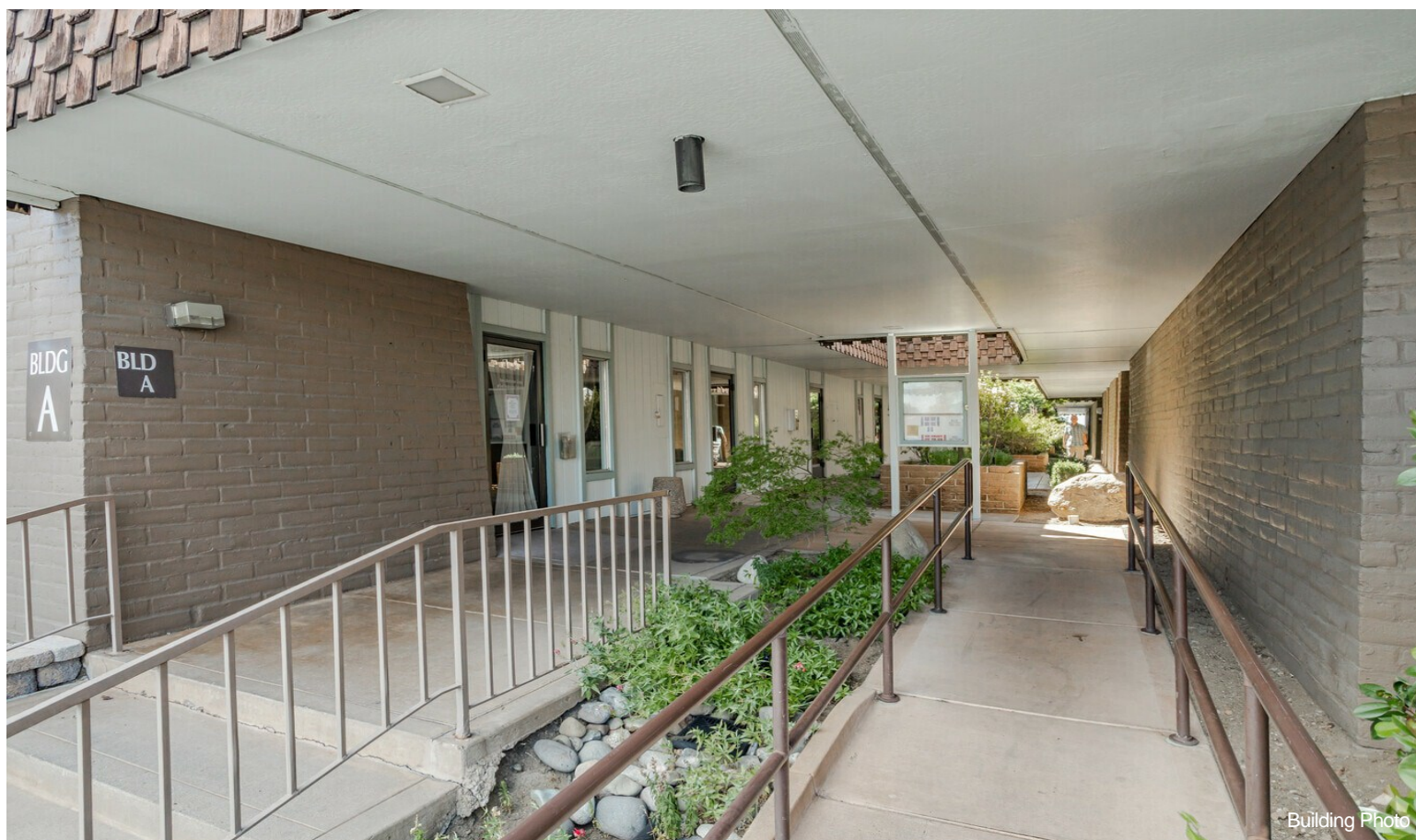

# Property Photos



Building Photo



Building Photo

# Property Photos



KIETZKE LANE

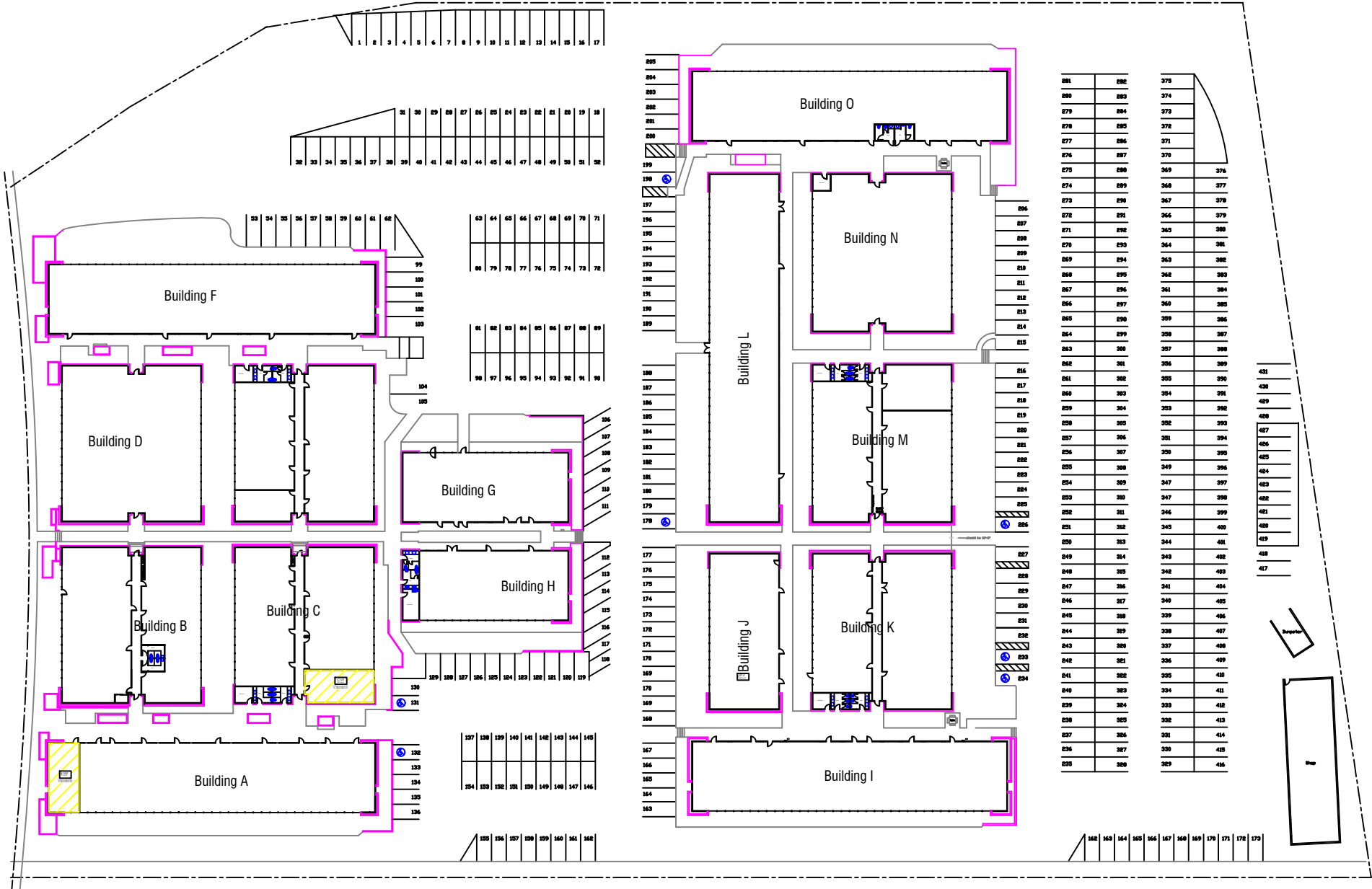

**SITE DATA**  
 Project Name: Kietzke Plaza  
 Project Location: Reno, Nevada 89502  
 A/E/C: JWB & Associates  
 Date: 08/15/18  
 JWB & Associates, Professional Office  
 10750 S. 280th Ave.  
 Building 301, 112.1.18

 - AVAILABLE

# KIETZKE PLAZA OFFICE COMPLEX - RENO, NEVADA

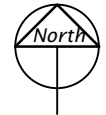

CONTACT INFO:  
Kietzke Plaza Office Complex LLC  
4600 Kietzke Lane G-170  
Reno, Nevada 89502  
(775) 825-5311  
(775) 825-5396 fax  
desprop@desprop.net

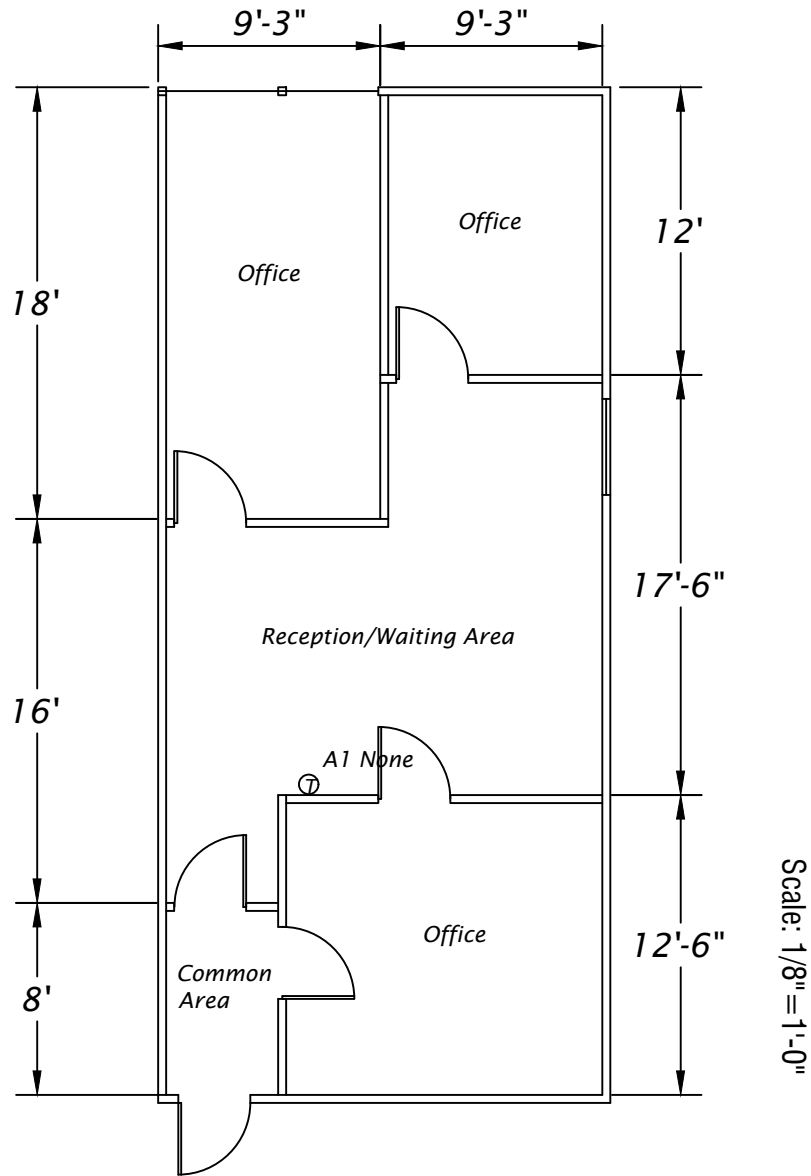

Kietzke Plaza Office Complex  
4600 Kietzke Lane  
Building A Suite 100  
777 SF

CONTACT INFO:  
Kietzke Plaza Office Complex LLC  
4600 Kietzke Lane G-170  
Reno, Nevada 89502  
(775) 825-5311  
(775) 825-5396 fax  
desprop@desprop.net

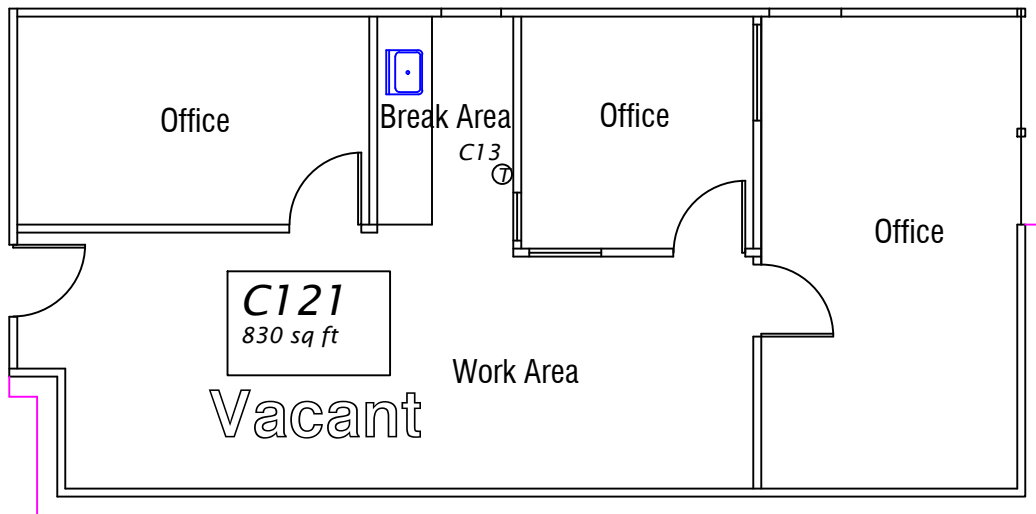

Scale: 1/8" = 1'-0"

Kietzke Plaza Office Complex  
4600 Kietzke Lane  
Building C Suite 121  
830 SF