



**GC**  
REALTY & DEVELOPMENT, LLC

**INDUSTRIAL  
OUTSIDE  
STORAGE FOR  
SALE**

**12,120 sf \$2,600,000**

# 640 Varsity Drive

Elgin, IL 60120



## SPECIFICATIONS

- Building Size: 12,120 SF
- Land Area: ±2.35 Acres
- Office: ±2,400 SF
- Year Built: 1972
- Construction: Masonry
- Clear Height: 14.5'
- Sprinklers: N/A
- Parking: 50+ Trucks
- Zoning: C1
- 18 DIDs @ 12'x14' & 12'x12'

## HIGHLIGHTS

- Massive Truck Repair Shop
- Approved for Outdoor Storage · Fully Fenced & Secured Lot
- Triple Basin Floor Drains · 18 DIDs @ 12'x14' & 12'x12'
- Easy access to Rt 20, I-90, I-390 and other major expressways

Brad Bullington  
630.674.6989  
[brad@gcrealtyinc.com](mailto:brad@gcrealtyinc.com)

GC Realty & Development, LLC  
219 E Irving Park Rd,  
Roselle, IL 60172  
630.854.6317

Bryan Sonn  
847.207.2108  
[bryan@gcrealtyinc.com](mailto:bryan@gcrealtyinc.com)



**INDUSTRIAL  
OUTSIDE  
STORAGE FOR  
SALE**

**12,120 sf \$2,600,000**

# 640 Varsity Drive

Elgin, IL 60120

## LOCATION



Brad Bullington  
630.674.6989  
[brad@gcrealtyinc.com](mailto:brad@gcrealtyinc.com)

GC Realty & Development, LLC  
219 E Irving Park Rd,  
Roselle, IL 60172  
630.854.6317

Bryan Sonn  
847.207.2108  
[bryan@gcrealtyinc.com](mailto:bryan@gcrealtyinc.com)

The information provided herein was obtained from sources believed reliable; however, GC Realty & Development LLC makes no guarantees, warranties, or representations as to the completeness or accuracy thereof. The presentation of this information is submitted subject to errors, omissions, change of price or conditions, prior sale or lease, or withdrawal without notice.



**INDUSTRIAL  
OUTSIDE  
STORAGE FOR  
SALE**

**12,120 sf \$2,600,000**

# 640 Varsity Drive

Elgin, IL 60120

## PROPERTY PHOTOS



Brad Bullington  
630.674.6989  
[brad@gcrealtyinc.com](mailto:brad@gcrealtyinc.com)

GC Realty & Development, LLC  
219 E Irving Park Rd,  
Roselle, IL 60172  
630.854.6317

Bryan Sonn  
847.207.2108  
[bryan@gcrealtyinc.com](mailto:bryan@gcrealtyinc.com)

The information provided herein was obtained from sources believed reliable; however, GC Realty & Development LLC makes no guarantees, warranties, or representations as to the completeness or accuracy thereof. The presentation of this information is submitted subject to errors, omissions, change of price or conditions, prior sale or lease, or withdrawal without notice.



**INDUSTRIAL  
OUTSIDE  
STORAGE FOR  
SALE**

**12,120 sf \$2,600,000**

# 640 Varsity Drive

Elgin, IL 60120

## FLOOR PLAN

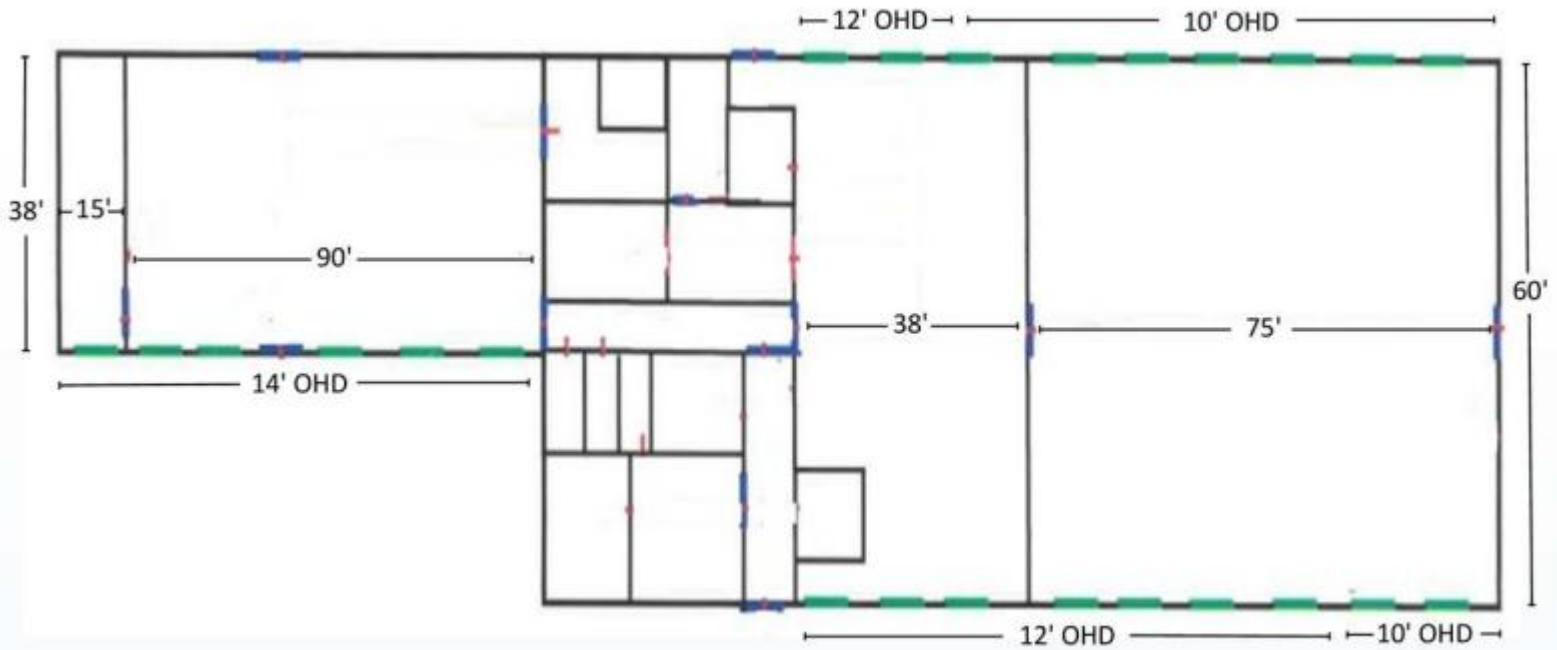

\*Measurements taken from interior walls & do not represent the RBA.

**WAREHOUSE: 10,000 sq. ft.**

**OFFICE: 2,120 sq. ft.**

Brad Bullington  
630.674.6989  
[brad@gcrealtyinc.com](mailto:brad@gcrealtyinc.com)

GC Realty & Development, LLC  
219 E Irving Park Rd,  
Roselle, IL 60172  
630.854.6317

Bryan Sonn  
847.207.2108  
[bryan@gcrealtyinc.com](mailto:bryan@gcrealtyinc.com)