

# CRYSTAL BUSINESS COMMONS

MINNEAPOLIS-ST. PAUL  
NORTHWEST

5500 Lakeland Avenue N  
Crystal, MN 55429



FOR LEASE

SUITE 150 & 500

5,464 - 11,249 SF



LEASED BY

Colliers

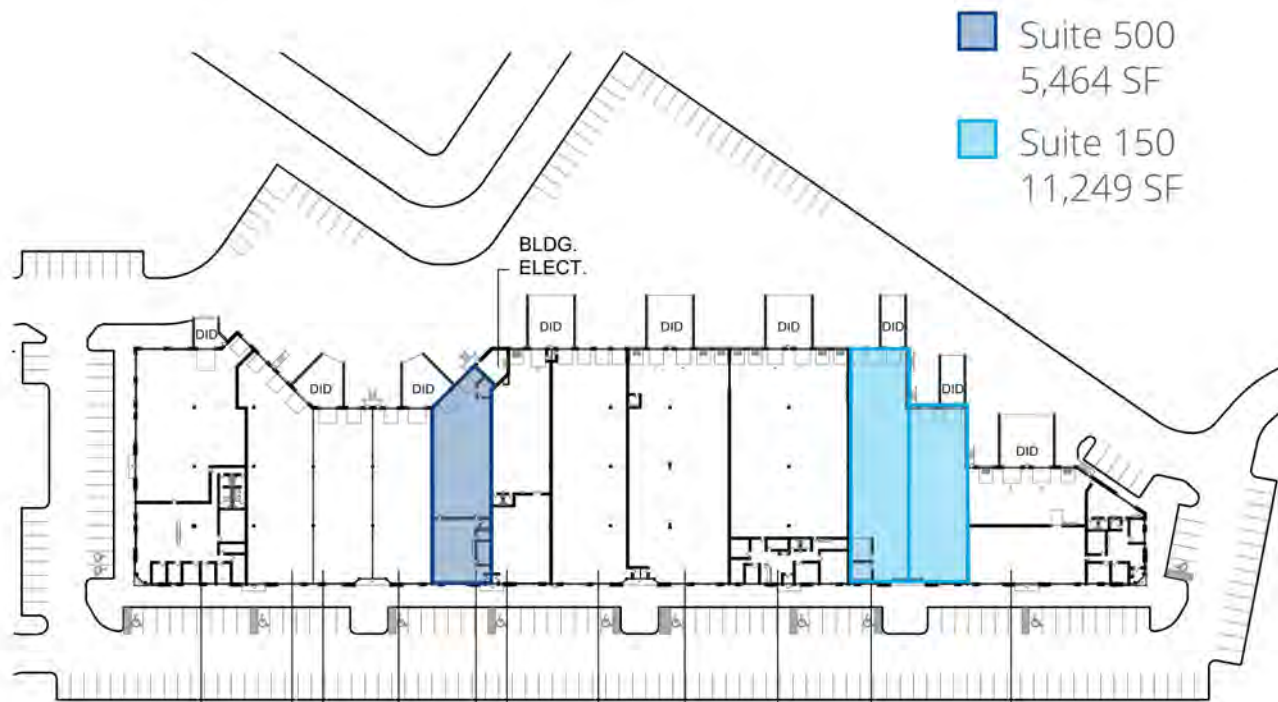

- Suite 500  
5,464 SF
- Suite 150  
11,249 SF



## PROPERTY HIGHLIGHTS

Year Built	1999
Clear Height	24'
Parking	245 surface spaces (2.65/1000)
Power	277/480-volt/200-amp service
Column Spacing	39' x 39'
Lease Rates	Negotiable
CAM/Tax (2026)	\$5.06 PSF

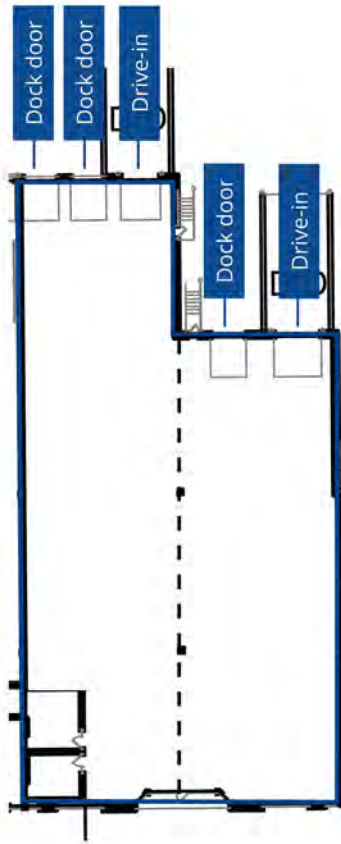

Suite 150  
11,249 SF

BTS Office

□ 11,249 SF Warehouse

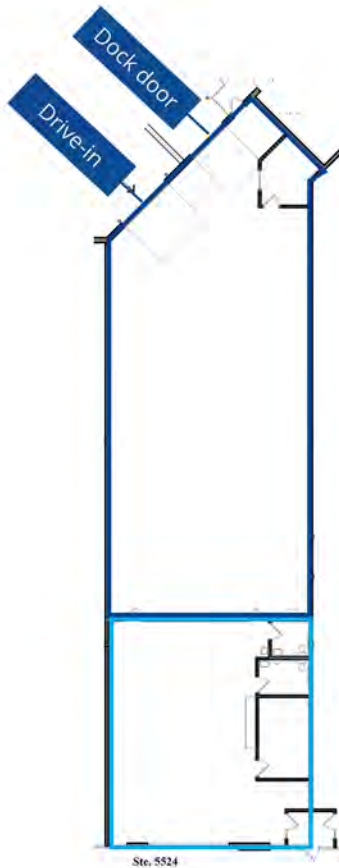

Suite 500  
5,464 SF

□ 1,812 SF Office

□ 3,652 SF Warehouse

# Committed to Driving Value for Our Customers

## Properties with a Competitive Edge

Our scale, proprietary data and local relationships allow our 1,200+ skilled team members to help customers stay ahead of market trends.



## Best-in-Class Customer Service

Our on-the-ground regional teams provide you with local expertise, leveraging data-driven insights to find the right solutions for your business.

## Link+

Our digital customer experience platform provides easy access to your property management teams, lease documents, billing and service requests. Sign up today!

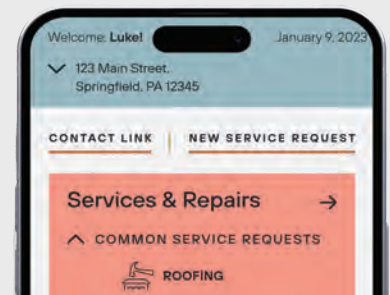

500 Million  
Square Foot  
Portfolio

## Energy Solutions

Our comprehensive energy and utility management program enables customers to achieve savings and access our in-house sustainability experts. Enroll through Link+.

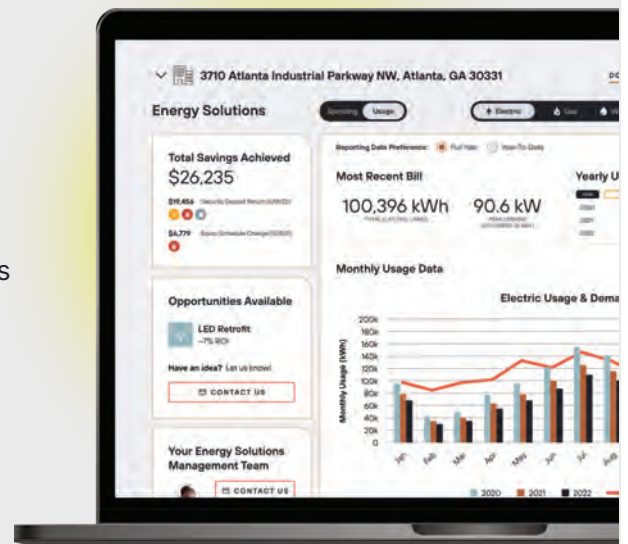

# CONTACT INFORMATION



5500 Lakeland Ave N  
Crystal, MN 55429

**Steve Nilsson CCIM, SIOR**

steve.nilsson@colliers.com

(952) 897-7899

**Matt Newell**

matthew.newell@colliers.com

(651) 356-5074

This is not an offer or acceptance of an offer to lease space. A lease will only be offered or made in a written agreement signed by landlord. No representation or warranty of any kind is made by landlord unless set forth in a written definitive lease executed by the landlord.



LEASED BY

