

# CANTON MEDICAL OFFICE BUILDING

Canton, GA

**GENERAL NOTES:**

1. THIS DRAWING SHOULD BE REGARDED AS A PRELIMINARY "DIGITAL SKETCH".
2. THIS PLAN, BEING PRELIMINARY IN NATURE, DOES NOT TAKE INTO FULL ACCOUNT THE REQUIREMENTS FOR ZONING, DRAINAGE, STORM WATER RETENTION, GRADING, UTILITY EASEMENTS, D.O.T. RESTRICTIONS, RIGHTS OF WAY, ENVIRONMENTAL PROTECTION AGENCY RESTRICTIONS, OR F.A.A. AIR RIGHTS. THE ABOVE REQUIREMENTS CAN AFFECT THE LAYOUT OF THIS SITE.
3. ALL SITE DIMENSIONS AND AREAS ARE SUBJECT TO ESTIMATION AND SHOULD BE VERIFIED.
4. VERIFY ALL DIMENSIONS WITH CIVIL ENGINEER DOCUMENTS, SURVEY AND FIELD CONDITIONS. NOTIFY CIVIL ENGINEER AND ARCHITECT IMMEDIATELY OF ANY DISCREPANCIES.

**GENERAL NOTES:**

TYPE OF BUILDING:	
1 STORY MEDICAL OFFICE:	7,800 G.S.F.
PARKING:	
SURFACE PARKING:	39 SPACES
PROVIDED HANDICAP SPACES:	2 SPACES
TOTAL @ 5/1000 G.S.F.	

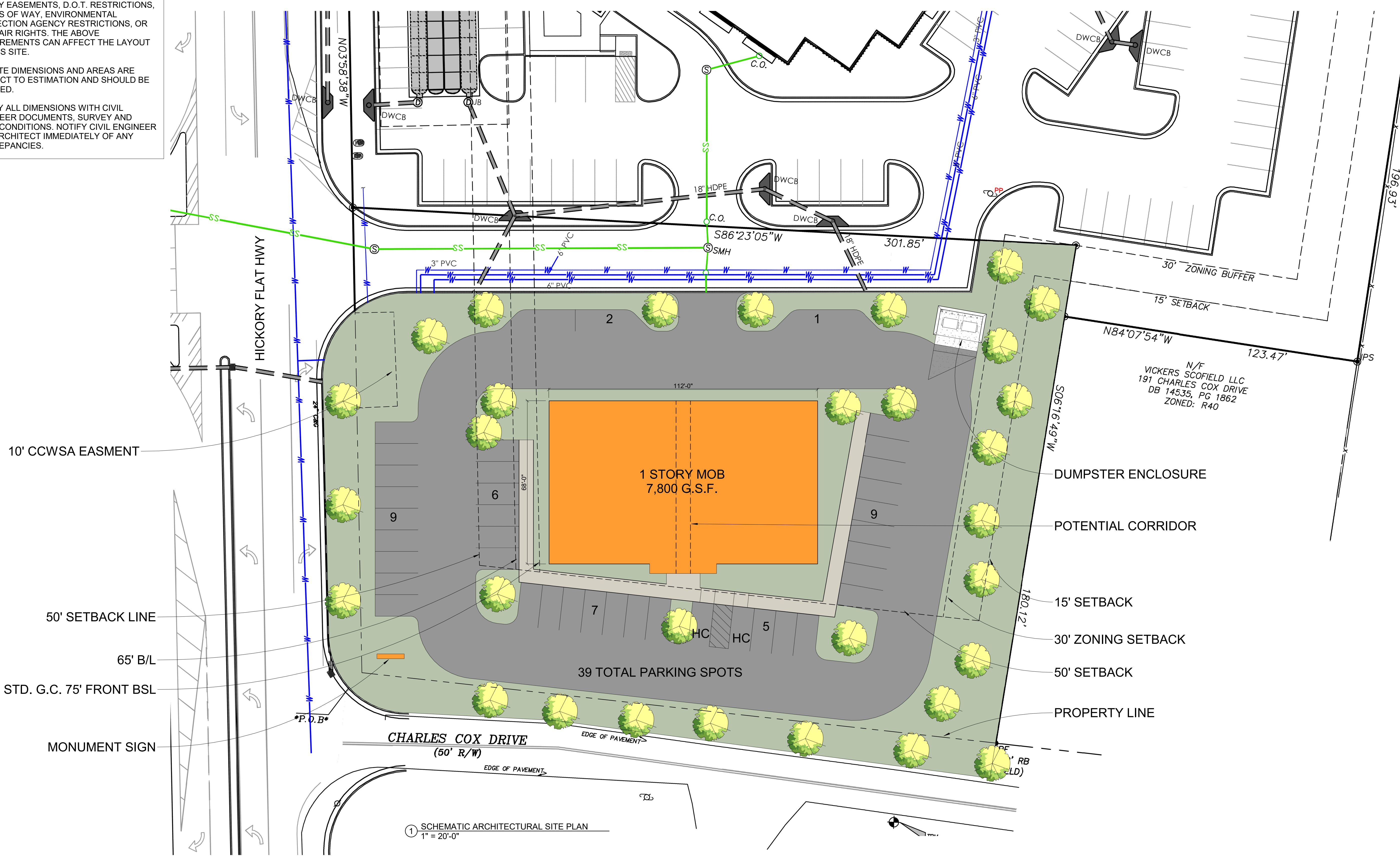

① SCHEMATIC ARCHITECTURAL SITE PLAN  
1" = 20'-0"

