

LA COSTA MEADOWS BUSINESS CENTER

1619 S. Rancho Santa Fe Road - San Marcos, CA 92078

FOR LEASE: 2,316 - 16,236 SF INDUSTRIAL SUITES WITH DOCK & GRADE



TENANT INCENTIVE:
ONE (1) MONTH OF FREE RENT
PER YEAR OF TERM *

*MINIMUM 3-YEAR LEASE TERM REQUIRED



1619 S. RANCHO SANTA FE RD.

LOW FINISH INDUSTRIAL SUITES WITH DOCK & GRADE LEVEL LOADING NOW AVAILABLE

Availability Overview

TENANT INCENTIVE:
ONE (1) MONTH OF FREE RENT PER YEAR OF TERM*
 *MINIMUM 3-YEAR LEASE TERM REQUIRED

Industrial & Flex Availability

Building	Suite	Size	Lease Rate	CAM/SF	Availability
1619 S. Rancho Santa Fe Rd	B	2,316 SF	\$1.85/SF	\$0.24/SF	8/1/2026
1619 S. Rancho Santa Fe Rd	C	3,139 SF	\$1.85/SF	\$0.24/SF	Vacant
1619 S. Rancho Santa Fe Rd	D	2,608 SF	\$1.85/SF	\$0.24/SF	Vacant
1619 S. Rancho Santa Fe Rd	E	2,790 SF	\$1.85/SF	\$0.24/SF	Vacant
1619 S. Rancho Santa Fe Rd	F	5,383 SF	\$1.85/SF	\$0.24/SF	Vacant
1619 S. Rancho Santa Fe Rd	E-F	8,173 SF	\$1.85/SF	\$0.24/SF	Vacant
1619 S. Rancho Santa Fe Rd	CDEF	13,920 SF	\$1.85/SF	\$0.24/SF	Vacant



Industrial Availability

Address:	1619 S. Rancho Santa Fe Rd, Suite B
Size:	2,316 SF
Base Rent:	\$1.85/SF
CAM:	\$0.24/SF
Clear Height:	16' - 17'
Availability:	8/1/2026
Comments:	Suite consists of a reception area, 2 private offices, and remainder warehouse with a dock loading platform and grade level ramp.

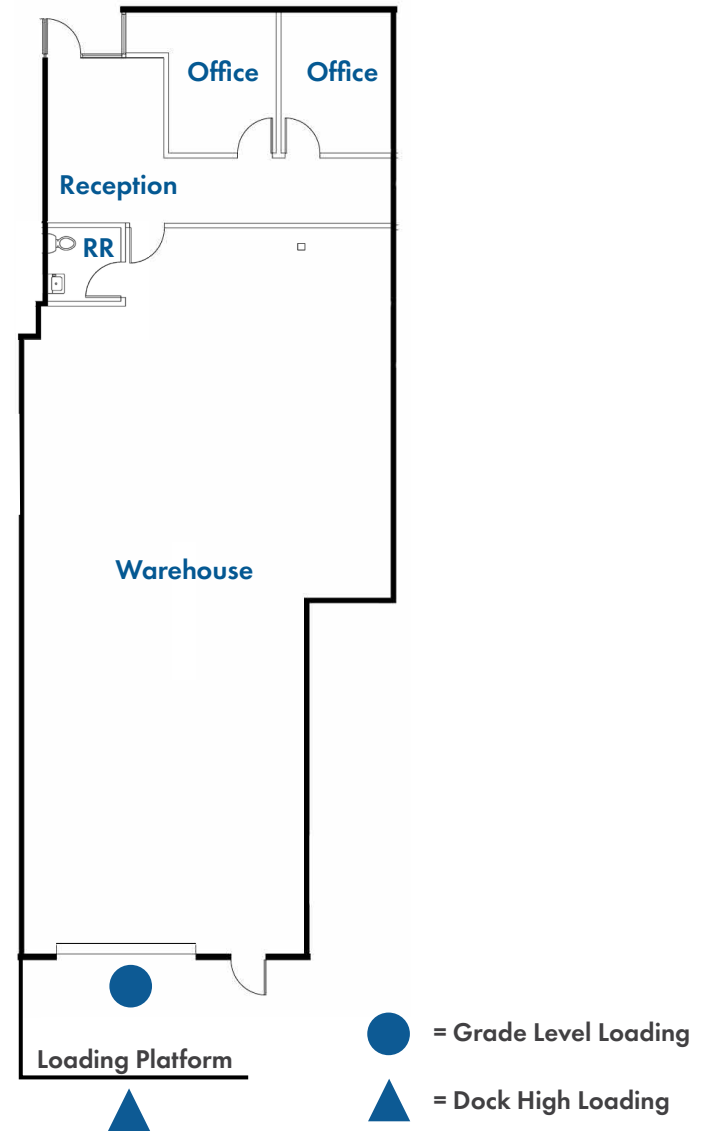
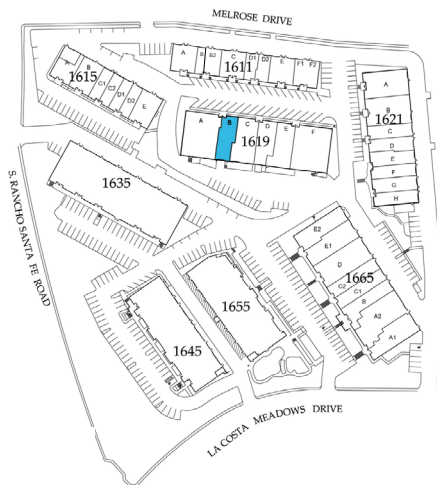

Industrial Availability

Address:	1619 S. Rancho Santa Fe Rd, Suite C
Size:	3,139 SF
Base Rent:	\$1.85/SF
CAM:	\$0.24/SF
Clear Height:	16' - 17'
Availability:	Vacant
Comments:	Suite consists of a reception area, 2 private offices, and remainder warehouse with a dock loading platform and grade level ramp.

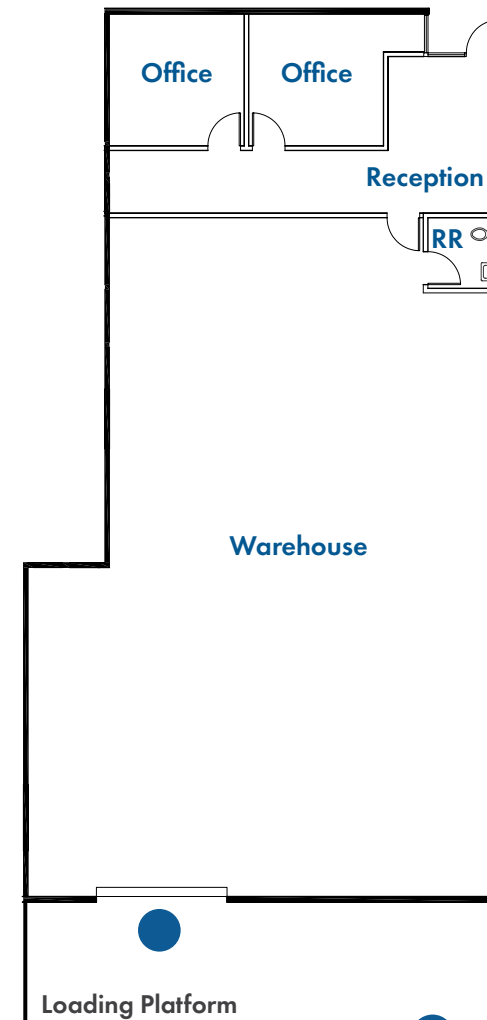

- = Grade Level Loading
- ▲ = Dock High Loading

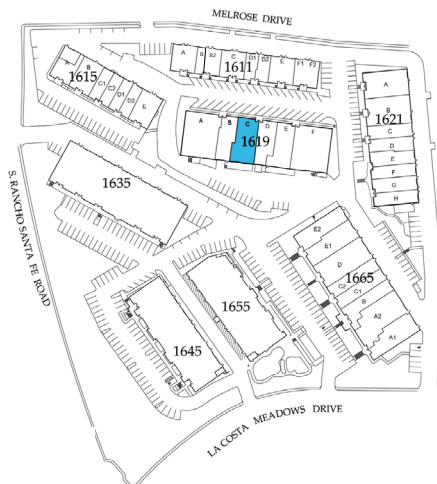

Industrial Availability

Address:	1619 S. Rancho Santa Fe Rd, Suite D
Size:	2,608 SF
Base Rent:	\$1.85/SF
CAM:	\$0.24/SF
Clear Height:	16' - 17'
Availability:	Vacant
Comments:	Suite consists of a reception area, 2 private offices, showroom, and remainder warehouse with 1 dock high door.

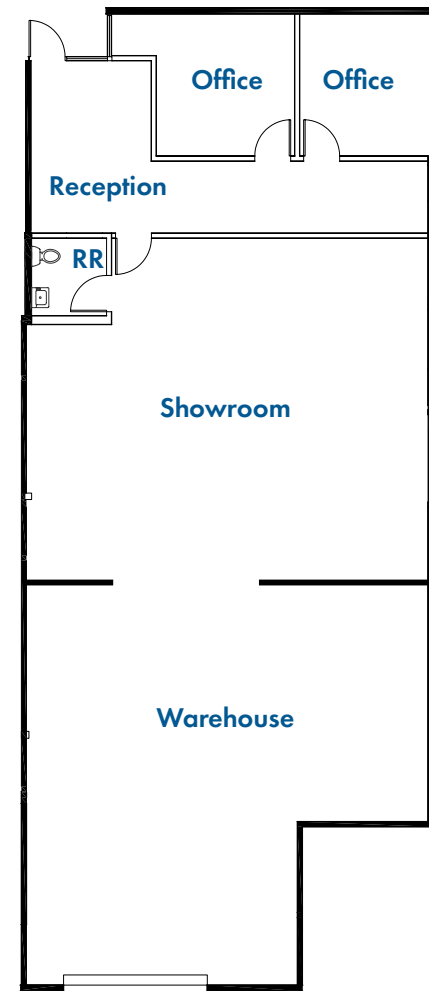

- = Grade Level Loading
- ▲ = Dock High Loading

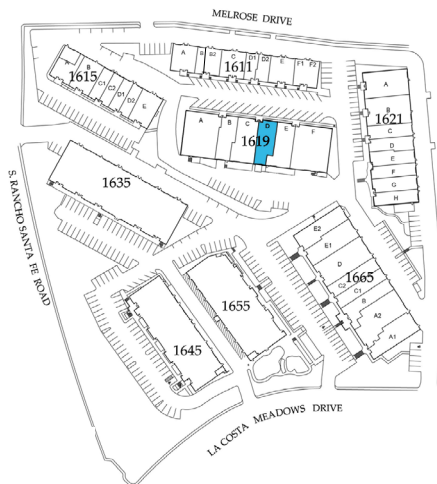

Industrial Availability

[CLICK TO VIEW VIRTUAL TOUR - SUITE E](#)

Address:	1619 S. Rancho Santa Fe Rd, Suite E
Size:	2,790 SF
Base Rent:	\$1.85/SF
CAM:	\$0.24/SF
Clear Height:	16' - 17'
Availability:	Vacant
Comments:	Suite consists of a reception area, 2 private offices, 2 restrooms and warehouse with 2 dock high positions & 1 grade level door.

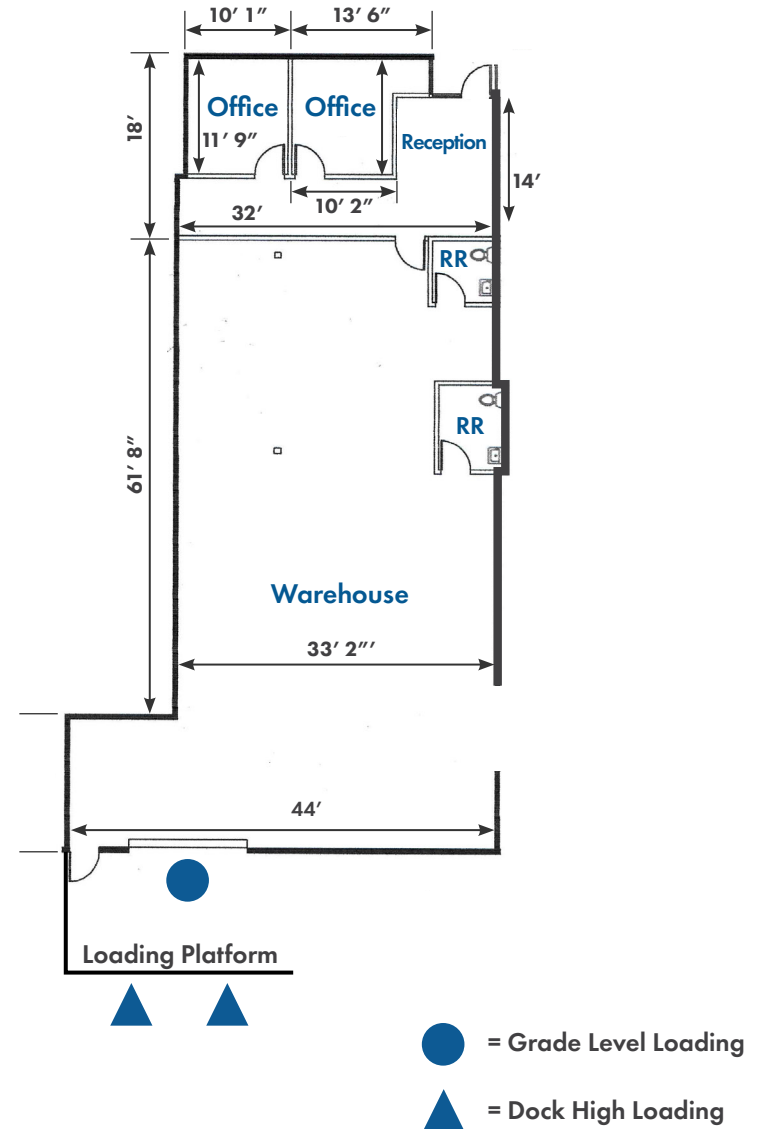

● = Grade Level Loading
 ▲ = Dock High Loading

Industrial Availability

[CLICK TO VIEW VIRTUAL TOUR - SUITE F](#)

Address:	1619 S. Rancho Santa Fe Rd, Suite F
Size:	5,383 SF
Base Rent:	\$1.85/SF
CAM:	\$0.24/SF
Clear Height:	16' - 17'
Availability:	Vacant
Comments:	Suite consists of a reception area, 2 private offices, 2 restrooms with warehouse with 2 dock high positions.

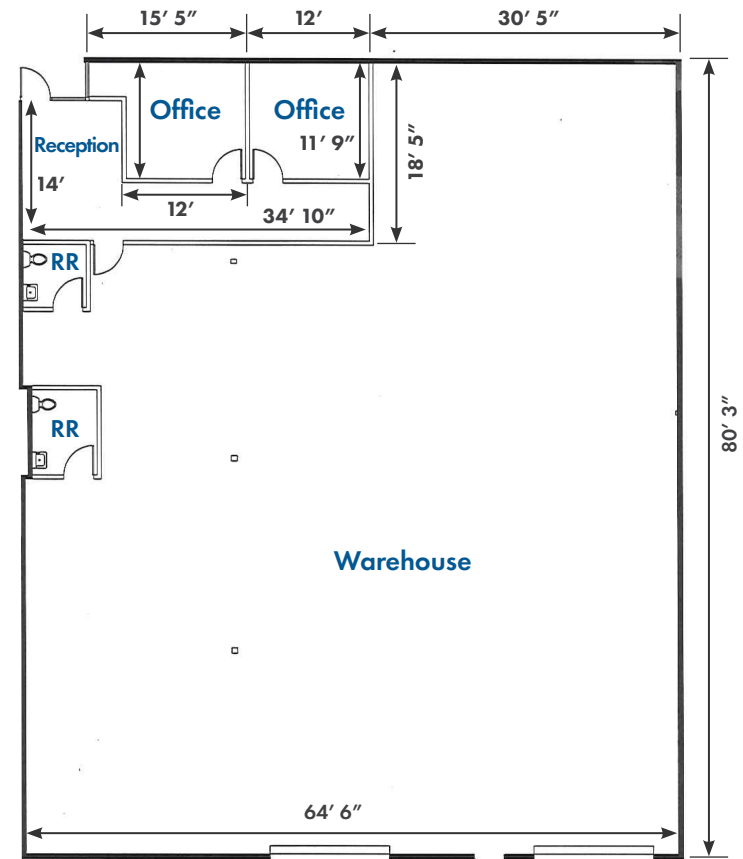

- = Grade Level Loading
- ▲ = Dock High Loading

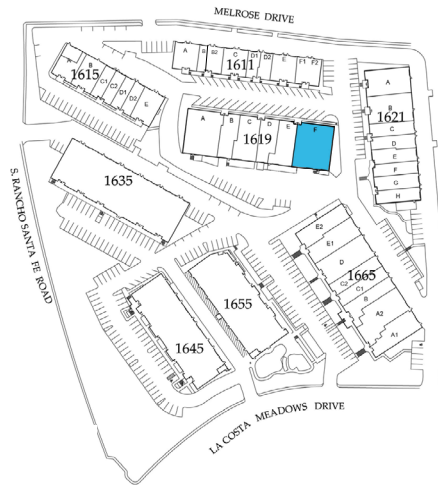

Industrial Availability

[CLICK TO VIEW VIRTUAL TOUR - SUITE E](#)

[CLICK TO VIEW VIRTUAL TOUR - SUITE F](#)

Address:	1619 S. Rancho Santa Fe Rd, Suite E-F
Size:	8,173 SF
Base Rent:	\$1.85/SF
CAM:	\$0.24/SF
Clear Height:	16' - 17'
Availability:	Vacant
Comments:	Suite consists of 15% office with reception, 4 private offices, 4 restrooms and the balance is warehouse with 4 dock high positions & 1 grade level loading door.

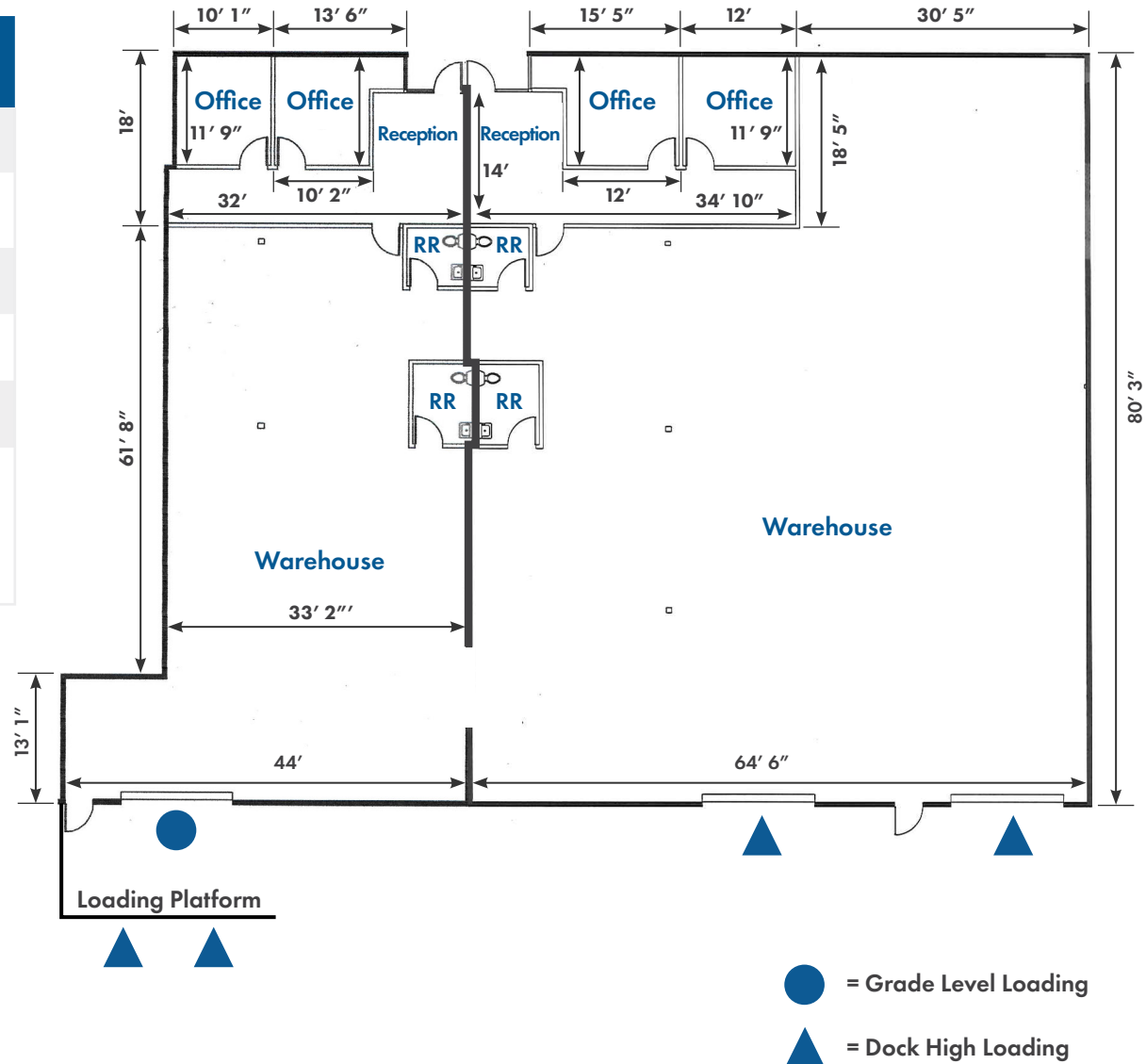

Industrial Availability

Address: 1619 S. Rancho Santa Fe Rd, Suite CDEF	
Size: 13,920 SF	Clear Height: 16' - 17'
Base Rent: \$1.85/SF	Availability: Vacant
CAM: \$0.24/SF	Comments: Space consists of receptions, four private offices, 6 restrooms, and remainder warehouse. Loading to the suite includes Five(5) Dock High Doors and Two(2) Grade Level Loading Doors.

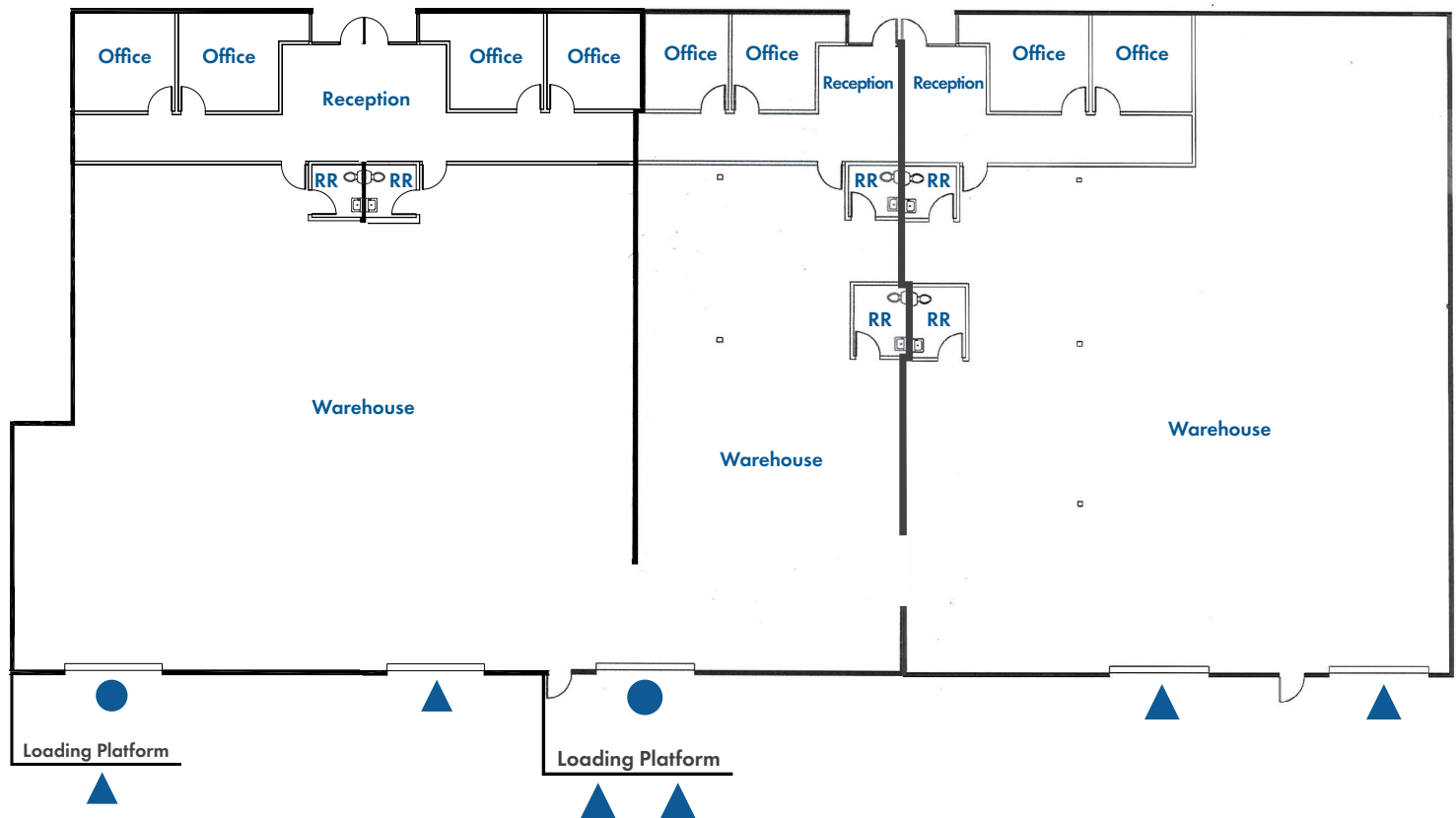
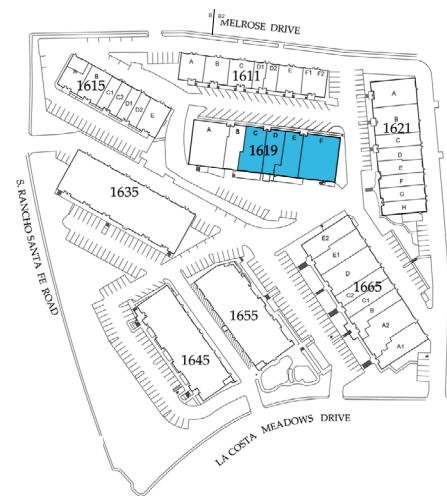

- = Grade Level Loading
- ▲ = Dock High Loading

Location Map



Demographics & Submarket Statistics - La Costa Meadows

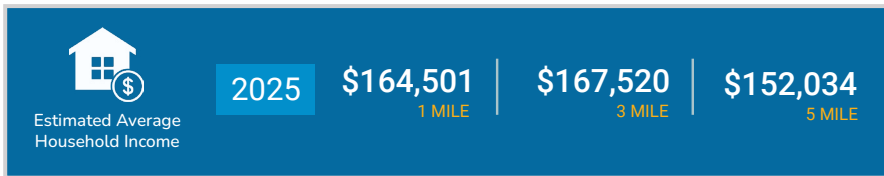
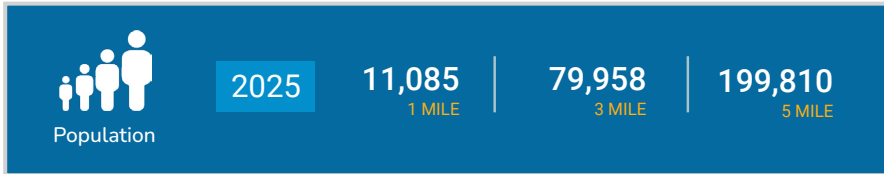

Product Type	# Buildings	Size (SF)	% of Submarket
MFG/DIST	14	468,937	34.25%
FLEX/R&D	15	490,316	35.81%
IMT	17	410,097	29.95%
Total Industrial	46	1,369,350	100.00%



LA COSTA MEADOWS BUSINESS CENTER

1619 S. Rancho Santa Fe Road - San Marcos, CA 92078

Isaac Little

ilittle@lee-associates.com

760.929.7862

CalDRE #01702879

Marko Dragovic

mdragovic@lee-associates.com

760.929.7839

CalDRE #01773106

Olivia Baffert

obaffert@lee-associates.com

760.448.1376

CalDRE # 02211874

