

FOR LEASE | 5.33± ACRE RETAIL DEVELOPMENT

566-582 MAIN STREET, LEWISTON, ME 04240



PROPERTY HIGHLIGHTS

- 5.33± acre parcel available for retail development
- Convenient location near Veteran's Memorial Bridge
- Area businesses include Dunkin, Jade Garden Chinese Restaurant, Maine Community Bank, and Margaret Murphy Center for Children to name a few.
- Traffic Count: 22,886 vehicles/day (MDOT 2020)
- Price to be determined on lease terms.

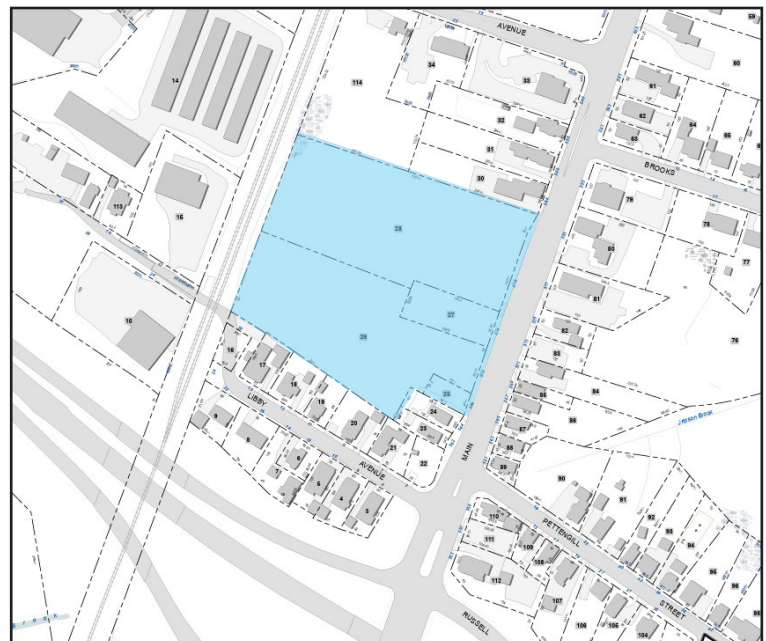

FOR LEASE | 5.33± ACRE RETAIL DEVELOPMENT

566-582 MAIN STREET, LEWISTON, ME 04240



PROPERTY HIGHLIGHTS

OWNER Gendron & Gendron, Inc.

ASSESSOR'S REF Map 192, Lots 25-28

REGISTRY OF DEEDS Book 6532, Page 184

LOT SIZE 5.33± AC

UTILITIES Municipal water & sewer

ZONING CB - Community Business

TRAFFIC COUNT 22,886 AADT

LEASE RATE To Be Determined

SITE PLAN

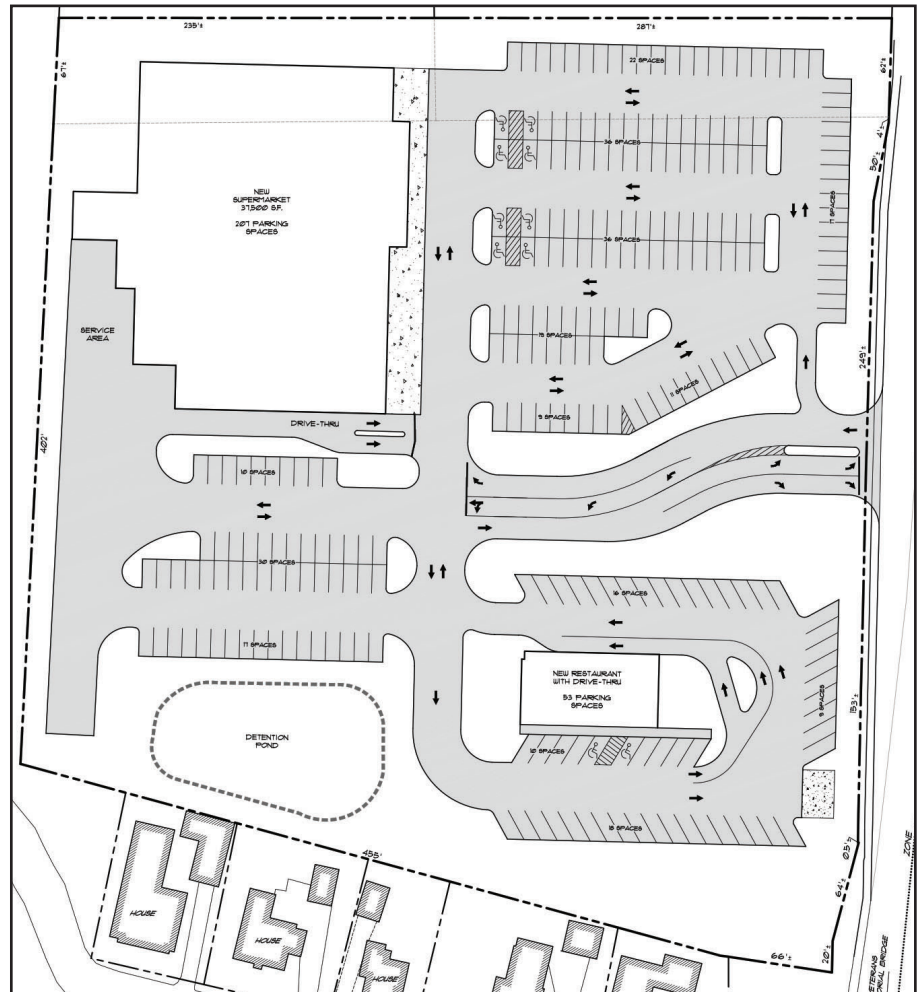

CONTACT US



CHRIS PASZYC, CCIM, SIOR
Managing Partner

+1 207.553.1709 D
+1 207.939.4147 C
cpaszyc@boulos.com



CHRIS ROMANO
Associate

+1 207.553.1717 D
+1 207.233.1792 C
cromano@boulos.com

©2025 The Boulos Company, Inc. All rights reserved. This information has been obtained from sources believed reliable, but has not been verified for accuracy or completeness. You should conduct a careful, independent investigation of the property and verify all information. Any reliance on this information is solely at your own risk. The Boulos Company and The Boulos Company logo are service marks of The Boulos Company, Inc. All other marks displayed on this document are the property of their respective owners. Photos herein are the property of their respective owners. Use of these images without the express written consent of the owner is prohibited.