



CALUMET

BUSINESS CENTER

BUILDING 4 | 171,257 SF AVAILABLE | 9540 S DORCHESTER AVENUE, CHICAGO, IL

BUILDING 5 | 59,520 SF AVAILABLE | 1501 E 96TH STREET, CHICAGO, IL

BUILDING 8 | 211,928 SF AVAILABLE | 1400-1570 E 98TH STREET, CHICAGO, IL

BUILDING 10 | 78,830 SF AVAILABLE | 1545 E 98TH STREET & 1515 E 98TH STREET, CHICAGO, IL

CALUMET BUSINESS PARK FEATURES

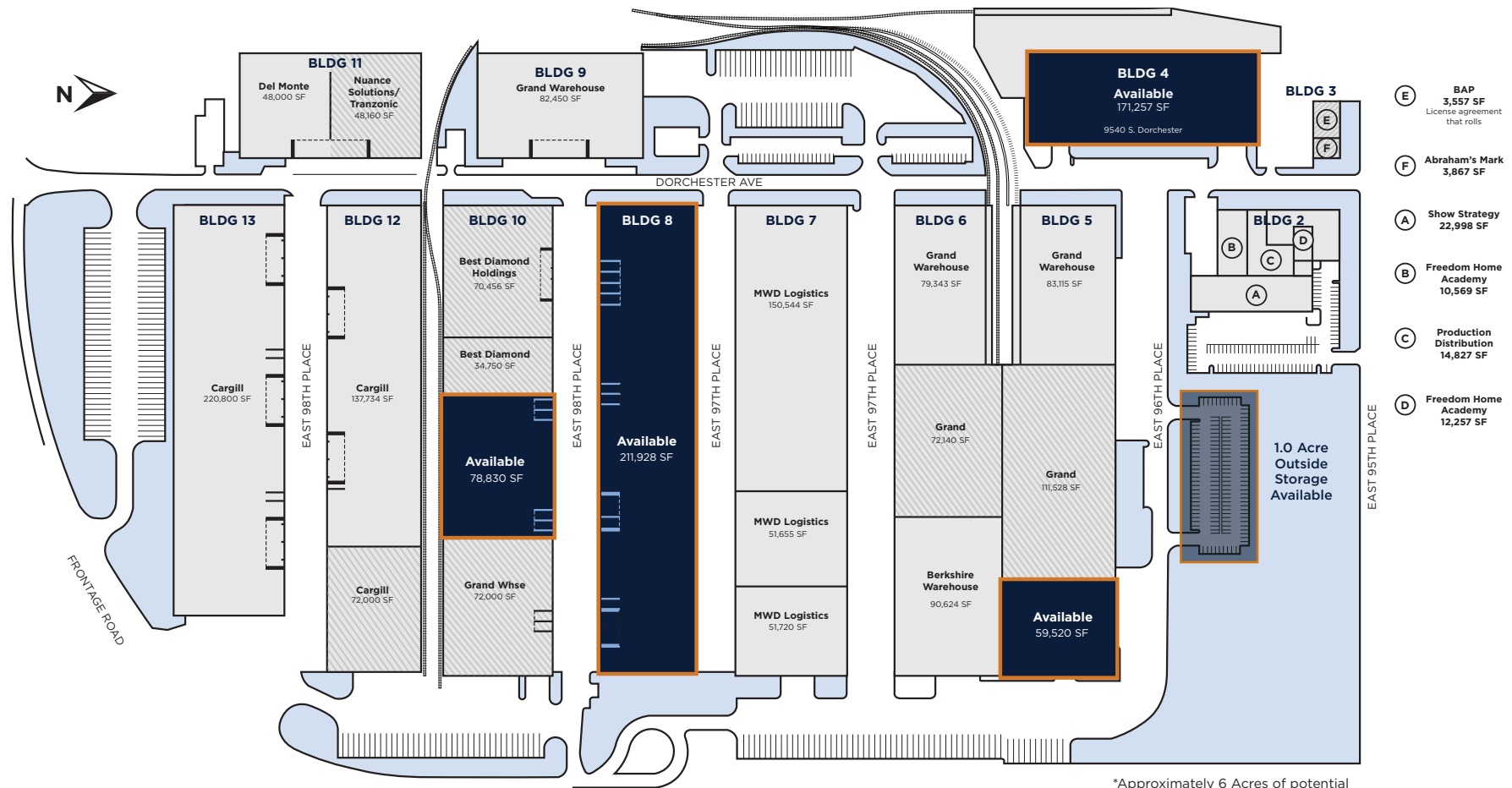

*Approximately 6 Acres of potential
Would be interested in finding a long
term parking tenant.

RAIL-SERVED UNITS AVAILABLE
PRIVATE ROADS
24-HOUR SECURITY
ADJACENT TO I-94 AND I-57
ENTERPRISE ZONE 3 INCENTIVES

Park Size: 2,067,000 SF
Site Size: 112 Acres
No. of Buildings: 12
Clear Height: 18'9" - 28'
Column Spacing: 40' x 40' Typical

Fire Suppression: Fully Sprinklered
Docks / SF: Average 1 / 7,000 SF
Trailer Parking: 249
Car Parking: 572

BUILDING 4 HIGHLIGHTS



9540 S Dorchester Avenue, Chicago, IL

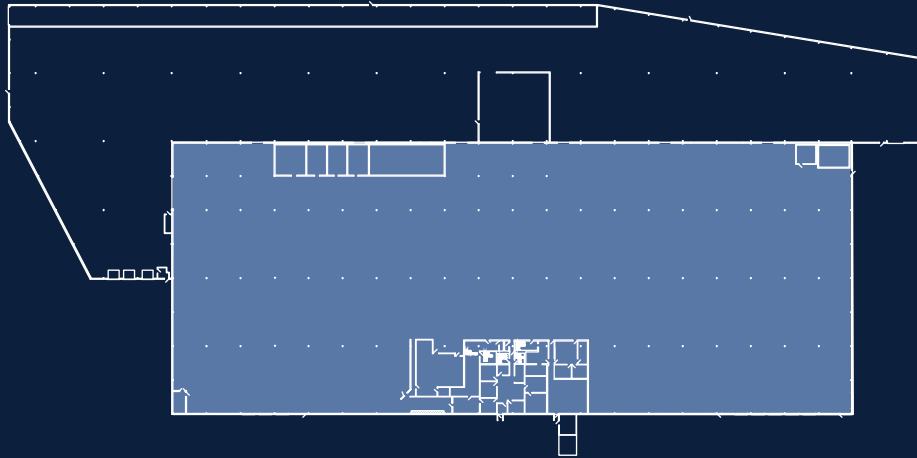

Space Available

171,257 SF

Clear Height

18'6"-28'

Exterior Docks

11

Drive-in Doors

2

Car Parking:

82

Trailer Parking:

PRO RATA

Bay Size

APPROX. 40'W X 40'D

Power

4,200 AMPS

Rail Access

INTERIOR RAIL

6 Rail Cars

Rail Provider

**NORFOLK
SOUTHERN**

BUILDING 5 HIGHLIGHTS

1501 E 96th Street, Chicago, IL

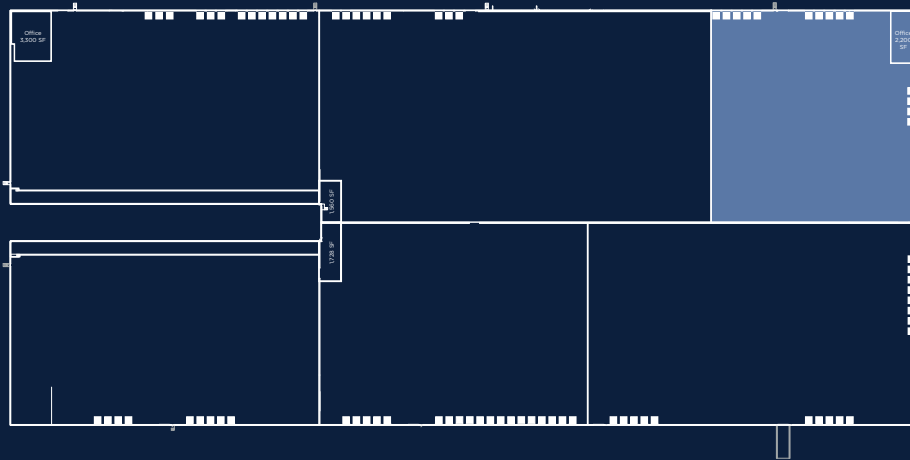

Space Available

59,520 SF

Clear Height

18'6"

Exterior Docks

14

9 with Shelters and
45K Levelers

Drive-in Doors

1

13'x 14'

Car Parking:

14

Bay Size

APPROX. 40'W X 40'D

Power

400 AMPS, 480/277 VOLTS/3 PHASE

BUILDING 8 HIGHLIGHTS



1400-1570 E 98th Street, Chicago, IL

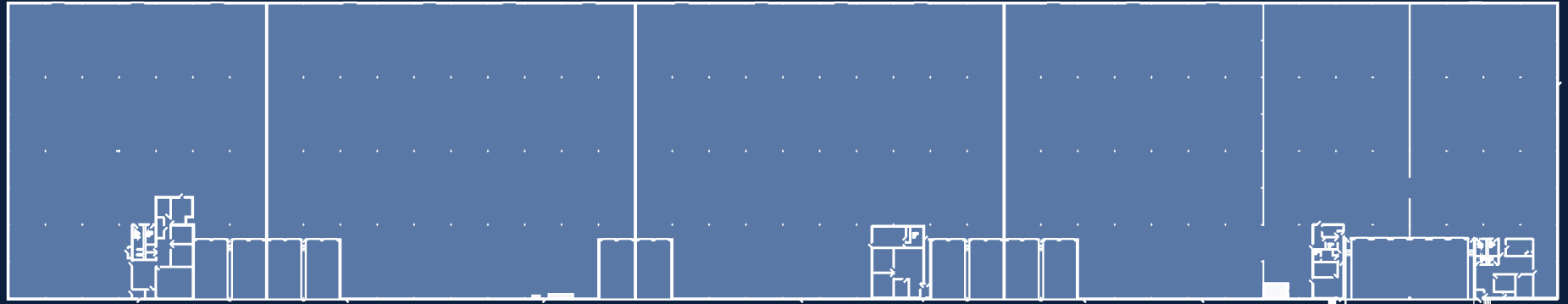

Space Available

211,928 SF

Divisible

Office Size

±6,000 SF

4 Separate Offices

Clear Height

18'9"

Exterior Docks

26

Car Parking:

59

Trailer Parking:

PRO RATA

Bay Size

APPROX. 24'W X 48'D

Power

6-400 AMPS, 277/480 VOLTS

BUILDING 10 HIGHLIGHTS

1545 E 98th Street & 1515 E 98th Street, Chicago, IL

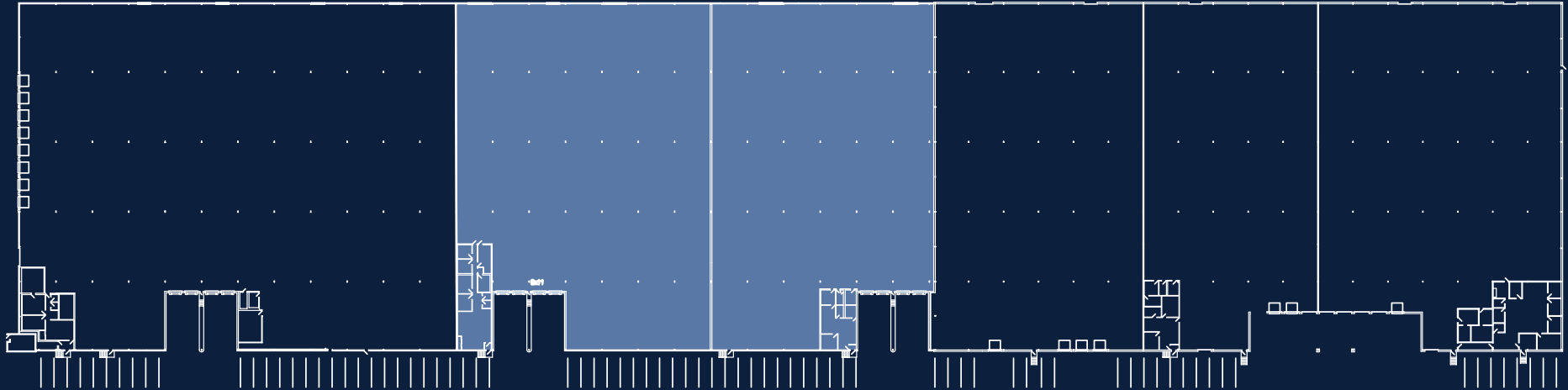

Space Available

78,830 SF

Divisible

Office Size

3,250 SF

Column Height

22'

Exterior Docks

8'

Car Parking:

24

Trailer Parking:

AMPLE

Column Spacing

24' X 48'

Power

200 AMPS, 480/27 VOLTS, 3 PHASE

LOCATION OVERVIEW

IMMEDIATE ACCESS
I-94 + I-57

CTA REDLINE
1.8 MILES

DOWNTOWN CHICAGO
13 MILES

MIDWAY AIRPORT
13 MILES

O'HARE AIRPORT
31 MILES



DRIVE TIMES

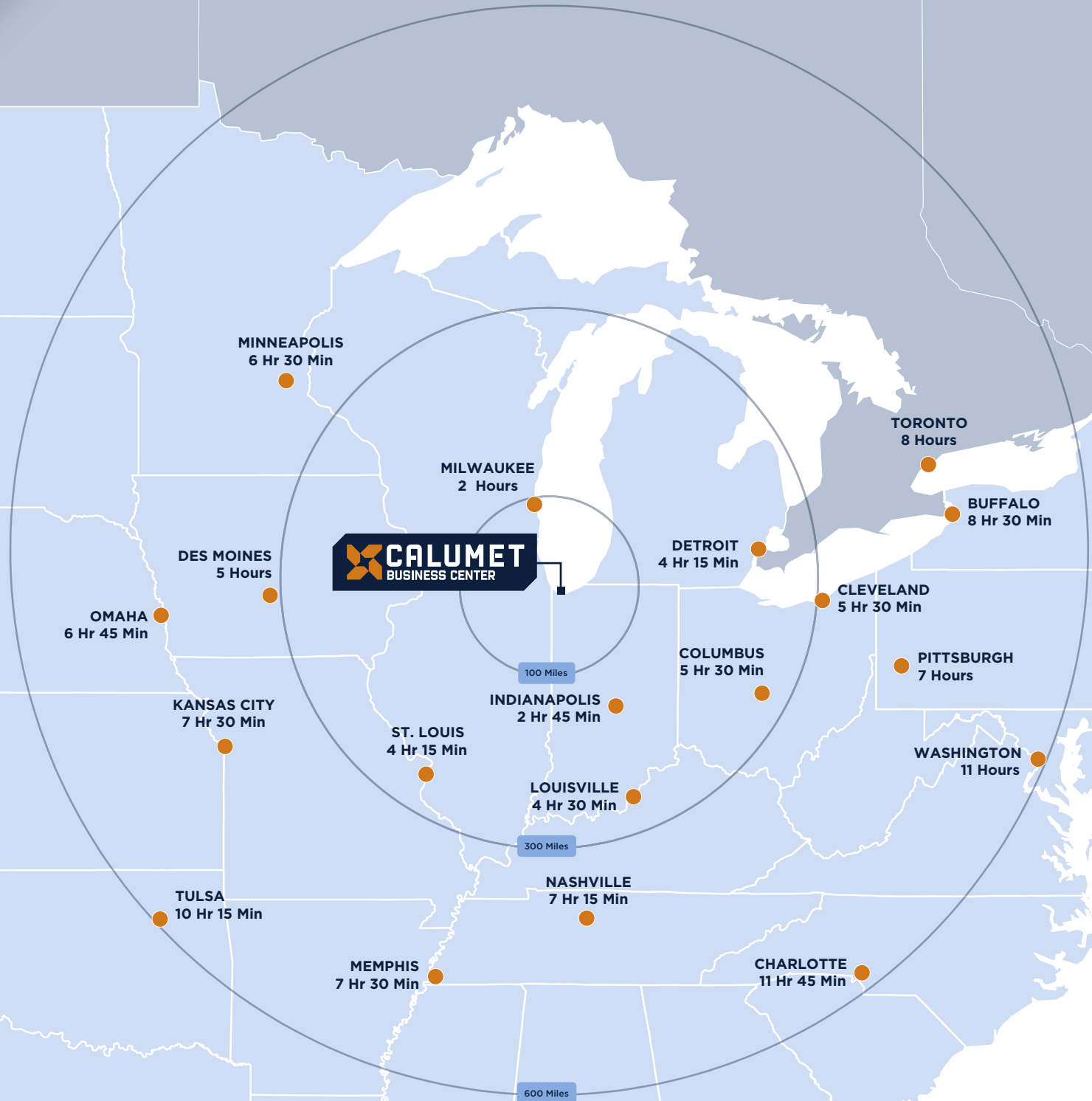

CALUMET BUSINESS CENTER



For More Information, Please Contact:

SALLY MACOICZ

+1 312 470 1823

sally.macoicz@cushwake.com

MATT SADDLER

+1 312 470 3834

matt.saddler@cushwake.com

IVAN RAVELO

+1 312 424 8148

ivan.ravelo@cushwake.com

MICHAEL FLYNN

+1 908 868 2022

michael.flynn@cushwake.com



©2025 Cushman & Wakefield. All rights reserved. The information contained in this communication is strictly confidential. This information has been obtained from sources believed to be reliable but has not been verified. No warranty or representation, express or implied, is made as to the condition of the property (or properties) referenced herein or as to the accuracy or completeness of the information contained herein, and same is submitted subject to errors, omissions, change of price, rental or other conditions, withdrawal without notice, and to any special listing conditions imposed by the property owner(s). Any projections, opinions or estimates are subject to uncertainty and do not signify current or future property performance.