



GROOVER STEWART BUILDING

25 N MARKET ST
JACKSONVILLE, FL



EXPANSIVE[®]

workspace

TEAM SUITE 300D

ACCOMODATES HEADCOUNT OF UP TO 16

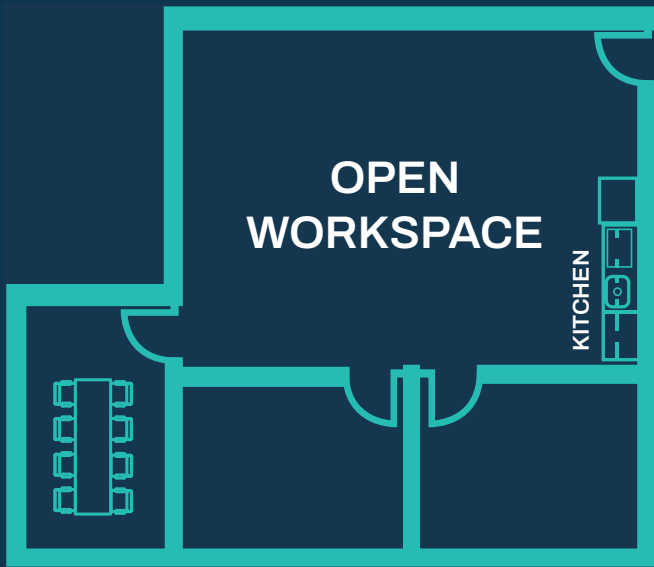

1140 SQUARE FEET OF PRIVATE SPACE PLUS 3000+SF OF SHARED WORKSPACE, COWORKING LOUNGE, KITCHEN, PHONE BOOTHS & MORE

SOLUTION INCLUDES:



FULLY FURNISHED



DIRECT FIBER INTERNET & WIFI ACCESS



EXPANSIVE LOUNGE



COFFEE & TEA



24/7 ACCESS



ON-SITE MGMT



HI-SPEED PRINTERS



UTILITIES



MOTHER'S ROOM



COMMUNITY APP



BIKE ROOM



NETWORK ACCESS



EXPLORE OUR AVAILABLE TEAM SUITE OPTIONS TODAY!

CONTACT EXPANSIVE

877.301.6217 | sales@expansive.com