

201 MEDICAL CENTER DRIVE  
CARLETON, MICHIGAN

RETAIL FOR SALE OR LEASE  
12,000 Square Feet Available



**SIGNATURE  
ASSOCIATES**  
KNOW SIGNATURE | KNOW RESULTS



## PROPERTY FEATURES

- 12,000 square feet available
- Former Sav-Mor drug store
- Situated on 3.5 acres
- Built in 2001
- Ideal for many retail, medical or office uses
- Contact Broker for sale and lease rate



For more information, please contact:

**JUSTIN GAFFREY**  
(248) 799 3143  
jgaffrey@signatureassociates.com

**SIGNATURE ASSOCIATES**  
One Towne Square, Suite 1200  
Southfield, MI 48076  
www.signatureassociates.com

# 201 Medical Center Drive – Carleton, Michigan

Retail For Sale or Lease

12,000  
Square Feet  
AVAILABLE

## Site Plan

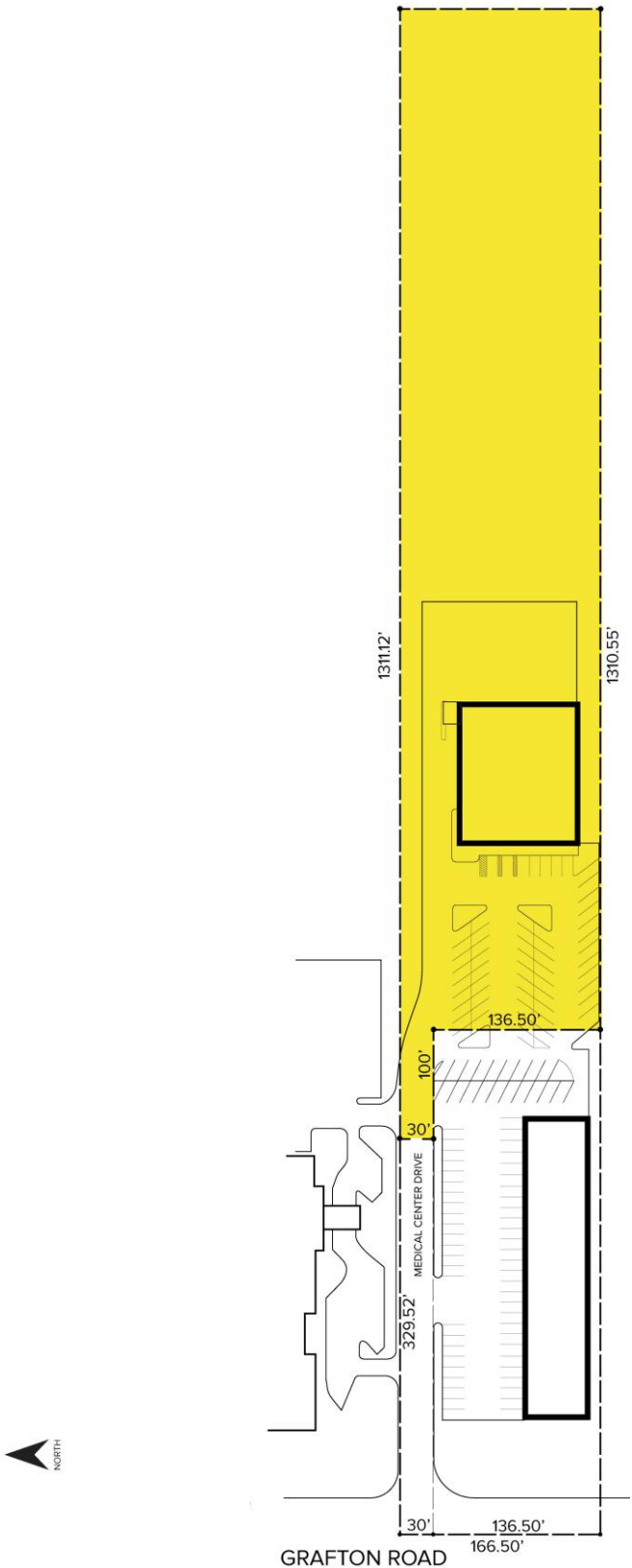

For more information, please contact:

**JUSTIN GAFFREY**  
(248) 799 3143  
jgaffrey@signatureassociates.com

**SIGNATURE ASSOCIATES**  
One Towne Square, Suite 1200  
Southfield, MI 48076  
www.signatureassociates.com

# 201 Medical Center Drive – Carleton, Michigan

Retail For Sale or Lease

12,000  
Square Feet  
AVAILABLE



## DEMOGRAPHICS

	POPULATION	MED. HH INCOME
1 MILE	2,388	\$64,624
3 MILE	6,641	\$84,149
5 MILE	23,647	\$82,268

## TRAFFIC COUNTS (TWO-WAY)

4,621	Grafton Rd. S of Medical Center Dr.
6,151	Grafton Rd. N of Medical Center Dr.
4,381	Carleton Rockwood Rd. NE Grafton Rd.
1,222	Medical Center Dr. E of Grafton Rd.



For more information, please contact:

**JUSTIN GAFFREY**

(248) 799 3143

[jgaffrey@signatureassociates.com](mailto:jgaffrey@signatureassociates.com)

**SIGNATURE ASSOCIATES**

One Towne Square, Suite 1200

Southfield, MI 48076

[www.signatureassociates.com](http://www.signatureassociates.com)