

241 Burgess Road

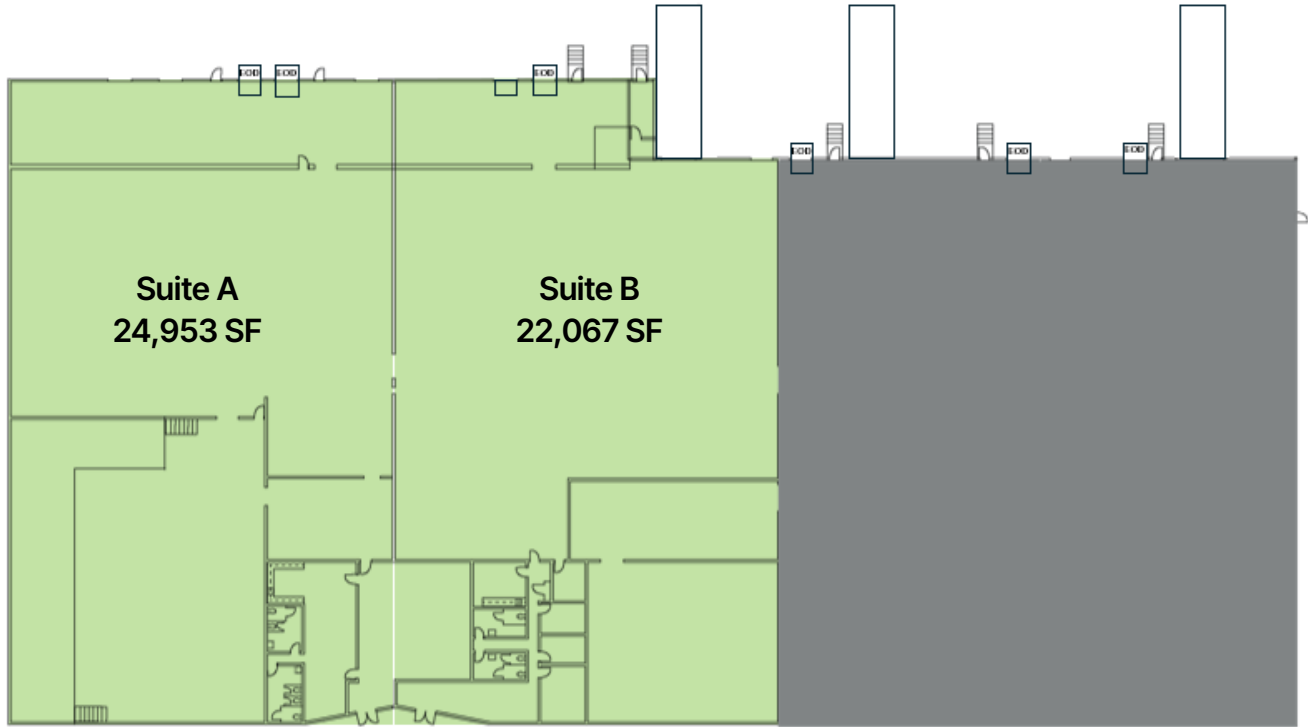

AVAILABLE AUGUST 1, 2026

PARTIALLY CONDITIONED WAREHOUSE

Available SF: 22,067 - 47,020

Lighting: LED

Office SF: ±6,304

Sprinkler: Wet System

Clear Height: 20'

Dock Doors: Eight (8) 8' x 10'
Four (4) W/Pit levelers

Column Spacing: 40' x 50'

Drive-In Door: One (1) 12' x 12'