



OFFICE SUBLEASE AVAILABLE

N/E/C of West 39th Street
1412 Broadway | NY

SUBLEASE OVERVIEW

RATE:	Call for Details
PREMISES:	Partial 4th floor
SQUARE FOOTAGE:	6,109 SF
SUBLEASE THROUGH:	12/31/2026
AVAILABILITY:	Immediate
YEAR BUILT/RENOVATED:	1926/2014



BUILDING NOTES

The building features on-site security, concierge services, modern elevators, an upscale on-site restaurant, and a rooftop deck offering breathtaking city views.

Just steps away from iconic landmarks such as Times Square and Bryant Park, and within a short walk of major transportation hubs like Port Authority, Penn Station and Grand Central Terminal, 1412 Broadway provides unmatched accessibility and prestige for businesses seeking a prime Manhattan address.

SPACE NOTES

- 8 private offices, 12 workstations, a large conference room, a dedicated meeting room, and an eat-in pantry
- Fully furnished, equipped, and professionally wired for seamless operations
- Views of Broadway
- Natural light throughout the space

CONTACT



NICK MARKEL
914.980.3634 direct
nmarkel@cresa.com



SAM STEINBERG
631.848.1682 direct
ssteinberg@cresa.com



1412 Broadway
New York, NY 10018



PARTIAL 4TH FLOOR: 6,109 SF

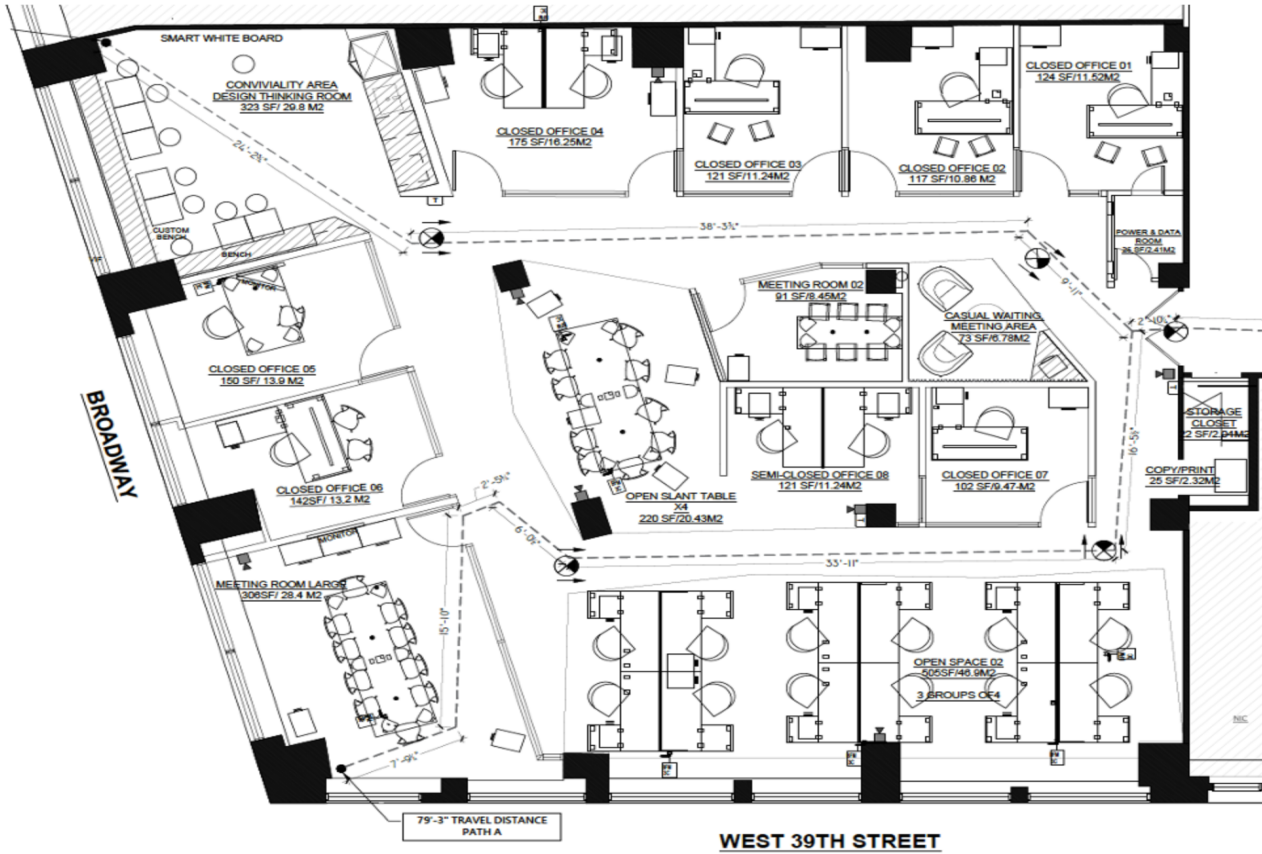

1412 Broadway
New York, NY 10018

