



10620, 10630, 10670, 10680, DEAN MARTIN DRIVE LAS VEGAS, NV 89141

RETAIL AVAILABLE IN NEW KAKTUS LIFE MULTI-TENANT STRIP CENTER

FOR LEASE: ±2,280 SF AVAILABLE

Strategically located adjacent to the Keller Cactus Hills Luxury apartment complex units

Scot Marker
Director
+1 702 688 6890
scot.marker@cushwake.com
Lic # NV-S.0034109



PROPERTY HIGHLIGHTS

1. Upscale retail center located in rapidly growing trade area adjacent to the I-15 Freeway at the Cactus Road exit.
2. Strong tenant mix with medical uses, restaurants and other retail services nestled in a community atmosphere.
3. The retail center has a built-in audience with the 210 unit apartment complex "Keller Cactus Hills" next door to the east.
4. Great street visibility from Dean Martin Drive.

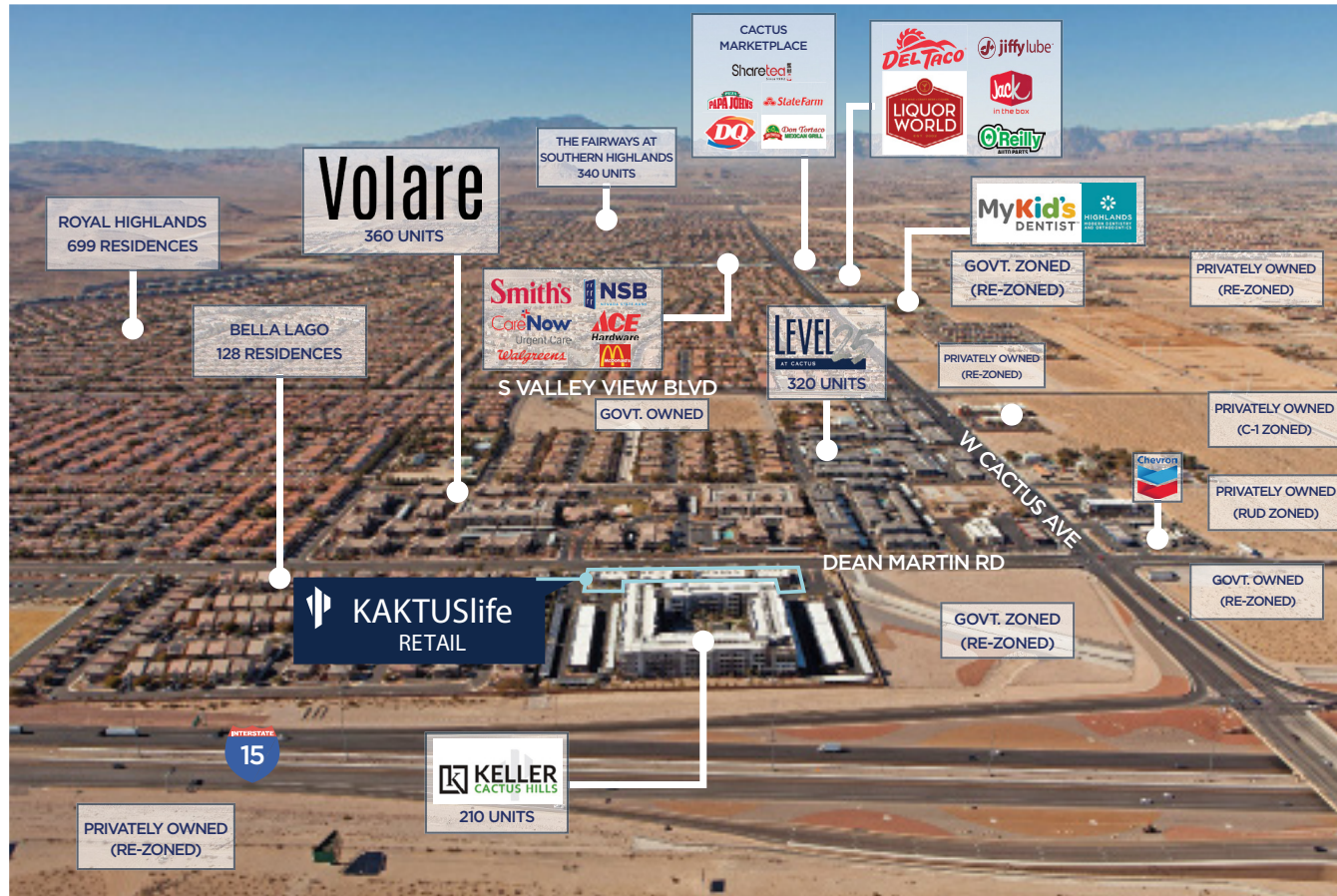

AREA DEMOGRAPHICS SOURCE: ESRI, 2022



TOTAL POPULATION

1 mile: 12,609
3 miles: 117,887
5 miles: 4,270,984



AVG. HOUSEHOLD INCOME

1 mile: 107,269
3 miles: 99,584
5 miles: 103,304



TRAFFIC COUNTS

12,000 Vehicles per Day on Dean Martin Drive

SITE PLAN

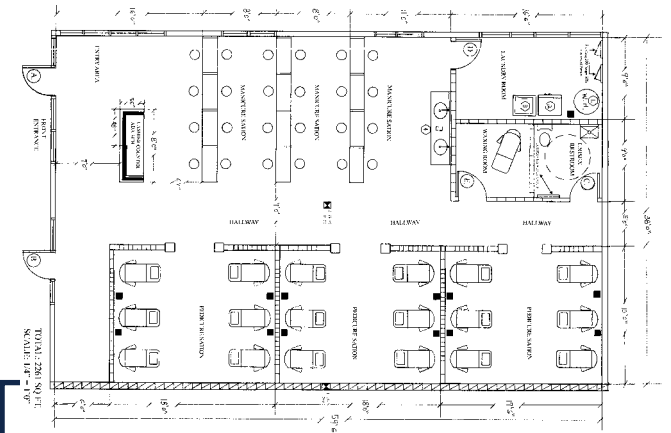

[CLICK HERE TO VIEW](#)



LOCATOR MAP

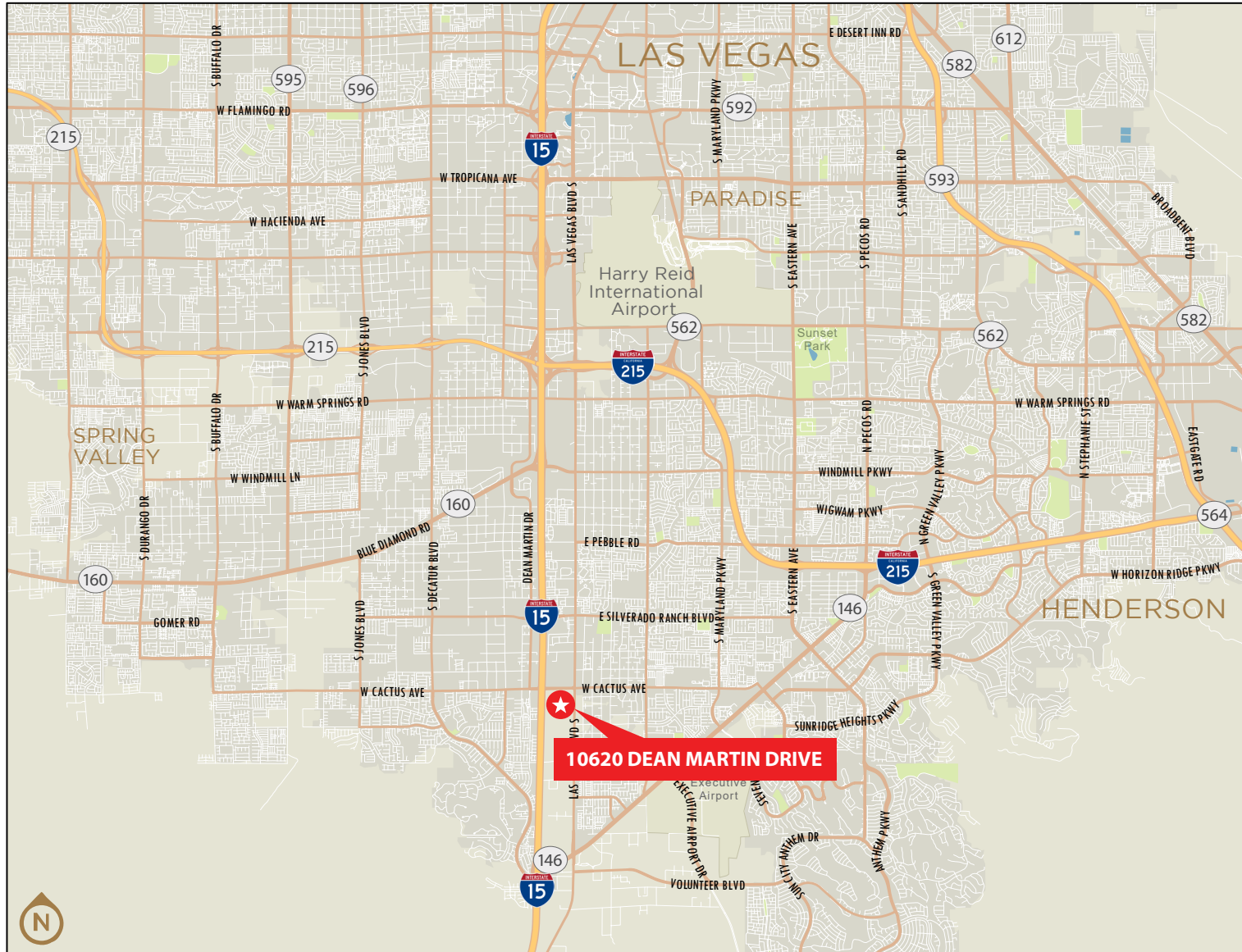

PROPERTY PHOTOS





KAKTUSlife
RETAIL

10620, 10630, 10670, 10680
Dean Martin Drive
 Las Vegas, NV 89141



For more information
 please contact:

Scot Marker
 Director
 +1 702 688 6890
 scot.marker@cushwake.com
 Licensee # NV-S.0178140

6725 Via Austi Pkwy., Wired Certified Gold
 Las Vegas, Nevada 89119
 +1 702 796 7900
 cushmanwakefield.com

©2023 Cushman & Wakefield. All rights reserved. The information contained in this communication is strictly confidential. This information has been obtained from sources believed to be reliable but has not been verified. NO WARRANTY OR REPRESENTATION, EXPRESS OR IMPLIED, IS MADE AS TO THE CONDITION OF THE PROPERTY (OR PROPERTIES) REFERENCED HEREIN OR AS TO THE ACCURACY OR COMPLETENESS OF THE INFORMATION CONTAINED HEREIN, AND SAME IS SUBMITTED SUBJECT TO ERRORS, OMISSIONS, CHANGE OF PRICE, RENTAL OR OTHER CONDITIONS, WITHDRAWAL WITHOUT NOTICE, AND TO ANY SPECIAL LISTING CONDITIONS IMPOSED BY THE PROPERTY OWNER(S). ANY PROJECTIONS, OPINIONS OR ESTIMATES ARE SUBJECT TO UNCERTAINTY AND DO NOT SIGNIFY CURRENT OR FUTURE PROPERTY PERFORMANCE.

