

3 AVAILABLE FOR LEASE

29870 - 29900 SKOKIE HIGHWAY, LAKE BLUFF, IL 60044



PROPERTY DESCRIPTION

This property features metal construction and is fully sprinklered. It offers ample surface parking spots and is conveniently located just east of I-94. All units have access to common docks.

SPACES	LEASE RATE	SPACE SIZE
Suite 102A	Subject to Offer	2,096 SF
Suite 103	Subject to Offer	3,787 SF
Suite 105	Subject to Offer	6,289 SF

OFFERING SUMMARY

Building Size	67,879 SF on 6.69 Acres
Ceiling Height	16 - 19 ft
Loading	18 grade level doors & 3 common docks
Zoning	CW (Commercial & Warehouse)
Lease Rate	Negotiable

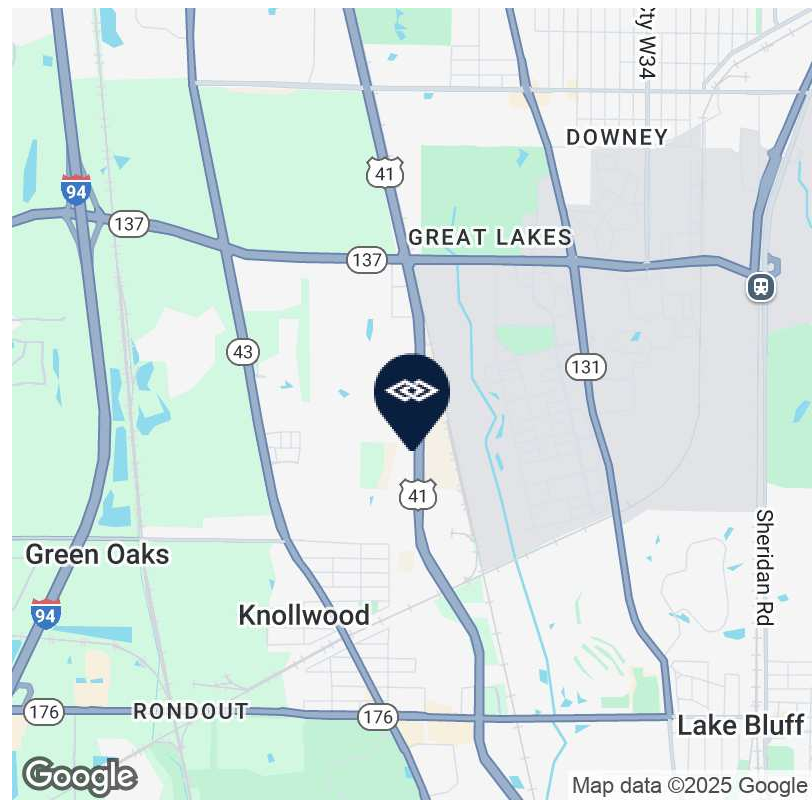

3 AVAILABLE FOR LEASE

29870 - 29900 SKOKIE HIGHWAY, LAKE BLUFF, IL 60044

29900 SKOKIE HWY

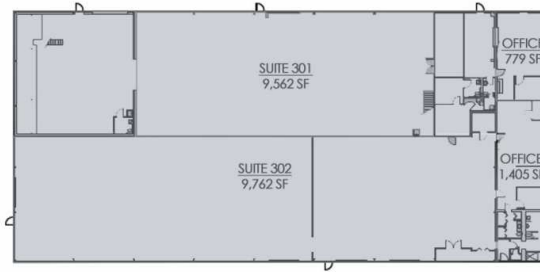

29870 SKOKIE HWY

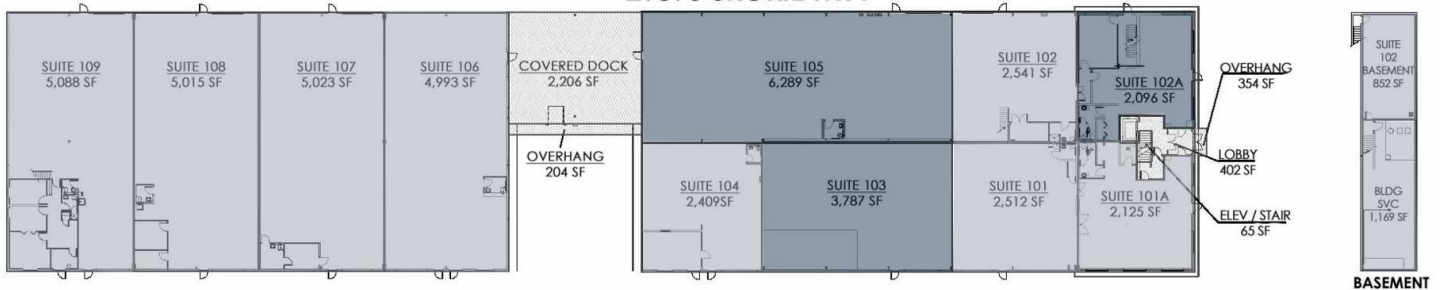

AVAILABLE SPACES

SUITE	SIZE	TYPE	RATE	DESCRIPTION
Suite 102A	2,096 SF	Modified Gross	Subject to Offer	This unit can be used as an office or flex space.
Suite 103	3,787 SF	Modified Gross	Subject to Offer	1 Drive-in door
Suite 105	6,289 SF	Modified Gross	Subject to Offer	1 Drive-in door