



BOUNDARY

PEACHTREE AT 17TH

PROGRESSING

POSSIBILITY AT

PEACHTREE AT 17TH

INTRODUCING BOUNDARY

Boundary is a visionary three-building campus centered between Uptown and The Arts District, located at the prominent intersection of Peachtree and 17th in Midtown ATL. Recently acquired by Parkside Partners with dramatic redevelopment and architectural unification efforts realized — discover dynamic space for companies seeking a Peachtree Street address and unmatched visibility.

Availabilities range from 2,000 SF to exclusive full floor opportunities with new custom buildout and exterior building signage opportunities.

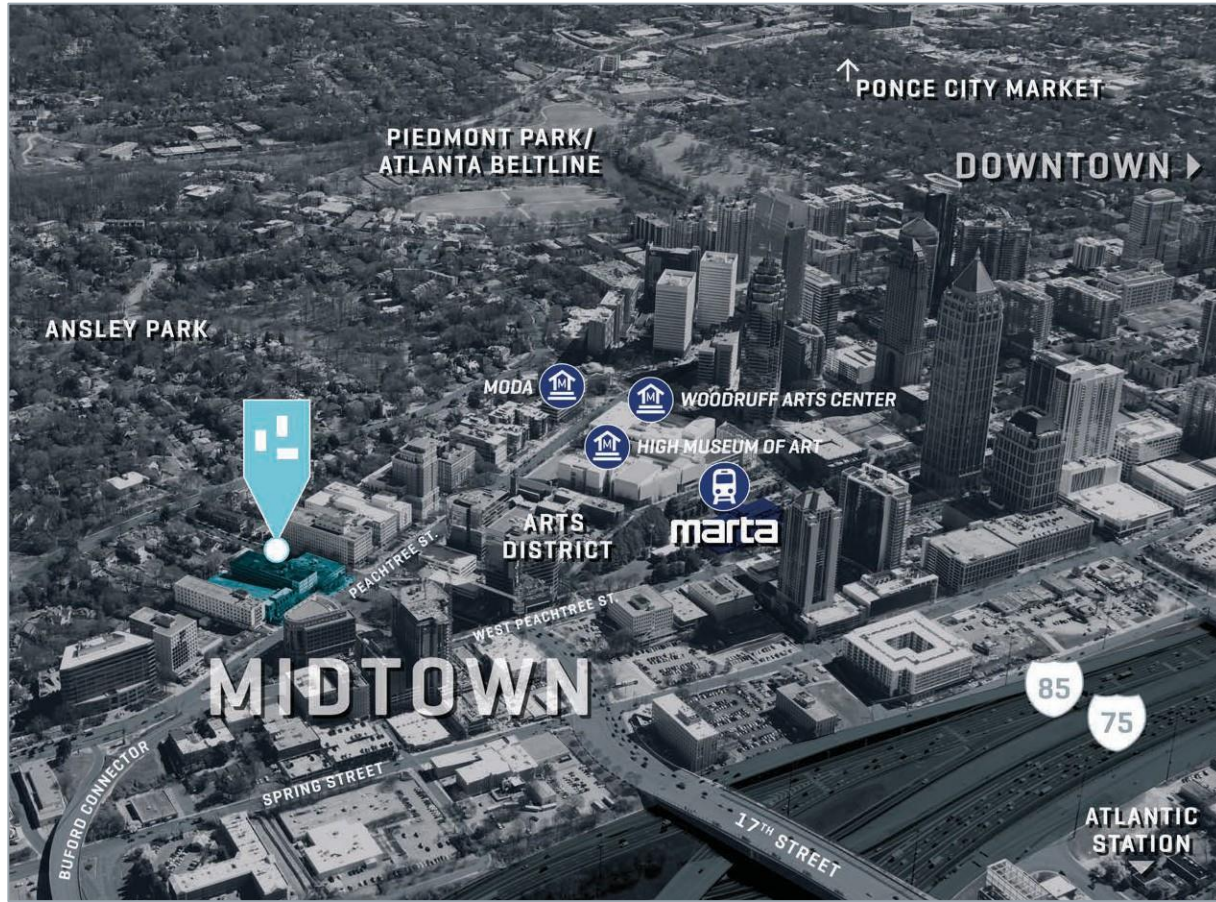

Short bike ride to Piedmont Park and the Atlanta BeltLine



Preferred access to I-75/85 and the Buford Connector (< .4 miles)



Abundant surface street alt. route access via 17th Street

PROXIMITY ON PACE

SELECT WALKABLE AMENITIES

HIGH

HUGE × BRASH



5 MIN. to MODA, High Museum of Art, and The Woodruff Arts Center

6 MIN. to MARTA Arts Center Station

8 MIN. to Colony Square amenities

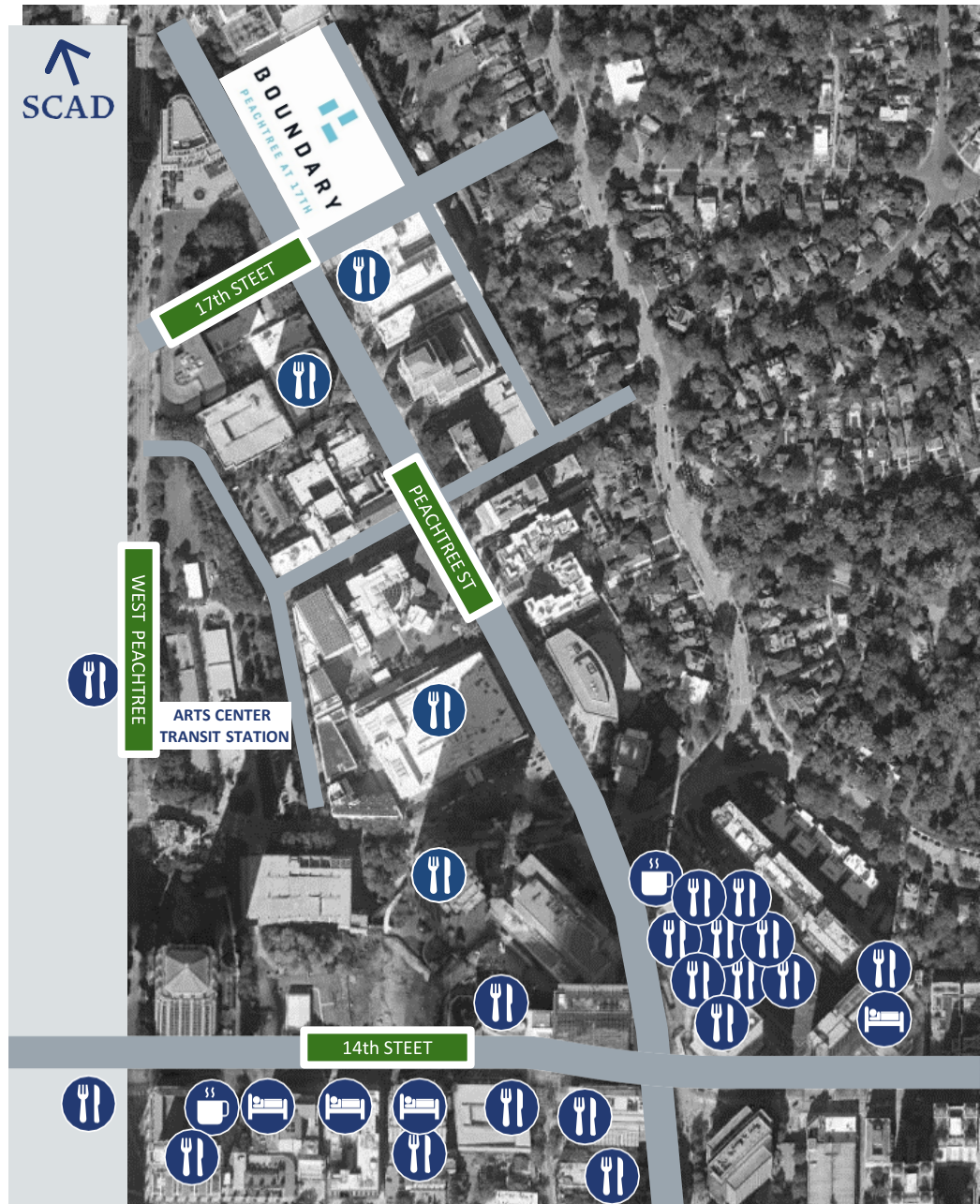

AVAILABILITIES OVERVIEW

1401 PEACHTREE

- 97,339 SF on 5 Levels
- Creative Office & Arcade-Level Retail/Showroom
- Contiguous Availabilities from 1,000 SF to 13,750 SF

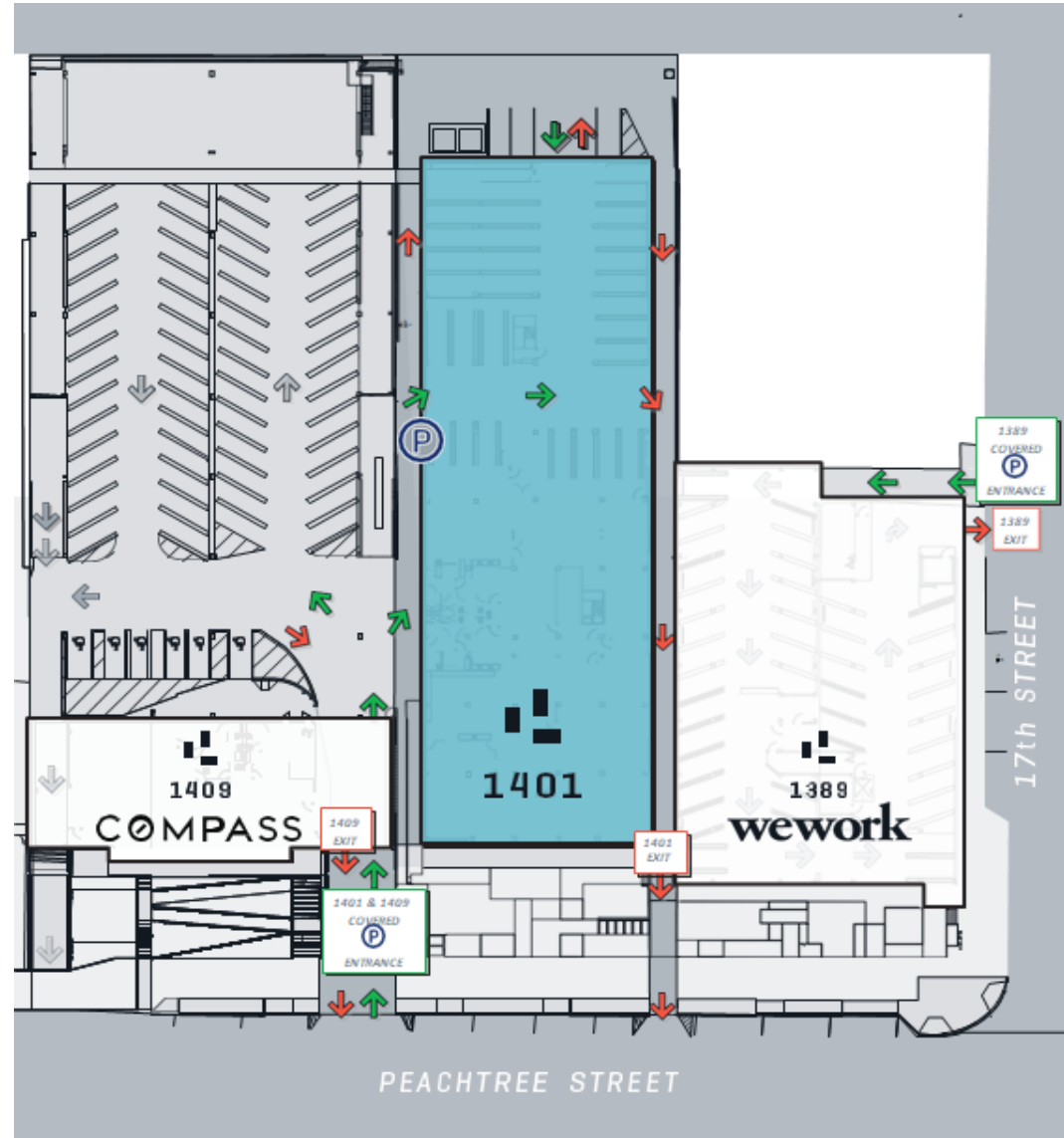

1401 PEACHTREE – STACKING PLAN



1401 PEACHTREE – SOCIAL HUB & PROJECT AMENITIES

SOCIAL HUB

- Shared Conference Room
- Social Breakout Areas, Games & Event Space
- State-of-the-Art Fitness Center
- Common Restrooms with Showers

OUTDOOR AMENITIES

- Turfed Linear Park with Peachtree Street Frontage
- Secluded Pocket Park



BOUNDARY – PROJECT PHOTOGRAPHY

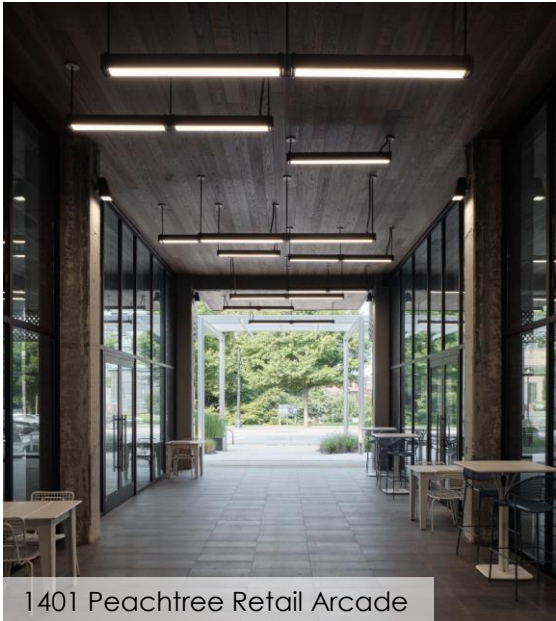

Leased & Developed by:

BOUNDARY – PROJECT PHOTOGRAPHY



1401 Peachtree Social Hub



1401 Peachtree Social Hub



Pocket Park



Pocket Park



1401 Peachtree Lobby



LEASING CONTACTS

KYLE JENKS
404.660.9494

SAM HIGGINS
404.713.5951

Leased & Developed by:

