



**FOR LEASE**

# Valley Centre Corporate Park

2302 B Street NW, Bldg 4, Auburn, WA 98001

*Prime industrial corner unit location with access to 167.*

### PROPERTY HIGHLIGHTS

- + Free standing building
- + 4,299 SF office and 1,425 SF office
- + 41 trailer stalls (up to 82 stalls if tenant uses angle parking on east side of building)
- + Fenced and secured truck court
- + 50 DH (9'x10'), 4 GL (12' x14')
  - » 28 DH doors equipped with pit levelers, and 14 with edge-of-dock levelers.
- + 30' clear height
- + ESFR sprinklers
- + Column spacing - 43'9" x 60'
- + Lots of parking
- + 1200 amps of 277/480 volt, 3-phase power

AVAILABLE SF  
**191,824 SF**

TOTAL OFFICE SF  
**5,724 SF**

LEASE RATE  
**Call for Rates**

OCCUPANCY DATE  
**Available Now**

<b>JEFF FORSBERG, CCIM</b> Principal +1 425 586 5610 jforsberg@nai-psp.com	<b>ARIE SALOMON, SIOR, CCIM</b> Principal +1 425 586 5636 asalomon@nai-psp.com	<b>BRET MATYSIK</b> Vice President +1 425 586 5617 bmatysik@nai-psp.com
---	---	--



THE INFORMATION CONTAINED HEREIN HAS BEEN GIVEN TO US BY THE OWNER OF THE PROPERTY OR OTHER SOURCES WE DEEM RELIABLE, WE HAVE NO REASON TO DOUBT ITS ACCURACY, BUT WE DO NOT GUARANTEE IT. ALL INFORMATION SHOULD BE VERIFIED PRIOR TO PURCHASE OR LEASE.



# Floor Plan

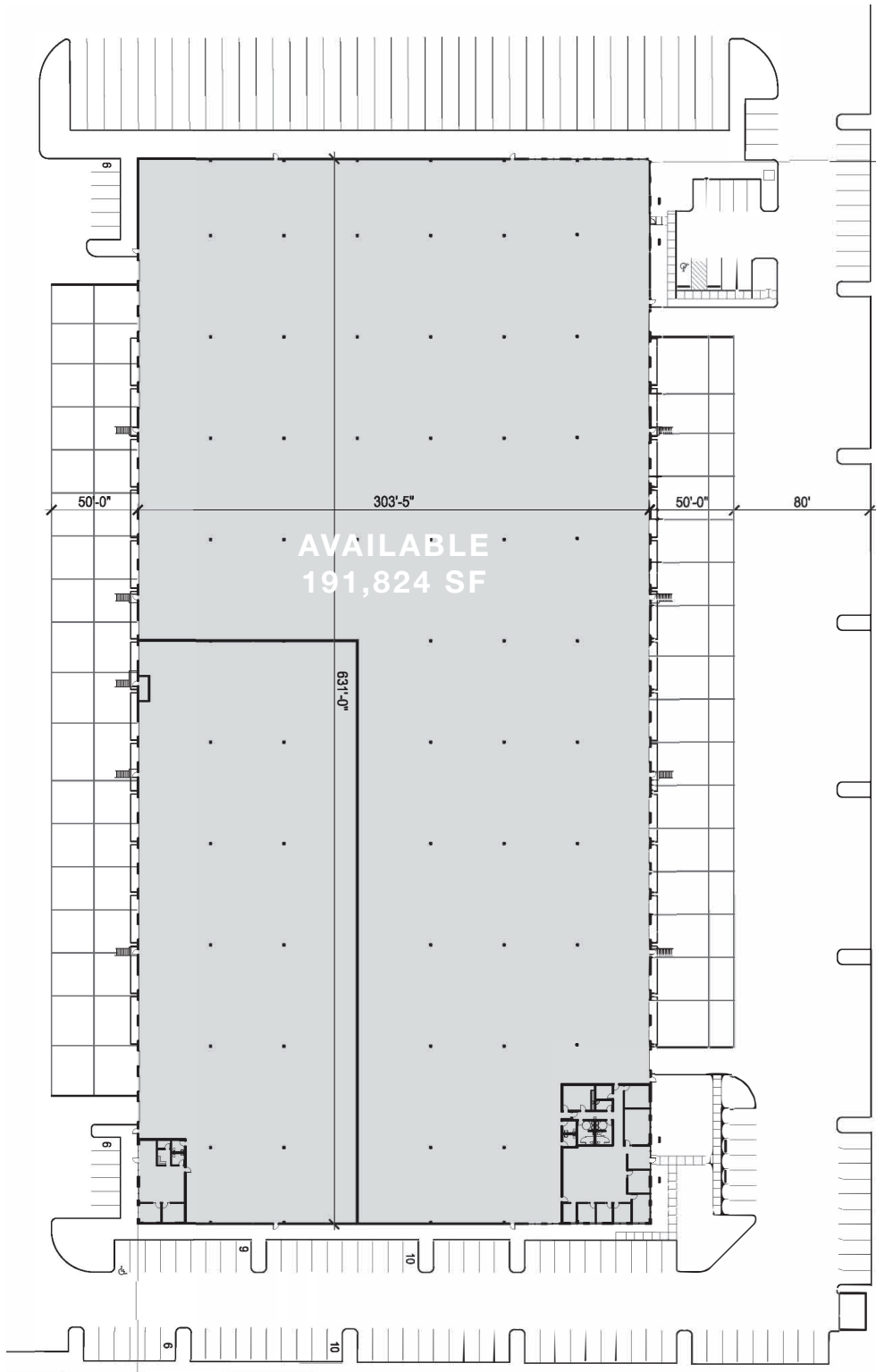

**JEFF FORSBERG, CCIM**  
Principal  
+1 425 586 5610  
jforsberg@nai-pp.com

**ARIE SALOMON, SIOR, CCIM**  
Principal  
+1 425 586 5636  
asalomon@nai-pp.com

**BRET MATYSIK**  
Vice President  
+1 425 586 5617  
bmatysik@nai-pp.com

