

1 inch = 1224.23 feet

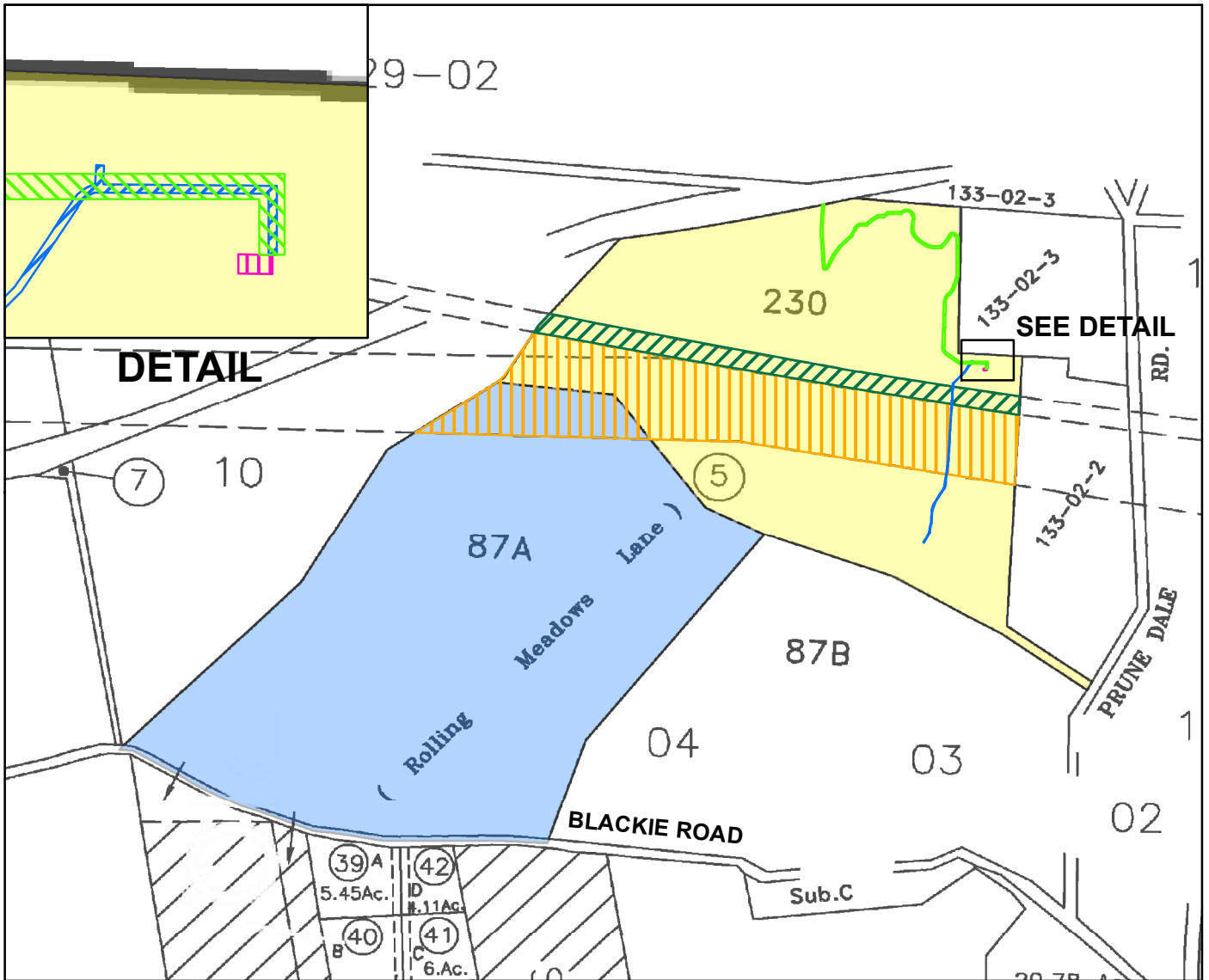

Legend

- PARCEL I - Property In Question, Fee
- PARCEL II - Property In Question, Fee
- Item No. 8 - Easement for Electric Tower Lines
In 09/13/1949 Bk1160 Pg338 of Official Records
Affects said portion as described in the document
- Item No. 9 - Easement for Electrical Energy & Communication
In 10/13/1965 Reel 428 Pg668 of Official Records
Affects said portion as described in the document
- Item No. 11 - Easement for Access
In 07/11/2002 Inst # 2002064478 of Official Records
Affects said portion as described in the document
- Item No. 11 - Easement for Utility
In 07/11/2002 Inst # 2002064478 of Official Records
Affects said portion as described in the document
- Item No. 11 - Easement for Equipment
In 07/11/2002 Inst # 2002064478 of Official Records
Affects said portion as described in the document

©2024
Chicago Title Company
 50 Winham Street
 Salinas, CA 93901

This map/plot is being furnished as an aid in locating the herein described Land in relation to adjoining streets, natural boundaries and other land, and is not a survey of the land depicted. Except to the extent a policy of title insurance is expressly modified by endorsement, if any, the Company does not insure dimensions, distances, location of easements, acreage or other matters shown thereon.

Title Order No. : FWMN-5222400331, Preliminary Report Dated May 1, 2024
 Reference :
 Property : 16475 Blackie Road, Salinas, CA

Drawing Date : 05/13/2024 - FNFI
 Assessor's Parcel No. : 133-012-005
 Data :

Plat Showing : A PORTION OF LAND IS SITUATED IN THE UNINCORPORATED AREA IN COUNTY OF MONTEREY, STATE OF CALIFORNIA