

**FOR LEASE**

# PRIME COMMUNITY RETAIL CENTER

## Property Highlights

- 184,393± SF community shopping center serving Syracuse's West Side
- Flexible floor plan with up to 53,269± SF available contiguous; minimum divisible suite of 12,460± SF
- Suite 2138 (983± SF) also available
- National anchors include Planet Fitness, Family Dollar and O'Reilly Auto Parts
- Strong tenant mix across fitness, retail, banking, and dining
- 646± surface parking spaces provide abundant customer convenience
- Located on West Genesee Street, a major retail corridor with steady daily traffic
- Centrally positioned within a dense residential trade area — nearly 13,800 residents within 1 mile and more than 80,000 within 3 miles
- Signalized full-access entrance on West Genesee Street for convenient ingress/egress

Demographic	1 Mile	3 Miles	5 Miles
Population	12,983	85,992	213,137
Households	6,129	37,780	89,420
Average H.H. Income	\$90,644	\$78,329	\$82,454
Daytime Employees	3,551	63,150	135,195

Source: ESRI Business Analyst 2025

## Traffic Counts

W Genesee Street	11,361 AADT
------------------	-------------

Source: NYS DOT 2024

## EXCLUSIVE CONTACT

**Leonard DeStefano**  
Real Estate Salesperson  
+1 315 382 0174  
ldestefano@pyramidbrokerage.com

**Lila "Lee" M. Salvetti**  
Associate Real Estate Broker  
+1 315 254 3447  
lsalvetti@pyramidbrokerage.com

5845 Widewaters Parkway, Suite 200  
East Syracuse, New York 13057  
+1 315 445 1030  
**pyramidbrokerage.com**



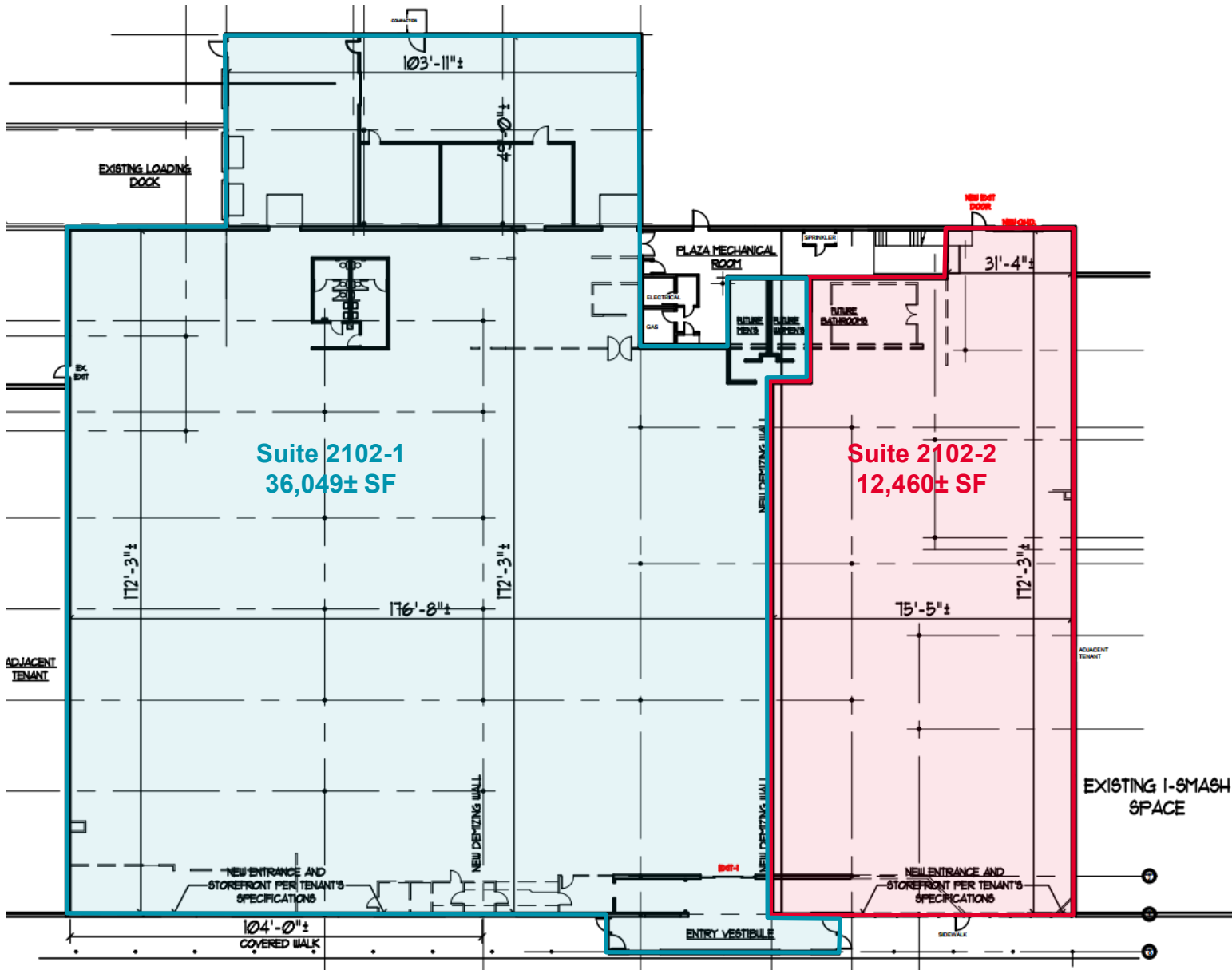

**Note: 53,269± SF former grocery store can be demised into two spaces – 12,460± SF and 36,049± SF**

