

FOR LEASE | MEDICAL OFFICE

1506 N THORNTON AVE

DALTON, GEORGIA 30720

NORTHWEST GEORGIA MEDICAL PLAZA

PROPERTY HIGHLIGHTS

TOTAL AVAILABLE SF: ± 3,226 SUITE A

TOTAL BUILDING SF: ± 9,835

LEASE RATE: CALL BROKER FOR PRICING

PARKING: SURFACE LOT

PROPERTY SUMMARY

NORTHWEST GEORGIA MEDICAL PLAZA PRESENTS AN EXCEPTIONAL OPPORTUNITY FOR MEDICAL PRACTITIONERS SEEKING A WELL-ESTABLISHED PRESENCE IN DALTON, GEORGIA'S PRIMARY MEDICAL CORRIDOR. THIS 9,835 SF MULTI-TENANT MEDICAL OFFICE BUILDING IS ONE OF THREE BUILDINGS ALONG HIGH-TRAFFIC NORTH THORNTON AVE, OFFERING OUTSTANDING VISIBILITY WITH OVER 27,000 VEHICLES PER DAY ON THE ADJACENT NORTH BYPASS. THE BUILDING HAS A STRONG HISTORY OF ATTRACTING SPECIALTY MEDICAL TENANTS MAKING IT AN IDEAL ENVIRONMENT FOR PRACTICES LOOKING TO BENEFIT FROM CO-TENANCY WITH ESTABLISHED PROVIDERS.

MERCHANT
REAL ESTATE GROUP



FLOOR PLAN

NORTHWEST GEORGIA MEDICAL PLAZA
1506 N THORNTON AVE DALTON, GEORGIA 30720

SUITE A ± 3,226 SF

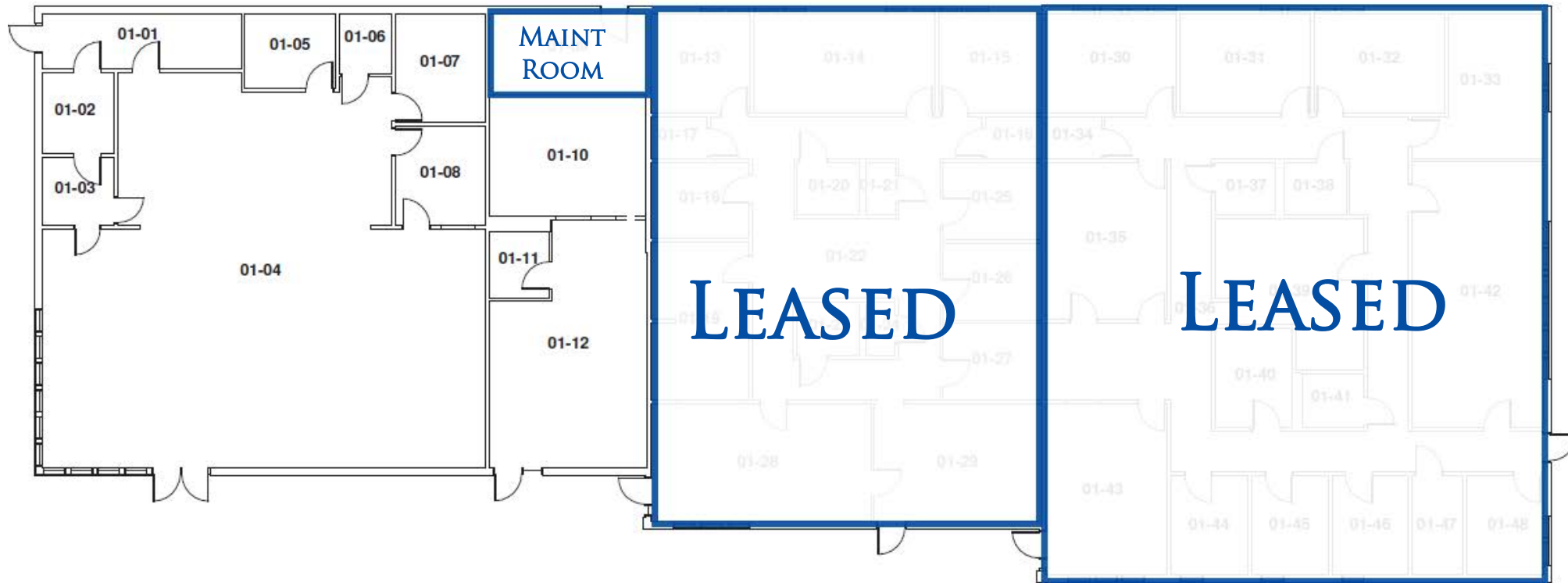

SUITE SUMMARY

SUITE A OFFERS A PREMIER MEDICAL OFFICE OPPORTUNITY WITHIN NORTHWEST GEORGIA MEDICAL PLAZA, A WELL-ESTABLISHED HEALTHCARE DESTINATION LOCATED ON HIGHLY VISIBLE NORTH THORNTON AVENUE. THE PROPERTY PROVIDES AN IDEAL SETTING FOR HEALTHCARE PROVIDERS SEEKING A STRATEGIC LOCATION WITHIN DALTON'S PRIMARY MEDICAL CORRIDOR.

THE AVAILABLE SUITE FEATURES APPROXIMATELY **3,226 SQUARE FEET** AND IS WELL SUITED FOR A VARIETY OF HEALTHCARE USES. ITS EFFICIENT LAYOUT, STRONG VISIBILITY, CONVENIENT ACCESS, AND AMPLE PARKING CREATE AN EXCEPTIONAL PATIENT EXPERIENCE WHILE SUPPORTING PRACTICE GROWTH.

AERIAL OVERVIEW

NORTHWEST GEORGIA MEDICAL PLAZA
1506 N THORNTON AVE DALTON, GEORGIA 30720



MERCHANT
REAL ESTATE GROUP

+1 423 654-7106

BARRETT KIBBLE
BROKER

+1 423 715 9645

BARRETT@MERCHANTLH.COM

THIS INFORMATION HAS BEEN OBTAINED FROM SOURCES BELIEVED RELIABLE, BUT HAS NOT BEEN VERIFIED FOR ACCURACY OR COMPLETENESS. YOU SHOULD CONDUCT A CAREFUL, INDEPENDENT INVESTIGATION OF THE PROPERTY AND VERIFY ALL INFORMATION. ANY RELIANCE ON THIS INFORMATION IS SOLELY AT YOUR OWN RISK. ALL OTHER MARKS DISPLAYED ON THIS DOCUMENT ARE THE PROPERTY OF THEIR RESPECTIVE OWNERS, AND THE USE OF SUCH LOGOS DOES NOT IMPLY ANY AFFILIATION WITH OR ENDORSEMENT OF MERCHANT REAL ESTATE GROUP. PHOTOS HEREIN ARE THE PROPERTY OF THEIR RESPECTIVE OWNERS. USE OF THESE IMAGES WITHOUT THE EXPRESS WRITTEN CONSENT OF THE OWNER IS PROHIBITED.