

WALL LEGEND

- PRECAST PANELS WALL
- INTERIOR PARTITION
- 2 HR FIRE RATE INTERIOR PARTITION

EXIT SIGNAL w/ BATTERY BACK UP (SEE ELECT. DRAWINGS)

Self-contained emergency lighting unit, wall, 90 min battery back-up

FIRE EXTINGUISHER

PROJECT NOTES

- N-01. All dimensions to be field verified by contractor.
- N-02. All door dimensions shown to be verified by GC. Refer to schedule for door size and type.
- N-03. All ADA clearances to be verified and adhered to by GC.
- N-04. Threshold shall have 1/2" beveled maximum HT. at main accessible entrance door 5 feet of the front door.
- N-05. Provide sign posted on top of door w/ Maximum permitted occupancy to remain within 5 feet of the front door.
- N-06. Provide Address building number according N.F.P.A 1012.1 thru 1012.1.3
- N-07. Steel stud supporting hung plumbing fixtures shall be double and or no less than 20 gauge.
- N-08. All glass windows/doors to receive impact resistant glass and to comply w/energy calculation.
- N-09. Glass to be safety glass cat-II

Building #2 | Ground Floor
Scale: 3/16" = 1'-0"

Issue	Issue date / For

PROJECT NO.	
DATE	12/22/2020

PROJECT ADDRESS
221 NE 67 ST MIAMI FL 33138

FOLIO: 01-3218-020-0020
01-3218-020-0031
01-3218-020-0040

PROJECT NAME:
NEW WAREHOUSES CONDOMINIUM

SHEET TITLE
GROUND FLOOR PLAN BUILDING #2

CONSULTANTS:

ALL DOCUMENTS, DESIGNS, SCHEDULES, SPECIFICATIONS AND DETAILS INDICATED OR REPRESENTED BY THESE DRAWINGS ARE AND SHALL REMAIN THE PROPERTY OF CARMEN T DIAZ ARCHITECT. THESE DRAWINGS ARE FOR THE USE ON AND IN CONNECTION WITH THE SPECIFIED PROJECT. THE OWNER AND/OR TENANT SHALL ONLY BE PERMITTED TO RETAIN COPIES OF THESE DRAWINGS FOR INFORMATION AND REFERENCE AND SHALL NOT BE USED OR REPRODUCED WHOLE OR IN PART WITH-OUT WRITTEN AGREEMENT OR BE LIABLE FOR THE FULLEST LEGAL RECOURSE



CARMEN T DIAZ, ARCH.
Florida Registration No.: AR96290
1901 NW South River Dr, Suite 30, Miami, FL 33125
www.ctdarch.com
email: ctd.architect@gmail.com | ph: 786-312-6000
Project manager: Pedro Achon
786 333 5066

SEAL:	DATE:
	12/22/2020
	SHEET
	AB-1.0

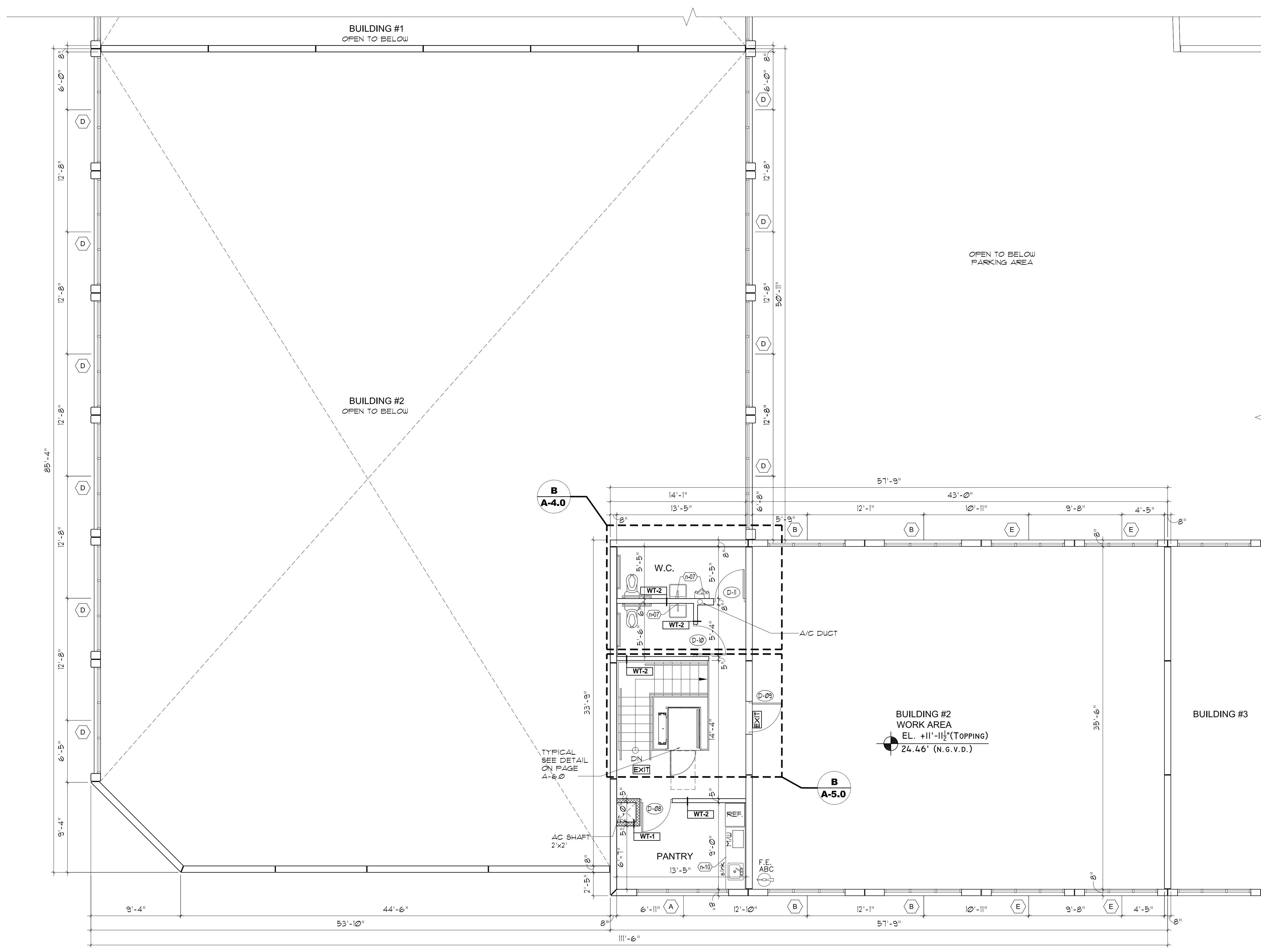

WALL LEGEND

- PRECAST WALL
- INTERIOR PARTITION
- 2 HR FIRE RATE INTERIOR PARTITION

EXIT EXIT SIGNAL w/ BATTERY BACK UP (SEE ELECT. DRAWINGS)

Self-contained emergency lighting unit, wall. 30 min battery back-up

ABC FIRE EXTINGUISHER

PROJECT NOTES

- N-01. All dimensions to be field verified by contractor.
- N-02. All door dimensions shown to be verified by GC. Refer to schedule for door size and type.
- N-03. All ADA clearances to be verified and adhered to by GC.
- N-04. Step shall have 1/2" beveled maximum HT.
- N-05. Provide sign posted on top of door w/ Maximum permitted occupancy to remain within 5 feet of the front door.
- N-06. Provide Address building number according N.F.P.A 102.12.1 thru 102.12.13
- N-07. Steel stud supporting hung plumbing fixtures shall be double and or no less than 20 gauge.
- N-08. All glass windows/doors to receive impact resistant glass and to comply w/energy calculation.
- N-09. Glass to be safety glass cat-II
- N-10. Counter top 36" Ht.

Building #2 | Mezzanine
Scale: 3/16" = 1'-0"

Issue	Issue date / For

PROJECT NO. _____
DATE 12/22/2020

PROJECT ADDRESS
221 NE 67 ST MIAMI FL 33138

FOLIO: 01-3218-020-0020
01-3218-020-0031
01-3218-020-0040

PROJECT NAME:
NEW WAREHOUSES CONDOMINIUM

SHEET TITLE
MEZZANINE FLOOR PLAN BUILDING #2

CONSULTANTS:
ALL DOCUMENTS, DESIGNS, SCHEDULES, SPECIFICATIONS AND DETAILS INDICATED OR REPRESENTED BY THESE DRAWINGS ARE AND SHALL REMAIN THE PROPERTY OF CARMEN T DIAZ ARCHITECT. THESE DRAWINGS ARE FOR THE USE ON AND IN CONNECTION WITH THE SPECIFIED PROJECT. THE OWNER AND/OR TENANT SHALL ONLY BE PERMITTED TO RETAIN COPIES OF THESE DRAWINGS FOR INFORMATION AND REFERENCE AND SHALL NOT BE USED OR REPRODUCED WHOLE OR IN PART WITHOUT WRITTEN AGREEMENT OR BE LIABLE FOR THE FULLEST LEGAL RECOURSE.

CARMEN T DIAZ, ARCH.
Florida Registration No.: AR96290
1901 NW South River Dr, Suite 30, Miami, FL 33125
www.ctdar.com
email: ctd.architect@gmail.com | ph: 786-312-6000
Project manager: Pedro Achon
786 333 5366

SEAL: _____
DATE: 12/22/2020
SHEET: _____
AB-1.1