

**Summit**  
Real Estate Group

**FOUNDRY**  
COMMERCIAL

**BUILDING 300**

2425 INNOVATION LOOP | YOUNGSVILLE, NC 27596

**US1NORTH**  
COMMERCE CENTER

**CLASS A INDUSTRIAL SPACE FOR LEASE OR PURCHASE**

**± 266,604 SF AVAILABLE (DIVISIBLE)**



# BUILDING 300



**BUILDING 100**  
FULLY LEASED

**BUILDING 500**  
FULLY LEASED

**BUILDING 400**  
±147,714 SF AVAILABLE

**BUILDING 300**  
±266,604 SF AVAILABLE

**BUILDING 200**  
±42,213 SF AVAILABLE

**ALEXIS LAMBETH**

Principal  
(919) 524-3593  
alexis.lambeth@foundrycommercial.com

**JIM ALLAIRE**

Principal  
(919) 270-9216  
jim.allaire@foundrycommercial.com

**MARIA LOMBARDI, MSRE**

Senior Associate  
(919) 899-5087  
maria.lombardi@foundrycommercial.com



[PROPERTY WEBSITE](#)



# BUILDING 300 SITE PLAN

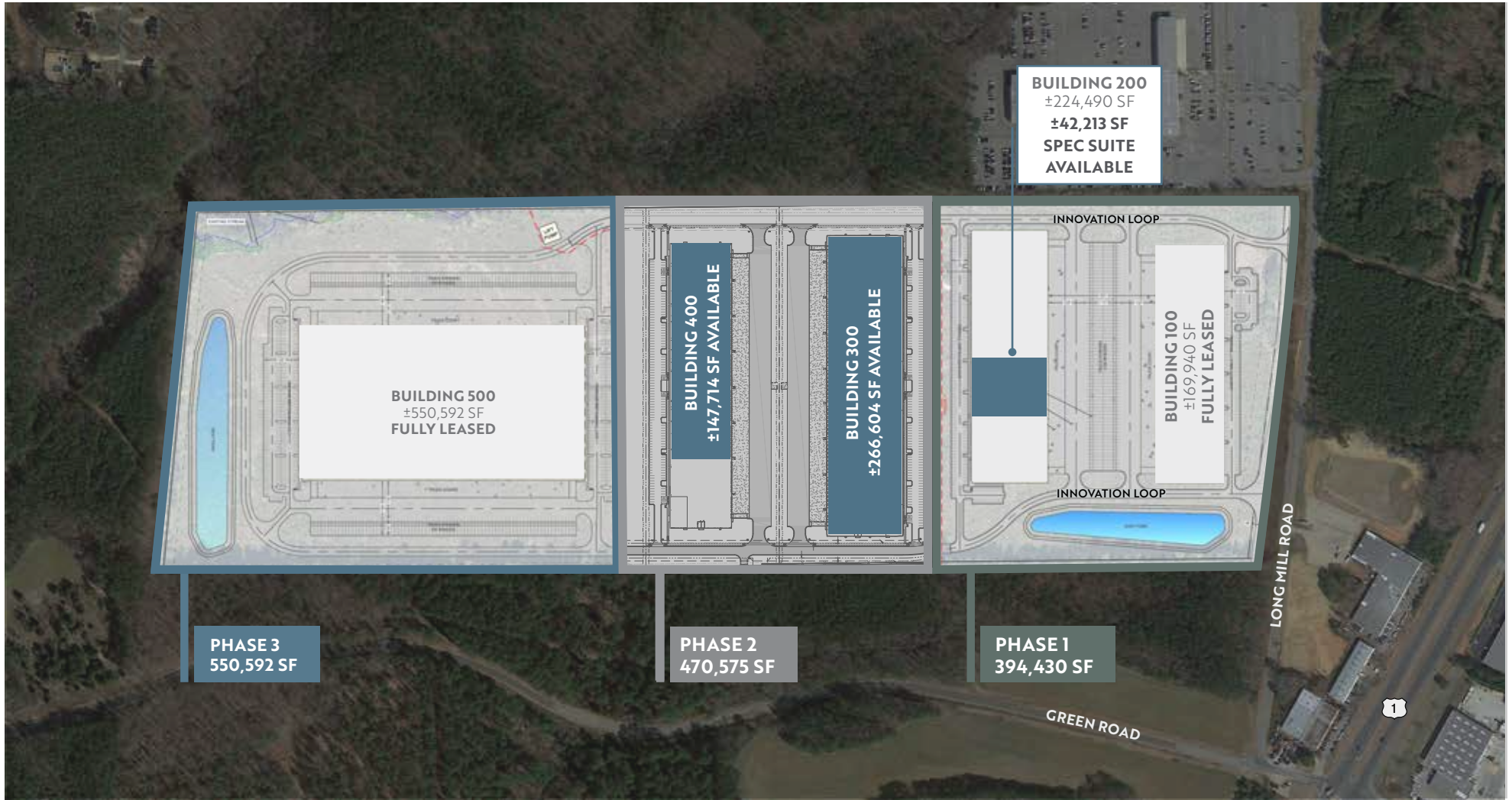

**ALEXIS LAMBETH**

Principal  
(919) 524-3593  
alexis.lambeth@foundrycommercial.com

**JIM ALLAIRE**

Principal  
(919) 270-9216  
jim.allaire@foundrycommercial.com

**MARIA LOMBARDI, MSRE**

Senior Associate  
(919) 899-5087  
maria.lombardi@foundrycommercial.com



[PROPERTY WEBSITE](#)

Although the information contained herein was provided by sources believed to be reliable, Foundry Commercial makes no representation, expressed or implied, as to its accuracy and said information is subject to errors, omissions or changes.



# BUILDING 300 FLOOR PLAN

±266,604 SF AVAILABLE (DIVISIBLE)

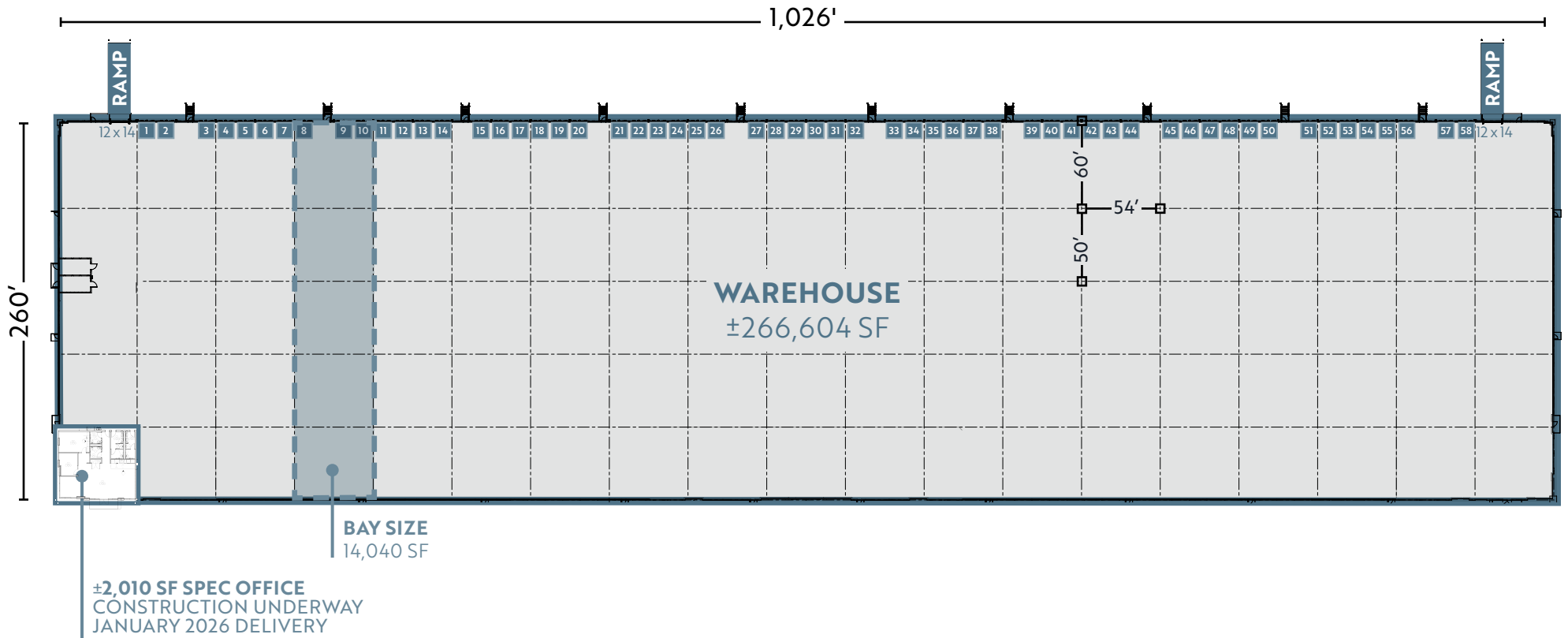

## D DOCK DOOR

### ALEXIS LAMBETH

Principal  
(919) 524-3593  
alexis.lambeth@foundrycommercial.com

### JIM ALLAIRE

Principal  
(919) 270-9216  
jim.allaire@foundrycommercial.com

### MARIA LOMBARDI, MSRE

Senior Associate  
(919) 899-5087  
maria.lombardi@foundrycommercial.com



PROPERTY WEBSITE



# BUILDING 300

## FLOOR PLAN ±2,010 SF SPEC OFFICE

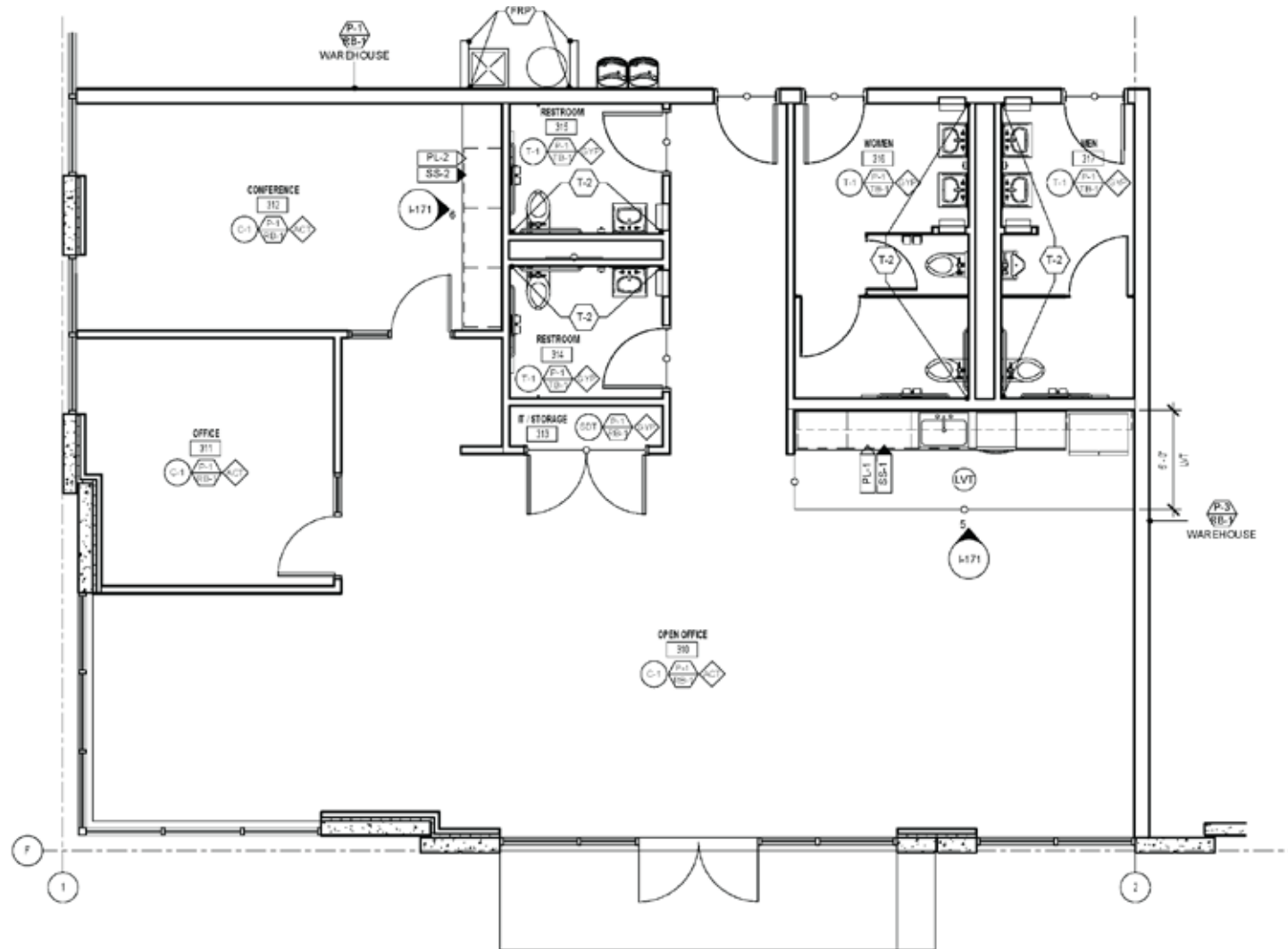

**ALEXIS LAMBETH**

Principal  
(919) 524-3593  
alexis.lambeth@foundrycommercial.com

**JIM ALLAIRE**

Principal  
(919) 270-9216  
jim.allaire@foundrycommercial.com

**MARIA LOMBARDI, MSRE**

Senior Associate  
(919) 899-5087  
maria.lombardi@foundrycommercial.com



**PROPERTY WEBSITE**



# BUILDING 300

## FEATURES

BUILDING NAME	US-1 North Building 300	COLUMN SPACING	54'x50' with 60' speed bay
ADDRESS	Innovation Loop Youngsville, NC 27596	SPRINKLER SYSTEM/TYPE	ESFR with K-17 sprinkler heads
COUNTY	Franklin	LOADING	58 (9'x10') manual dock doors with bumpers 2 (12'x14') drive-in doors with operators
DATE AVAILABLE	Estimated June 2025	PAVED PARKING	180 (ability to add more)
LEASE RATE	Call for pricing	TRAILER PARKING/OUTSIDE STORAGE	72 trailer parks available
TICAM	TBD	TRUCK COURT DEPTH	135' expandable to 190'
NCPIN:	1843-63-0059	LIGHTING	LED per tenant spec
ZONING	General Business (GB) <a href="#">ZONING INFO</a>	ELECTRICAL CAPACITY	277/480 Volt 3-phase, 4-wire 2000 Amp Electrical Service with four (4) 400 amp/480 volt 3-phase tenant panels
NO. OF ACRES	±17.29 acres	ELECTRICAL PROVIDER	Duke Energy Progress
BUILDING DIMENSIONS	1,026' x 260'	NATURAL GAS SERVICE PROVIDER	Dominion Energy
PARK TOTAL SF	±1,342,000 SF	WATER AND SEWER PROVIDER	Franklin County Public Utilities
AVAILABLE SF	±266,604 SF (Divisible)	SEWER LINE	6"
OFFICE SF	±2,010 SF spec office, delivering in April 2026	WATER MAIN SIZE	3"
BAY SIZE	±14,040 SF	TELECOM PROVIDER	TBD
EXTERIOR WALL MATERIAL	Concrete tilt wall construction	HVAC	Heat for freeze protection (to 50°F) Roof top make-up air units for air circulation
ROOFING MATERIAL	45 mil white TPO with R-15 poly-iso insulation (R-25 above office areas)		
FLOOR THICKNESS	6", unreinforced over 4" GAB with 10 MIL vapor-barrier		
CEILING HEIGHT	32' after speed bay		

# LOCAL INCENTIVES

## REDUCED OPERATING COSTS

USI North Commerce Center has the lowest Class A gross rents in the Raleigh-Durham MSA, job-based incentives and good labor.

## LOWER REAL ESTATE TAXES

USI North Commerce Center is an Unincorporated Franklin County, a Tier 2 county which has lower real estate taxes when compared to other Class A options in incorporated areas of Wake County and Durham County.

REAL ESTATE TAX ADVANTAGE	Tax Rate Per \$100 Taxable Value	Taxable Value PSF	Real Estate Taxes PSF	Additional RE Taxes/Yr (100,000 SF Tenant)
Unincorporated Franklin County	0.6047	\$125.00	\$0.76	
Wake County + Average Municipal Rate	0.9368	\$125.00	\$1.17	\$41,513
Durham County + Average Municipal Rate	0.9506	\$125.00	\$1.19	\$43,238

## PRE-NEGOTIATED JOB-BASED INCENTIVES

USI North Commerce Center has pre-negotiated job-based incentives which can be passed through to job creating tenants (new jobs to Franklin County)

*Up to \$7,364.86 per new job to Franklin County paid out over two years*

### EXAMPLE JOB BASED INCENTIVES

PHASE II - JOB	TENANT SIZE	
	50,000 SF	100,000 SF
New Jobs Created	50	
Incentive Per Job	\$7,364.86	
Total Incentive (Paid out over 4 years)	\$368,243.17	\$7.36/SF \$3.68/SF
Annual Payout	\$92,060.79	\$1.84/SF \$0.92/SF

# AREA AMENITIES

**US1N1RTH**  
COMMERCE CENTER



RICHLAND CREEK  
ELEMENTARY SCHOOL

## AREA EMPLOYERS

WAKE  
PREPARATORY  
ACADEMY

YOUNGVILLE  
ELEMENTARY SCHOOL

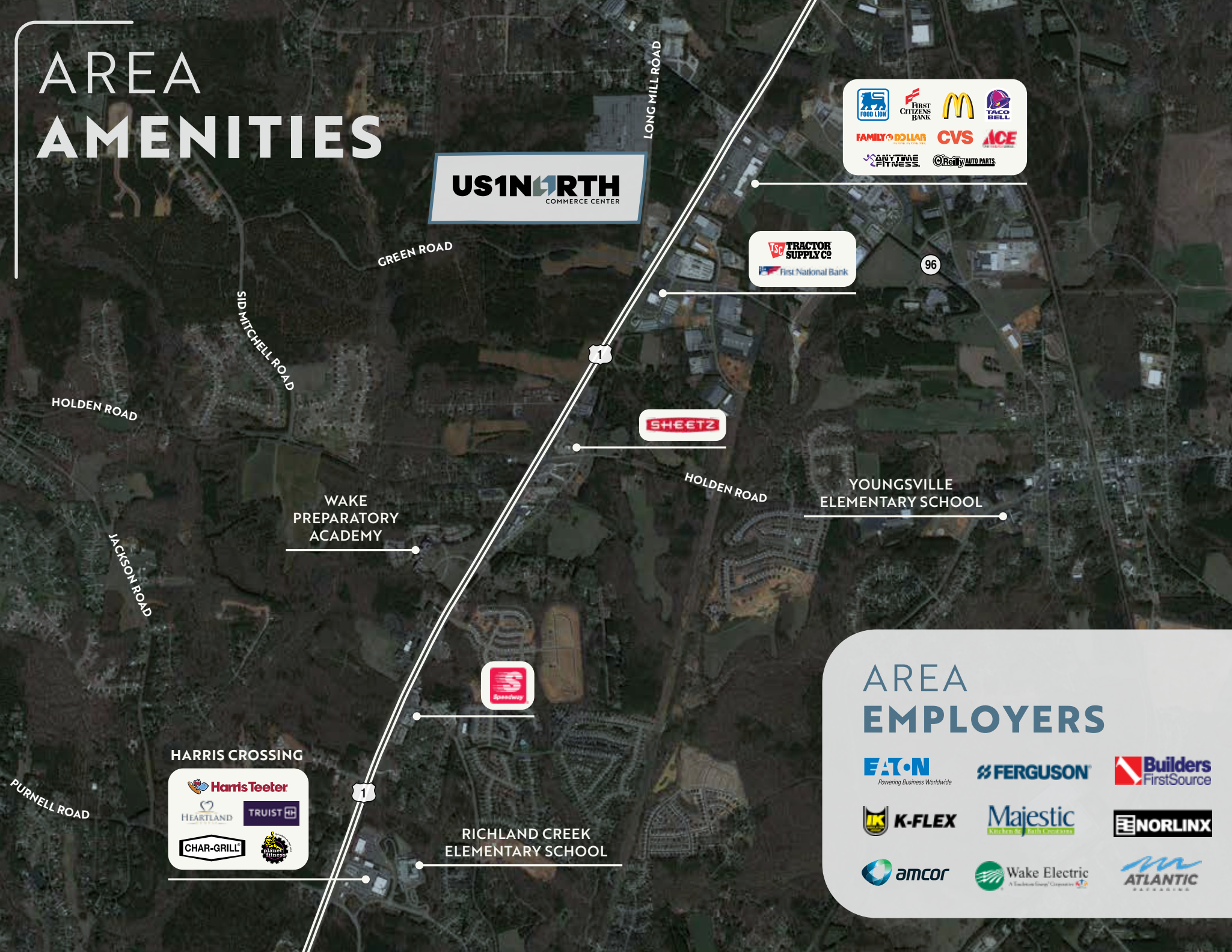

# LOCATION & ACCESS

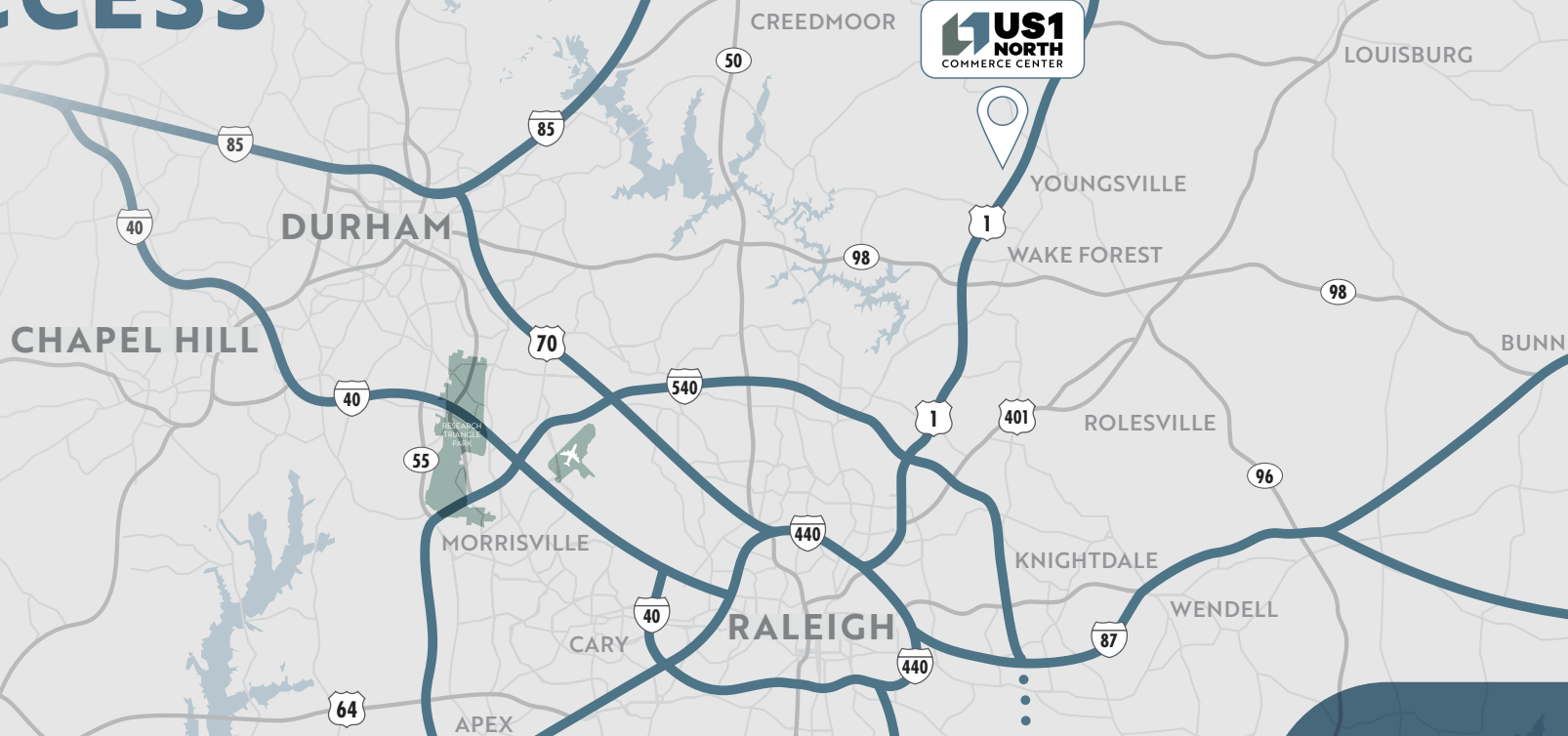

## FRANKLIN COUNTY GROWTH

Franklin County was ranked the second fastest-growing county in North Carolina between 2023 and 2024, posting a 3.5% annual population increase, according to the U.S. Census Bureau. This rapid growth continues to attract investors and industrial users seeking long-term opportunities along the US-1 corridor.

## INTERSTATES

Uninterrupted distribution to every major market in the United States

	Highway US 1	0.19 miles
	Interstate 540	12.5 miles
	Interstate 85	19.4 miles
	Interstate 87	22.0 miles
	Interstate 40	23.5 miles
	Interstate 95	39.0 miles

# AIRPORTS



- 1 Raleigh-Durham International 27 miles
- 2 Fayetteville Regional 90 miles
- 3 Piedmont Triad International 94 miles
- 4 Charlotte Douglas International 174 miles

# SEAPORTS



- 1 Wilmington, NC 150 miles
- 2 Morehead City, NC 161 miles
- 3 Norfolk, VA 165 miles
- 4 Charleston, SC 301 miles
- 5 Savannah, GA 344 miles
- 6 Jacksonville, FL 475 miles

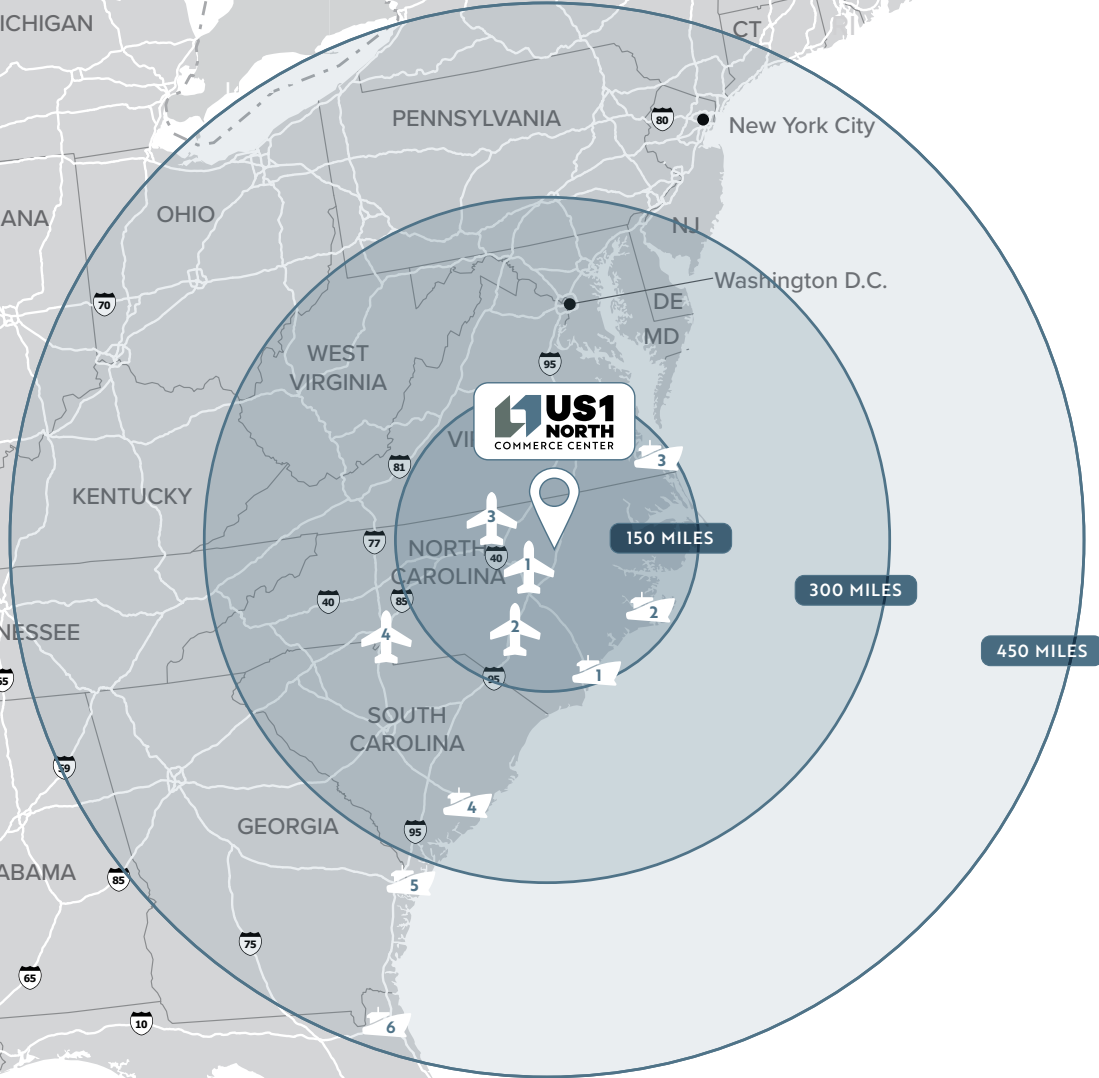

**MARIA LOMBARDI, MSRE**  
 Senior Associate  
 (919) 899-5087  
[maria.lombardi@foundrycommercial.com](mailto:maria.lombardi@foundrycommercial.com)

# LOCATION & ACCESS

**ALEXIS LAMBETH**

Principal  
alexis.lambeth@foundrycommercial.com  
(919) 524.3593

**JIM ALLAIRE**

Principal  
jim.allaire@foundrycommercial.com  
(919) 270-9216

**MARIA LOMBARDI, MSRE**

Senior Associate  
maria.lombardi@foundrycommercial.com  
(919) 899-5087

