

KEY PLAN

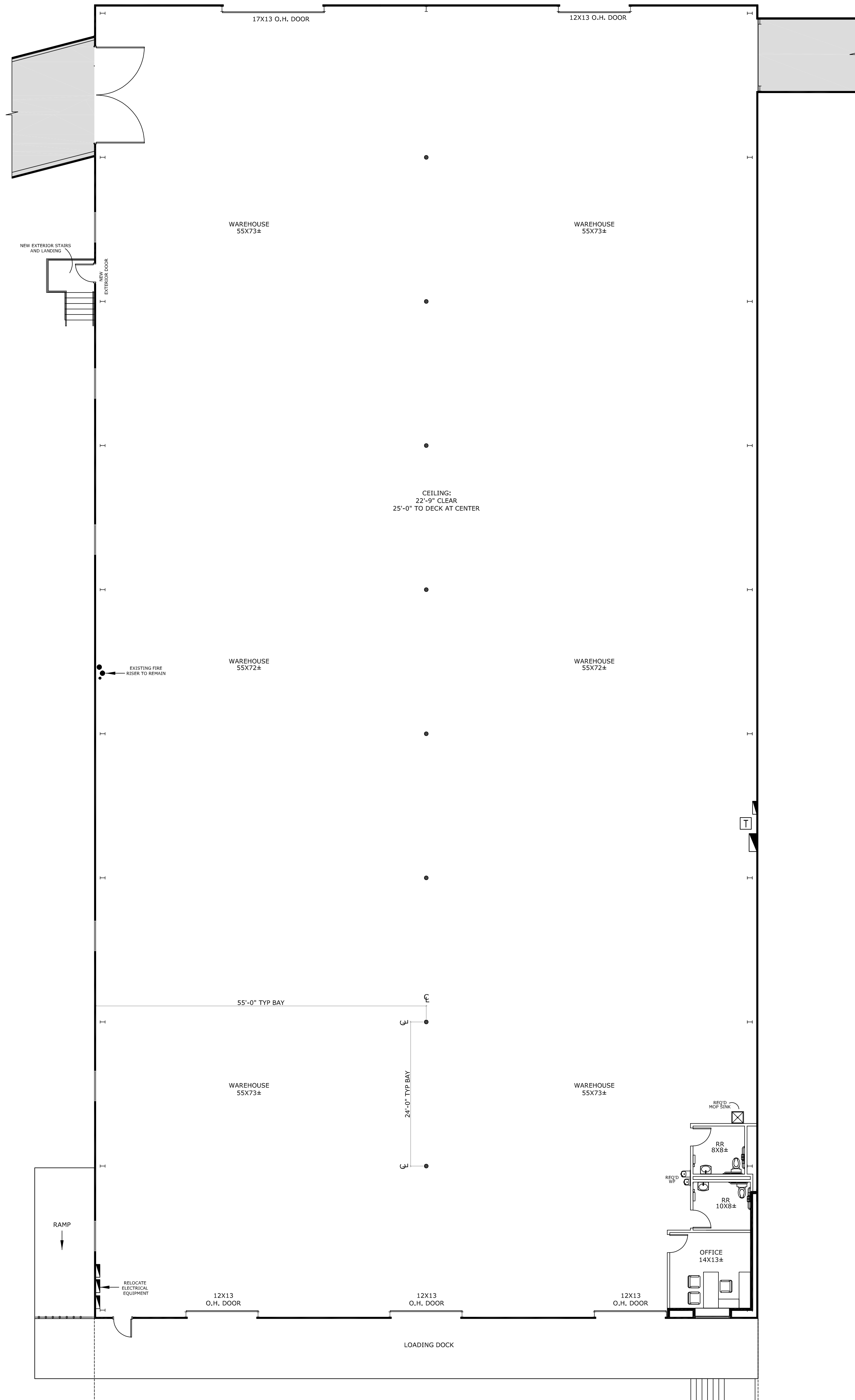

| WALL NOTES | |
|------------|--|
| BY SYMBOL | EXISTING BLD STD INTERIOR PARTITION TO REMAIN. |
| BY SYMBOL | NEW BLD STD INTERIOR PARTITION TO CEILING. |

PRELIMINARY PLAN NOT FOR REGULATORY APPROVAL, PERMITTING, OR CONSTRUCTION
 *SUITE HAS NOT BEEN FULLY FIELD VERIFIED FOR EXISTING CONDITIONS
 *ROOM SIZES ARE APPROXIMATE, AND ARE NOT INTENDED TO BE USED FOR FINAL DETERMINATION OF FURNITURE SIZES OR PLACEMENT.

| | |
|---------------|--|
| PROJECT #: | 3117.2259 |
| DATE | 09-20-24 |
| REVISED | 10-08-24 |
| OFFICE SF | 321 |
| WAREHOUSE SF | 23,860 |
| TOTAL SF | 24,181 |
| FILE LOCATION | Z:\Shared\JCI_Documents\DRAWINGS - MAIN\2605 RODNEY LANE\SP\BLDG 3 |

SPACE PLAN

DRAWN BY: MAR/NL
 SCALE: 3/32" = 1'-0"
 (ON 24 X 36" PAPER ONLY)

PROPOSED FACILITY FOR:
SPEC SUITE
 2605 RODNEY LANE - BUILDING 3
 2605 RODNEY LANE
 DALLAS, TEXAS 75229

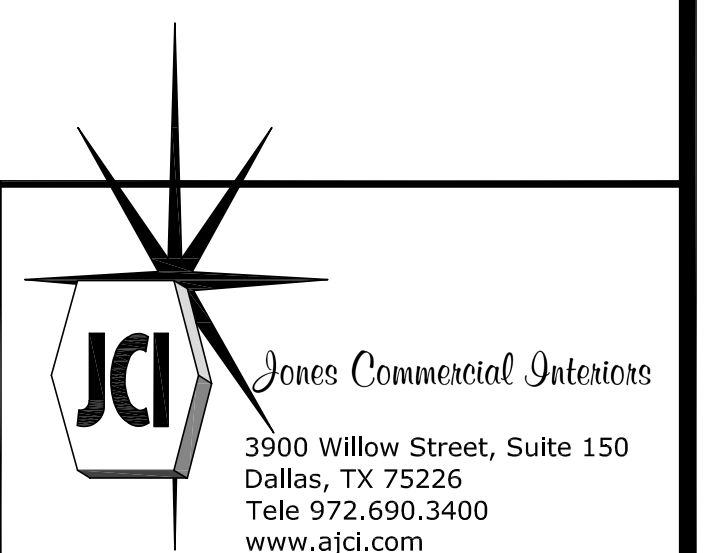

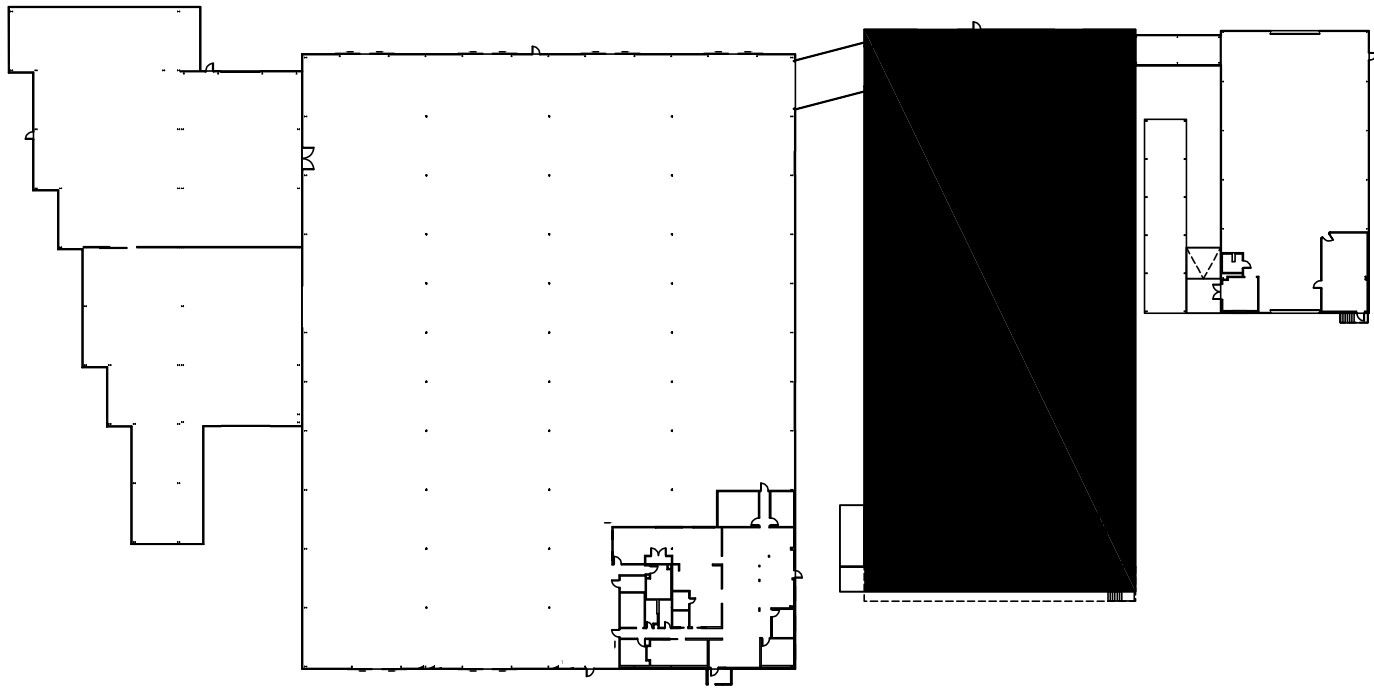

KEY PLAN

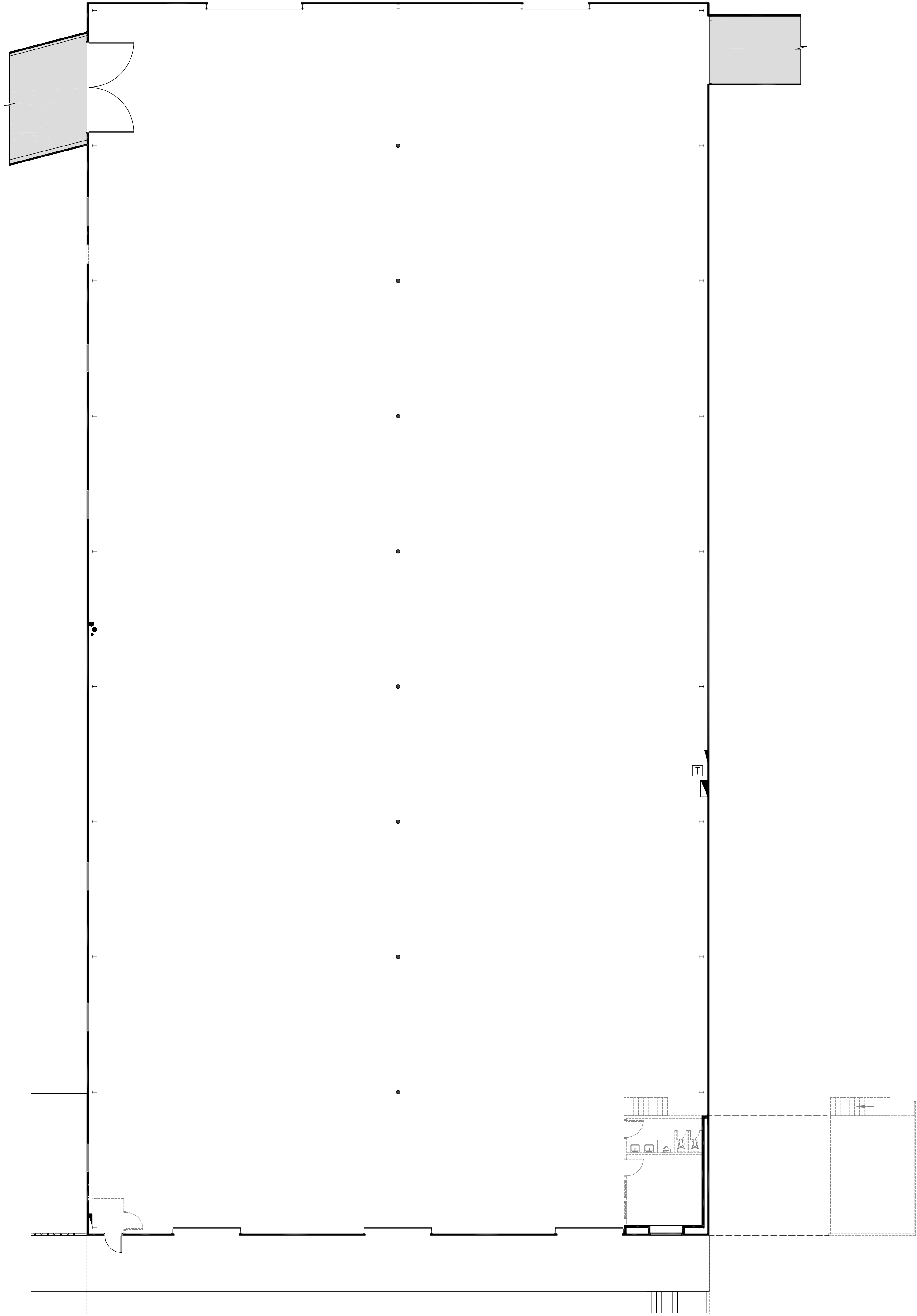

PRELIMINARY PLAN NOT FOR REGULATORY APPROVAL, PERMITTING, OR CONSTRUCTION
 *SUITE HAS NOT BEEN FULLY FIELD VERIFIED FOR EXISTING CONDITIONS
 *ROOM SIZES ARE APPROXIMATE, AND ARE NOT INTENDED TO BE USED FOR FINAL DETERMINATION OF FURNITURE SIZES OR PLACEMENT.

| | |
|---------------|--|
| PROJECT #: | 3117.2259 |
| DATE | 09-20-24 |
| REVISED | 10-08-24 |
| OFFICE SF | 321 |
| WAREHOUS SF | 23,860 |
| TOTAL SF | 24,181 |
| FILE LOCATION | Z:\Shared\JCI_Documents\DRAWINGS - MAIN\2605 RODNEY LANE\SP\BLDG 3 |

DEMO PLAN

DRAWN BY: MAR/NL
 SCALE: 3/32" = 1'-0"
 (ON 24 X 36" PAPER ONLY)

PROPOSED FACILITY FOR:
SPEC SUITE
 2605 RODNEY LANE - BUILDING 3
 2605 RODNEY LANE
 DALLAS, TEXAS 75229

