

FOR LEASE

Owned and Operated by



South 200th St Industrial Building

2301 South 200th St, SeaTac, WA 98198



±13,950 SF



**LEASING INFO
& CONTACT**

Kent Channing

(425) 586-5628 / kchanning@nai-psp.com

Arie Salomon

(425) 586-5636 / asalomon@nai-psp.com



This is not an offer or acceptance of an offer to lease space. A lease will only be offered or made in a written agreement signed by landlord. No representation or warranty of any kind is made by landlord unless set forth in a written definitive lease executed by the landlord.

OVERVIEW

13,950 SF
1,623 SF Office
8 DH doors & 1 GL door
16' Clear Height
Excellent access to I-5 & SR-509
Lease Rate: \$1.05 shell, \$1.25 office add on
NNN's: \$0.39
Available now

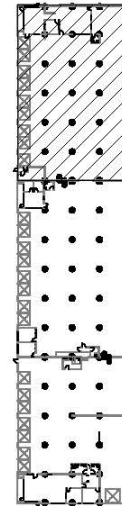
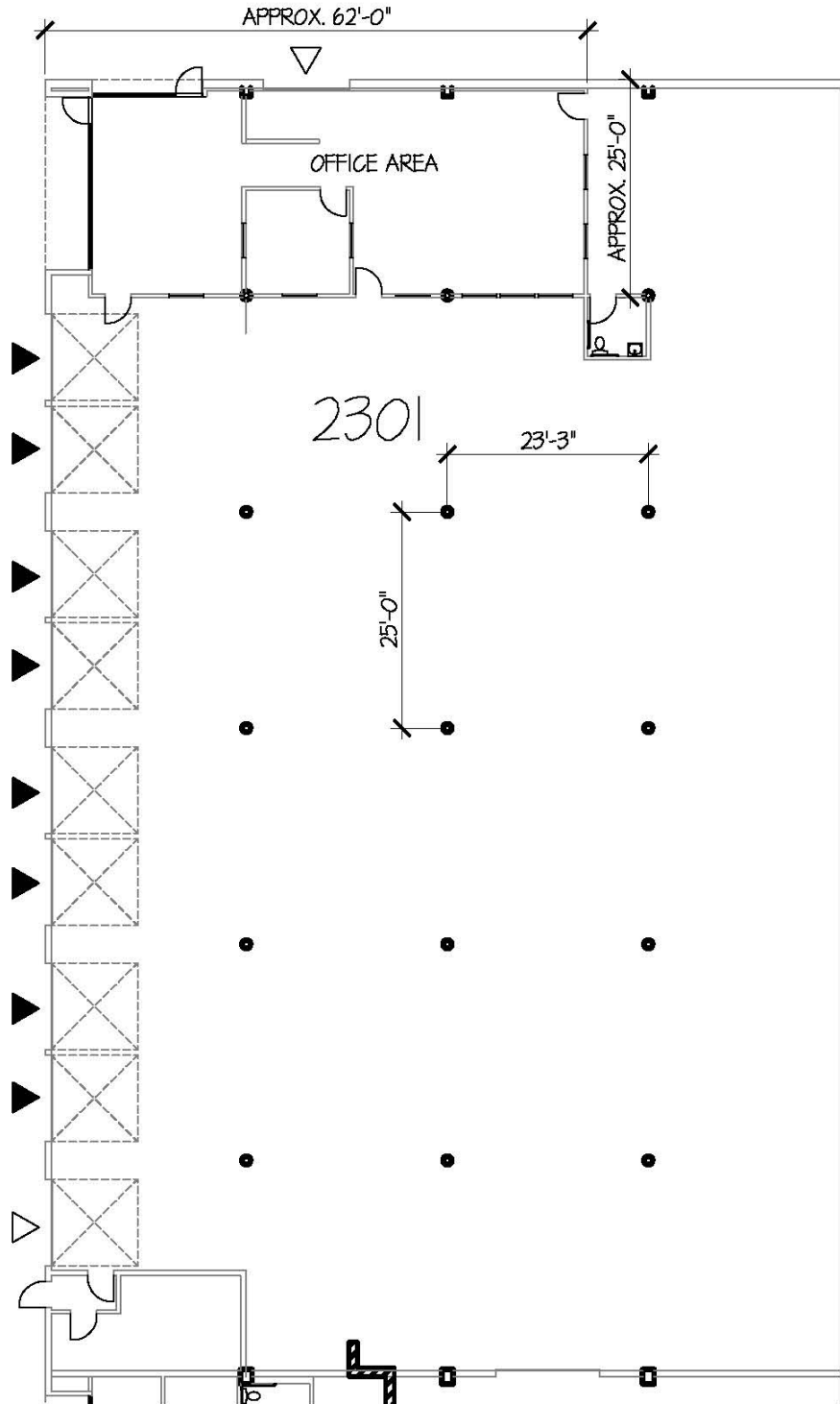

Key Plan LOWER LEVEL

- ▶ DOCK HIGH DOOR
- ▷ GRADE LEVEL DOOR