

621 INDENEER DRIVE

KERNERSVILLE, NC

+/-10,000 - 25,000 SF
with Secured Outdoor Storage

for
LEASE



Positioned in the heart of the Triad, 621 Indeneer Dr offers exceptional accessibility just off Highway 66 and minutes from I-40. Located adjacent to the South Park Business Center, the property benefits from a highly visible, professional business park setting with strong connectivity throughout the region.

Type	Flex/Industrial	Floor	6 In. Reinforced
Building SF	25,000 Sf	Power	Up to 2400 Amps 240 volts; 3 Phase Service
Site Size (Acres)	1.92 Acres	Loading Doors	1 Drive In + 1 Dock (optional)
Office Size	5,000 Sf	Sprinkler	Installed 1999
Devisable	Yes	Lighting	Hi-Bay Lights
Zoning	Gi-S	Water/Sewer	City Of W-S
Parking Spaces	45 + .25 AC Fenced Storage Yard	HVAC	Office & 10k SF Warehouse
Clear Height	16 Ft.		
Column Spacing	25 Ft. X 50 Ft.		

NAI Piedmont Triad
Commercial Real Estate Services, World Wide

BEN STURGILL
BROKER
(O) 336.358.3229
(C) 336.848.3046
bsturgill@naipt.com

348 N Elm Street | Greensboro, NC 27101 | naipt.com

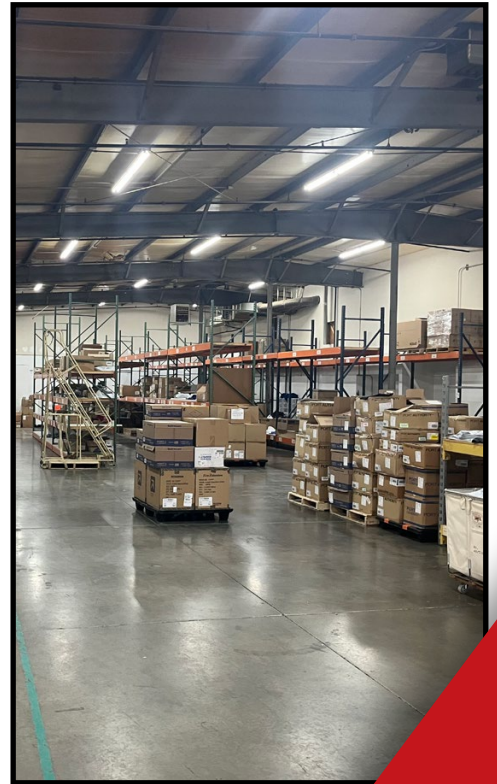
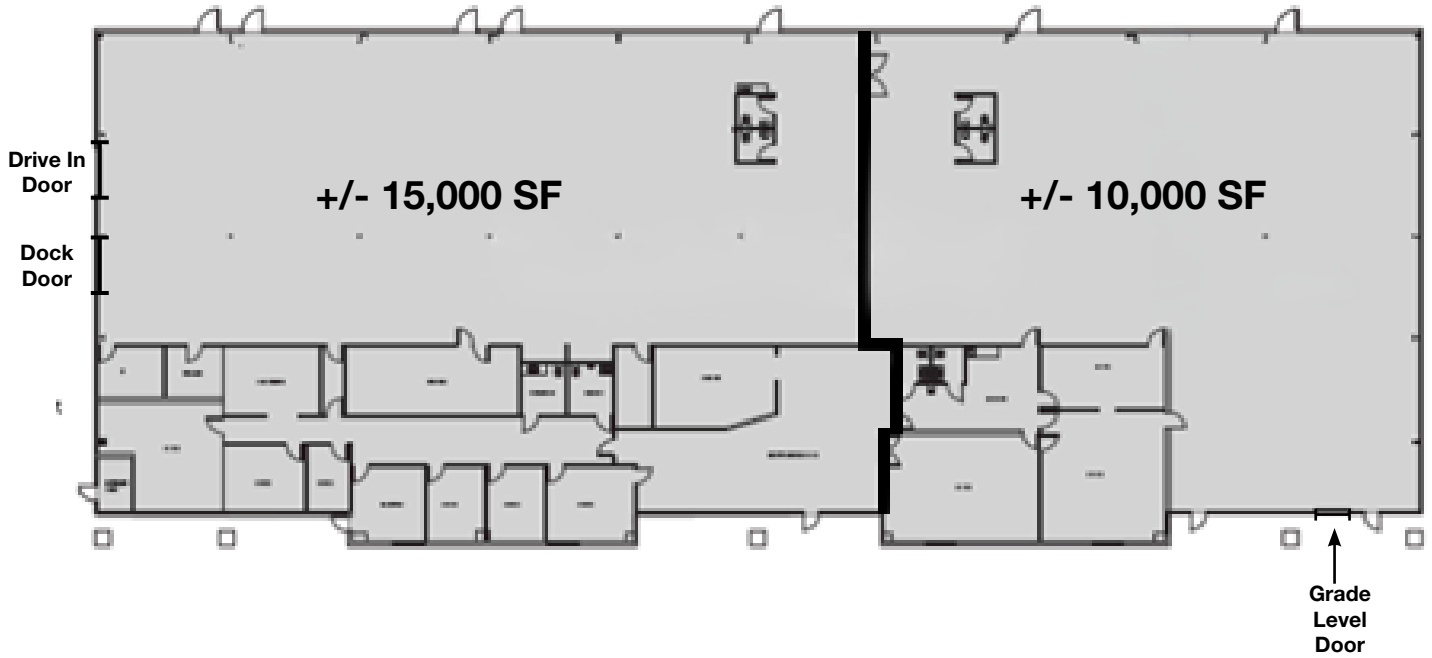

This material may contain content generated with AI assistance and publicly sourced data. NAI Piedmont Triad makes every effort to verify the information but makes no warranties or representations regarding the accuracy, completeness, or reliability of the information. Independent verification of all details is strongly encouraged. Prices, terms, and availability are subject to change without prior notice.

BEN STURGILL
BROKER
(O) 336.358.3229
(C) 336.848.3046
bsturgill@naipt.com

348 N Elm Street | Greensboro, NC 27101 | naipt.com

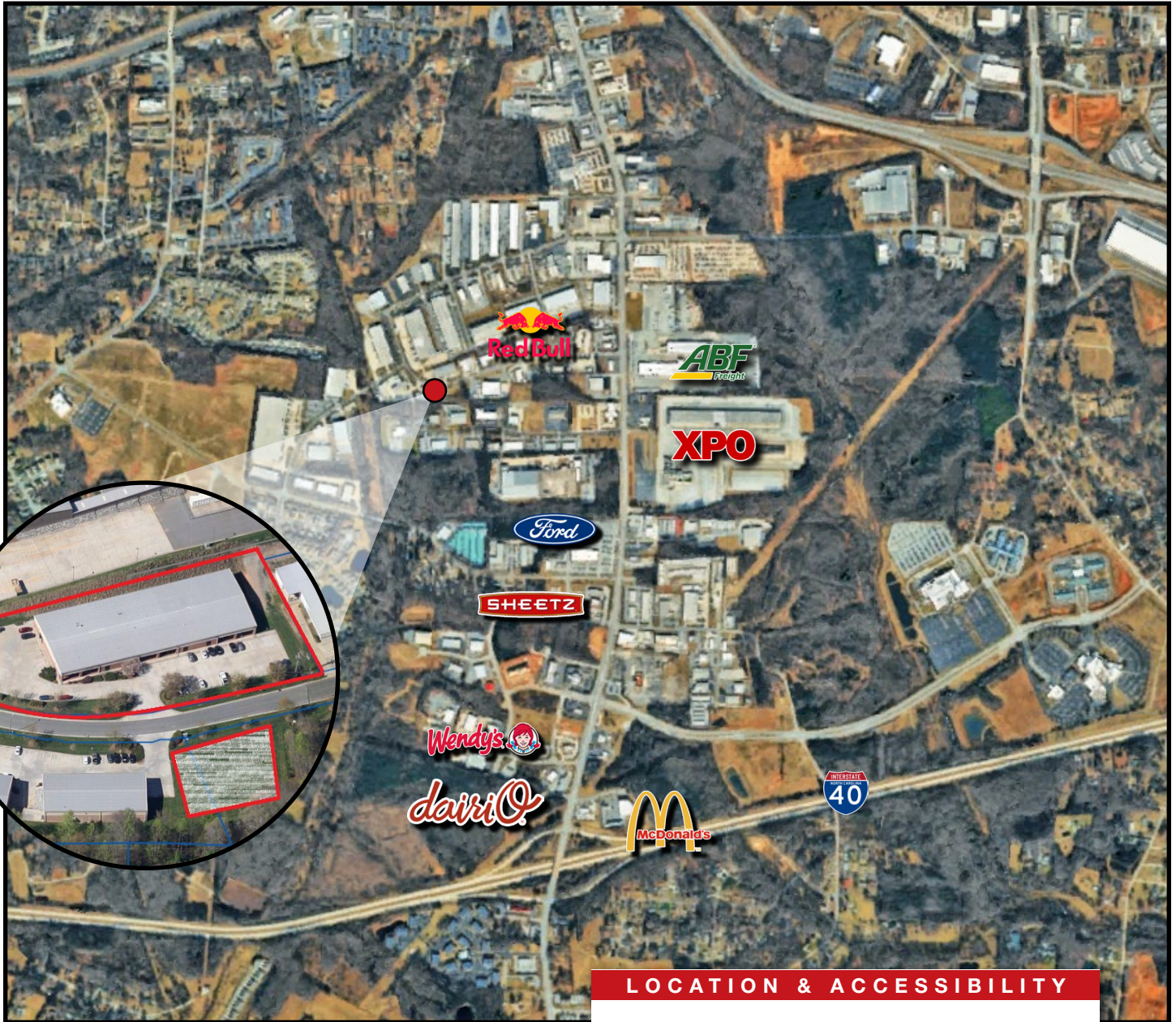

LOCATION & ACCESSIBILITY

PTI AIRPORT 12.7 MILES

 INTERSTATE 40 5.8 MILES

 INTERSTATE 85 30 MILES

This material may contain content generated with AI assistance and publicly sourced data. NAI Piedmont Triad makes every effort to verify the information but makes no warranties or representations regarding the accuracy, completeness, or reliability of the information. Independent verification of all details is strongly encouraged. Prices, terms, and availability are subject to change without prior notice.

BEN STURGILL
 BROKER
 (O) 336.358.3229
 (C) 336.848.3046
 bsturgill@naipt.com