

Available For Lease



NORTH PARK CORPORATE CENTER

17319 San Pedro Ave. | San Antonio, TX 78232



Accessibility.

Property has excellent drive-up accessibility.

Convenience.

Immediate access to Loop 1604 & Hwy 281.

4.65/1,000 SF

Ample wrap-around parking.



Highlights



Suites have elevated ceilings, premium window lines with an abundance of natural light



Greenspace with picnic table, walking path, and exterior meeting areas with WIFI



Wrap around parking with drive-up accessibility (4.65/1,000)



Pylon signage available



NORTH PARK CORPORATE CENTER

17319 San Pedro Ave. | San Antonio, TX 78232

281

Suite 500
18,148 SF

100%
Leased

Suite 410
7,742 SF

Bldg 3

Bldg 4

Bldg 5

NORTH PARK CORPORATE CENTER

What's Available

**100%
Leased**

Bldg 3

7,742 SF

Bldg 4

18,148 SF

Bldg 5

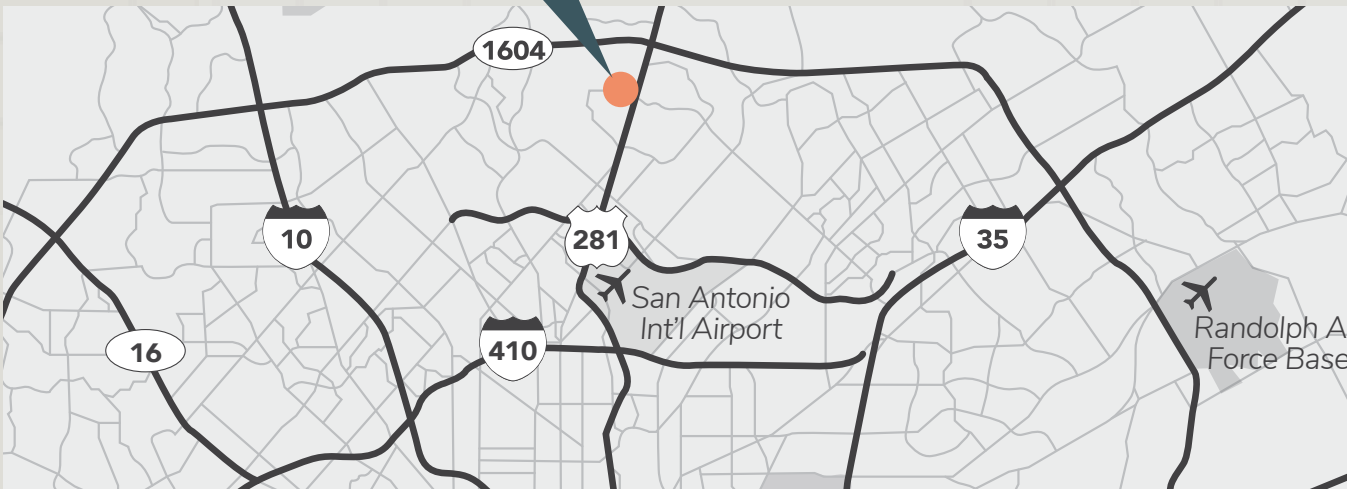

4

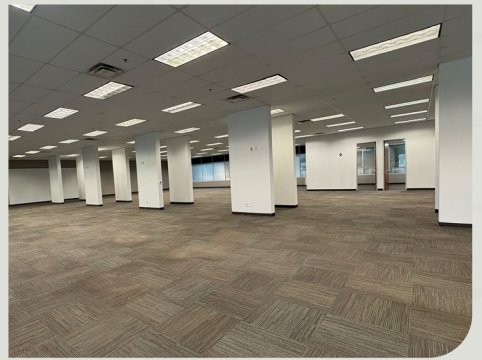

Take a Tour

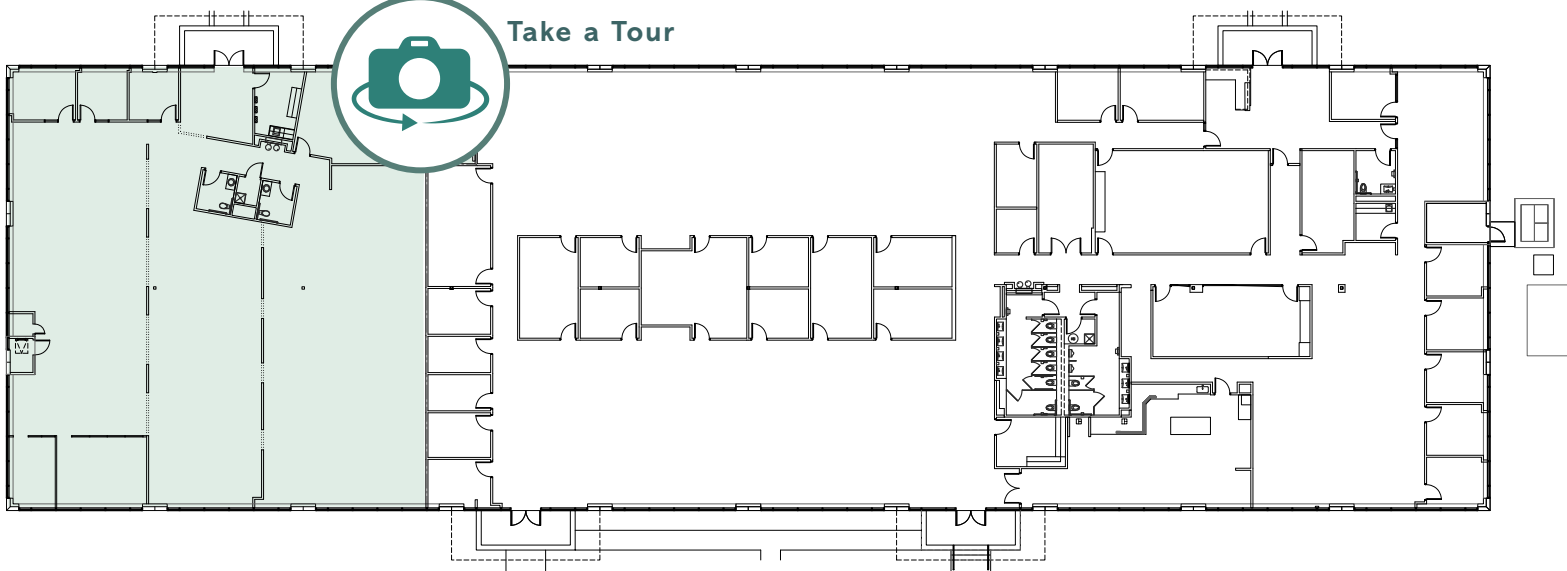

Suite 410: 7,742 SF Available

BUILDING



NORTH PARK CORPORATE CENTER

17319 San Pedro Ave. | San Antonio, TX 78232



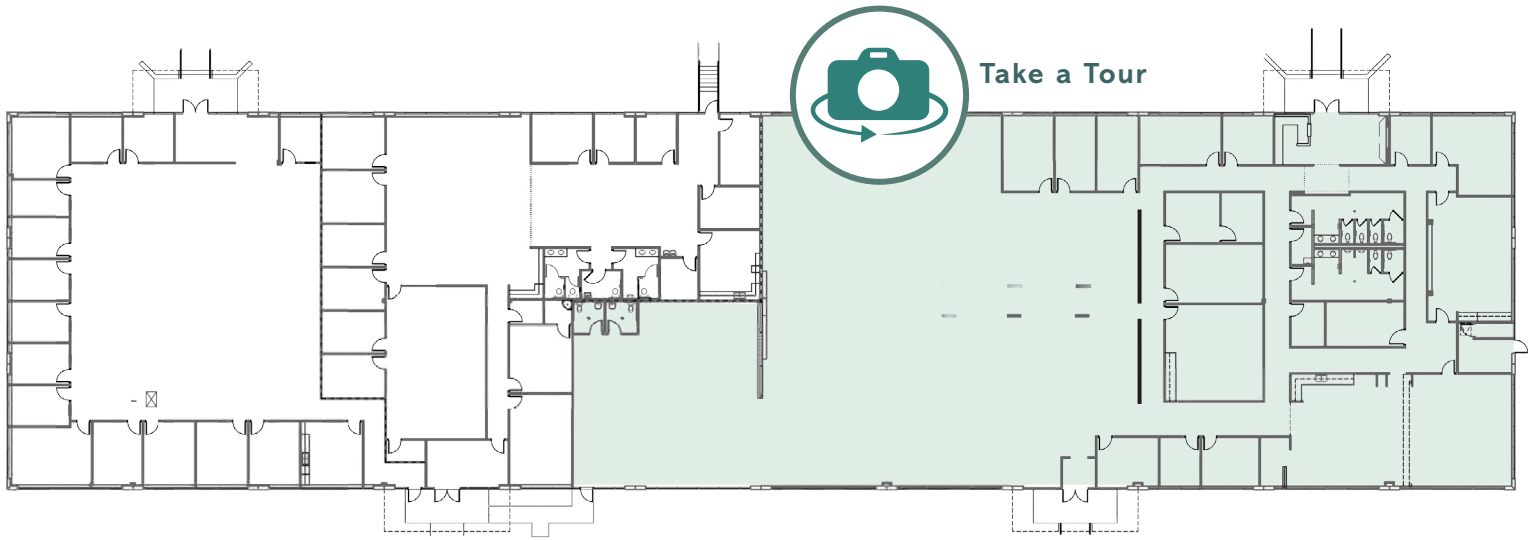

Suite 500: 18,148 SF Available



NORTH PARK CORPORATE CENTER

17319 San Pedro Ave. | San Antonio, TX 78232

BUILDING

5

Legend

- Medical Facilities
- Retail
- Banks
- Restaurants
- Grocery Stores

In the Neighborhood

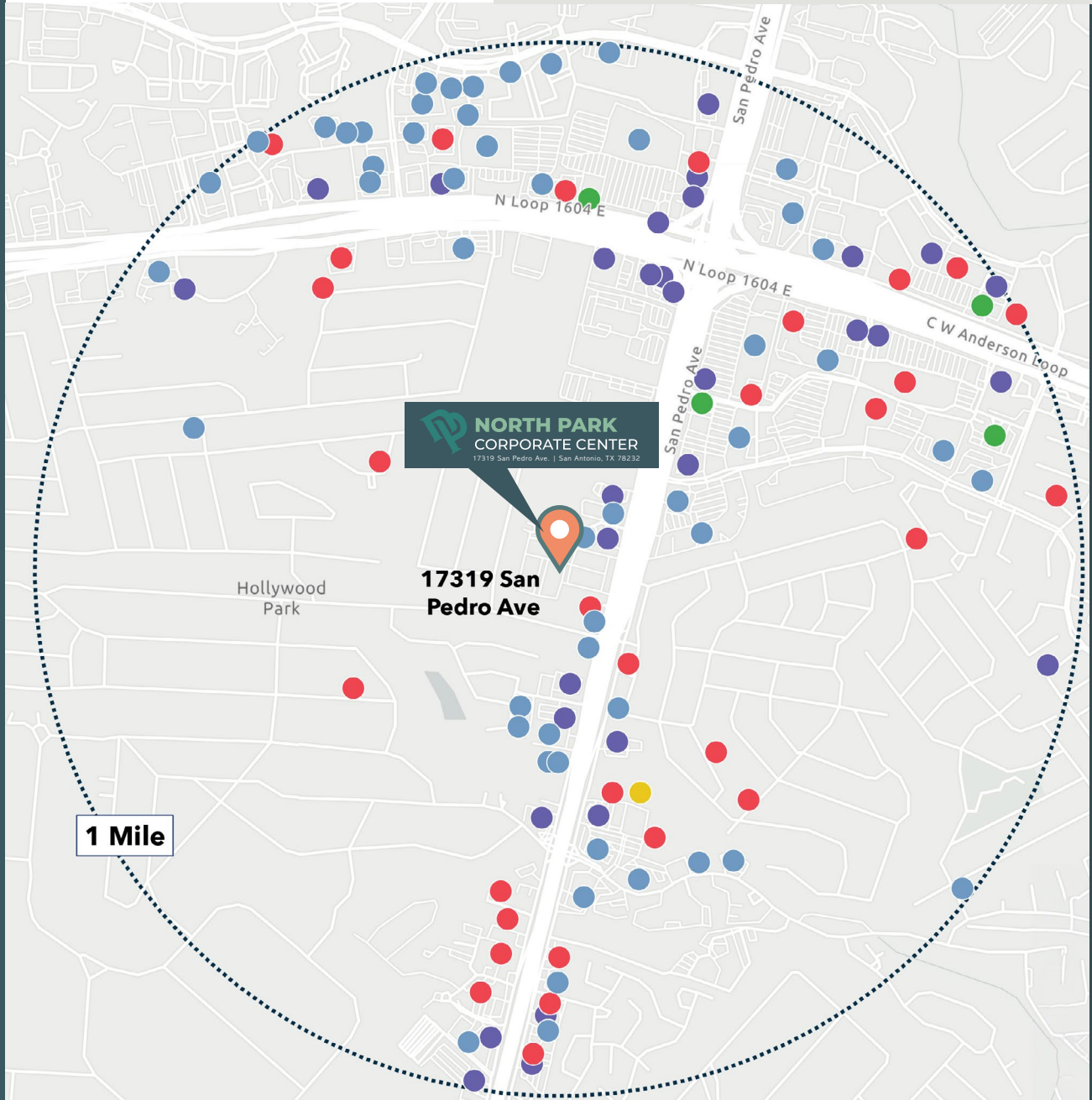

Drive Times

0
Minutes to Hwy 281

5
Minutes to Loop 1604

8
Minutes to Wurzbach Pkwy

11
Minutes to Loop 410

15
Minutes to IH-10

18
Minutes to IH-35



NORTH PARK CORPORATE CENTER

17319 San Pedro Ave. | San Antonio, TX 78232

Available
For
Lease



NORTH PARK CORPORATE CENTER

17319 San Pedro Ave. | San Antonio, TX 78232

Talaya Winton

Senior Associate

210.298.8559

talaya.winton@streamrealty.com

Garrett Carlson

Vice President

210.298.8515

garrett.carlson@streamrealty.com

**STREAM**[®]