

SITE TABULATION - PHASE 1

| | | |
|--------------------------------------|---------------------|--|
| ZONING: | O-1 OFFICE DISTRICT | |
| PARKING: | | |
| REQUIRED (GROSS AREA PER IBC): | | |
| MEDICAL OFFICE: 6,110 S.F. @ 1:150 = | 41 CARS | |
| GENERAL OFFICE: 5,034 S.F. @ 1:300 = | 17 CARS | |
| TOTAL: | 58 CARS | |
| PROVIDED: | 60 CARS | |

SITE TABULATION - PHASE 2

| | | |
|--------------------------------------|----------------------------|--|
| ZONING: | SP-1 (O-1 OFFICE DISTRICT) | |
| PARKING: | | |
| REQUIRED (GROSS AREA PER IBC): | | |
| MEDICAL OFFICE: 8,147 S.F. @ 1:150 = | 55 CARS | |
| GENERAL OFFICE: 2,997 S.F. @ 1:300 = | 10 CARS | |
| TOTAL: | 65 CARS | |
| PROVIDED: | 67 CARS | |

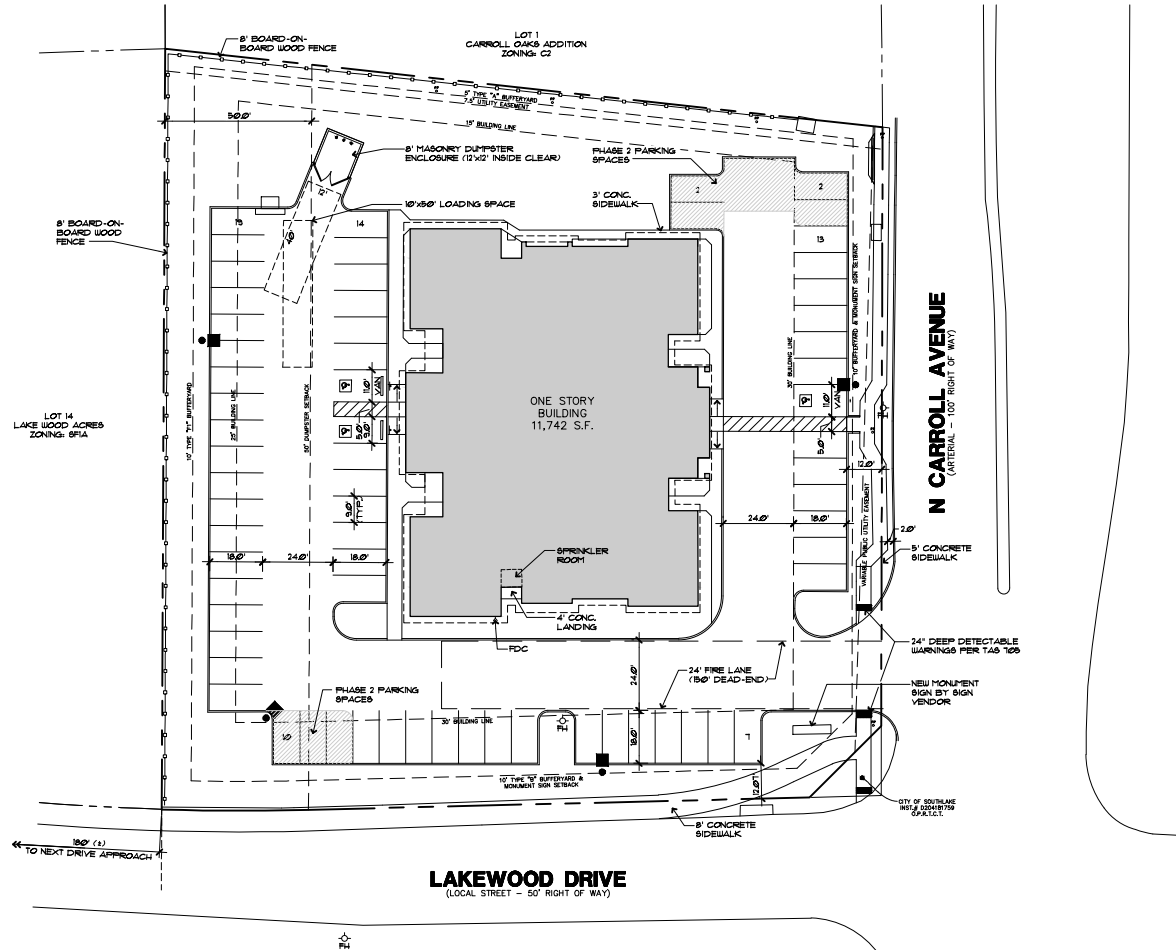

NOTE: THIS SITE PLAN REPRESENTS THE FINAL SITE CONFIGURATION PROVIDING ENOUGH PARKING TO SUPPORT ALL PROPOSED PHASES OF CONSTRUCTION FOR THE CURRENT AND FUTURE PROPOSED TENANT MIX.

1 SITE PLAN
 A101 SCALE: 1" = 20'-0"

**752 & 754
 N CARROLL
 AVE
 EXPANSION &
 ALTERATIONS**

**Southlake,
 Texas**



Daniels & Lovelady
 Architecture
 669 Airport Freeway, Suite 101
 Hurst, Texas 76053
 Phone: 817-510-6730
 www.DLArchitecture.net

Brent S. Lovelady



Job Number: 20042
 Issue Date: 9-10-2020
 Revisions:

© 2020 Daniels & Lovelady Architecture

Sheet: **A101**