

1 Wexford Road, Brampton, Unit 8

PRIME RETAIL SPACE FOR LEASE



VALUE INSIGHT
REALTY
REAL ESTATE ADVISORY GROUP

valueinsightrealty.com

1 Wexford Road, Unit 8 Brampton



PROPERTY HIGHLIGHTS

- Very busy plaza on Hurontario Street north of Bovaird Drive
- Formerly occupied by a physio centre
- Space is in great condition
- Join retailers such as Service Ontario, Domino's Pizza, D-Spot, medical clinic, Hasty Market, pharmacy, dentist, cannabis and many more
- Suggested uses include: medical (non-conflicting), physio centre, store, optical store, education, financial, take-out restaurant, QSR or any other retail

PROPERTY DETAILS

Type:	For Lease
Unit:	8
Size:	2,101 sq.ft.
Net rent:	\$48/sq.ft.
TMI:	\$15.50/sq.ft.
Availability:	Immediate



1 Wexford Road, Unit 8 Brampton

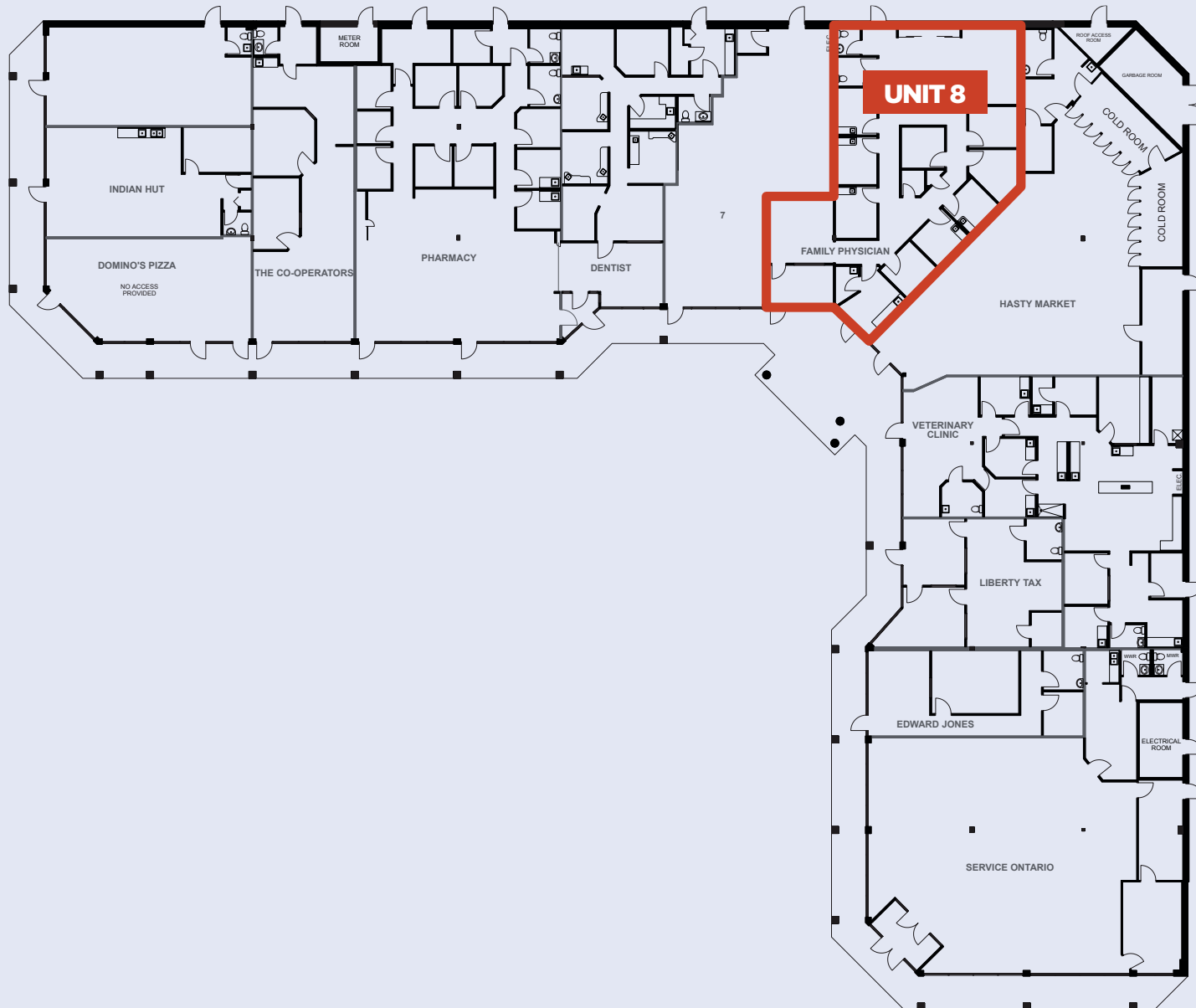

1 Wexford Road, Unit 8 Brampton

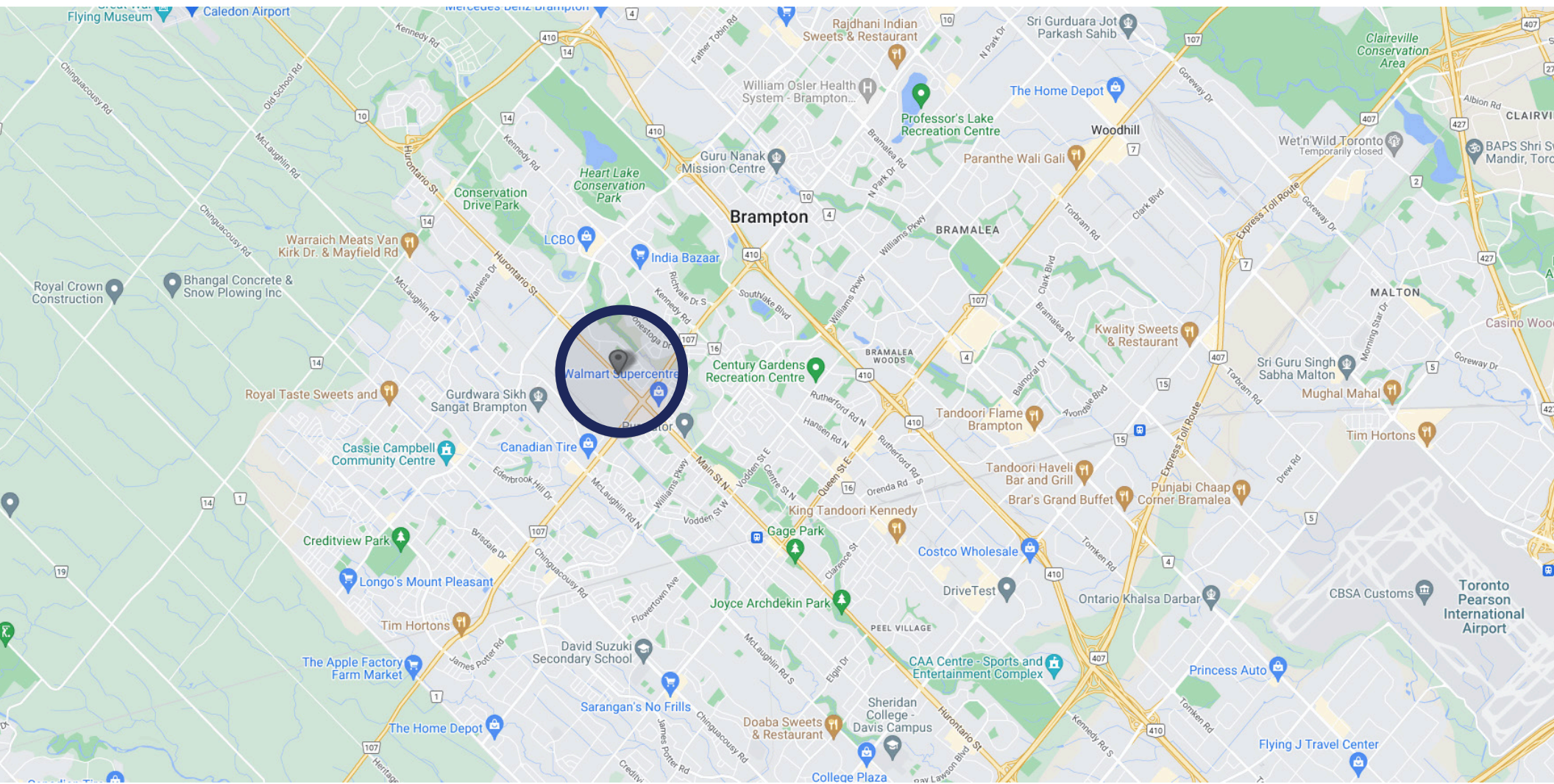

AREA DEMOGRAPHICS

Within 1 km radius of property



POPULATION
8,602



AVERAGE INCOME
\$114,243*

** Annually per household*



MEDIAN AGE
37.0

**LANDLORD &
DEVELOPER | SERVICES:**

DANIEL KERSHEN**

Senior Vice President

416.269.6747 x 102

daniel.kershen@valueinsightrealty.com

SARI SAMARAH*

President & CEO

416.269.6747 x 101

sari.samarah@valueinsightrealty.com

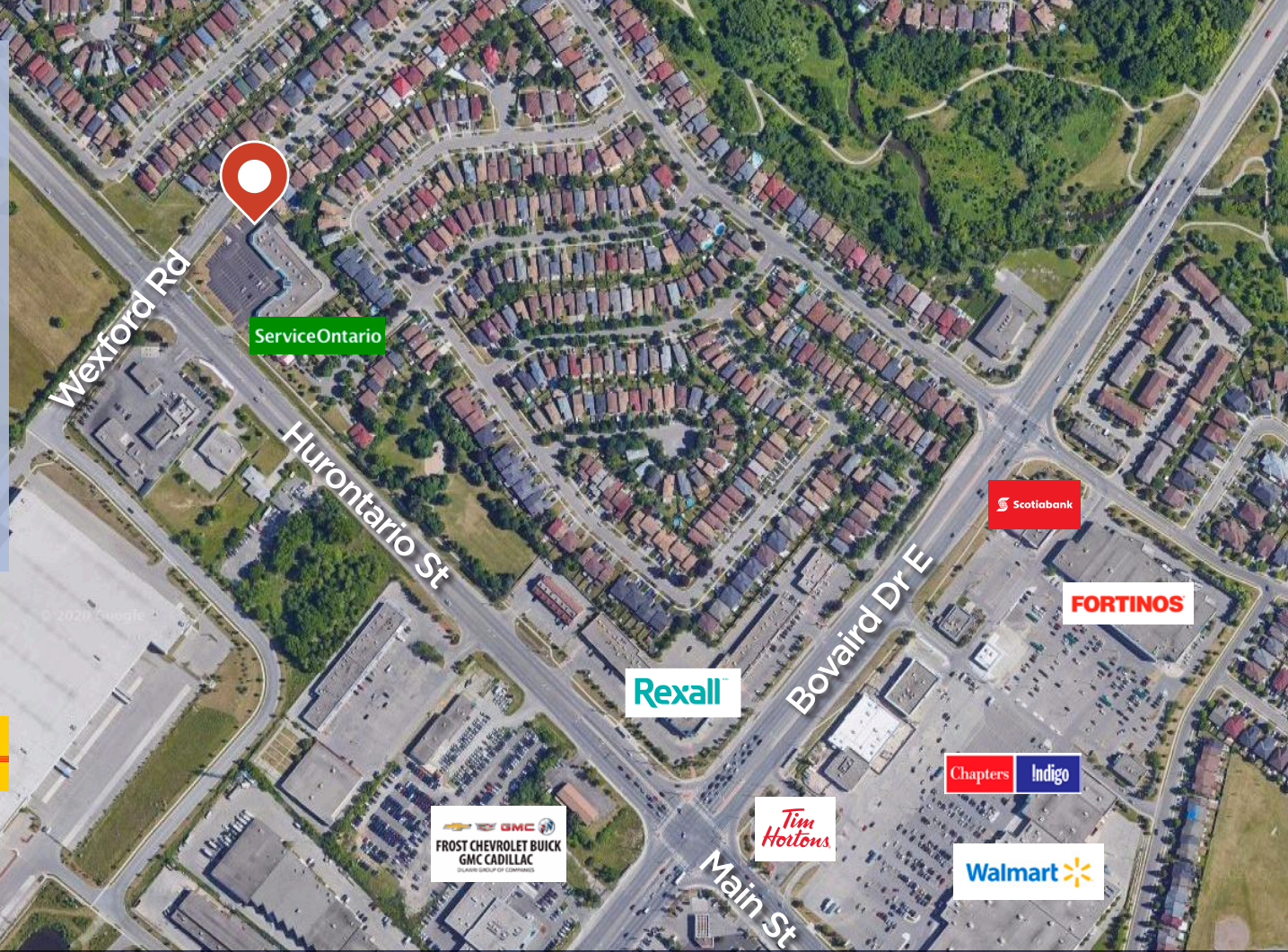

valueinsightrealty.com

© 2025 Value Insight Realty Inc. | Brokerage

No warranty or representation, expressed or implied, is made as to the accuracy of the information contained herein, and same is submitted subject to errors, omissions, change of price, rental or other conditions, withdrawal without notice, and to any specific listing condition, imposed by the property owner(s). *Broker of Record | **Sales Representative