

# FOR SUBLEASE

## 7725 CONNECT

7725 W RENO AVENUE  
OKLAHOMA CITY, OK 73127

± 24,988 - 185,228 SF

SCAN ME



### AVAILABLE SPACE

- **BUILDING 30:** ± 129,684 SF
  - Suite 370: ± 53,171 SF
  - Suite 380: ± 51,525 SF
  - Suite 385: ± 24,988 SF
- **BUILDING 20:** ± 55,544 SF
  - Suite 230: ± 27,772 SF
  - Suite 250: ± 27,772 SF
- **TOTAL AVAILABLE:** ± 185,228 SF
- **LEASE RATE:** \$20.00 FSG
- **Sublease Term:** Expires 5/31/2029



CONTACT  
US

TRAVIS MASON  
+1 405 297 9924  
tmason@commercialoklahoma.com

MICAH SHERMAN, CCIM  
+1 405 516 5088  
msherman@commercialoklahoma.com

VIVENNE VOGLER  
+1 405 754 5405  
vvogler@commercialoklahoma.com

204 N Robinson Ave, Ste 2000  
Oklahoma City, OK 73102  
+ 1 405 563 5000 | [commercialoklahoma.com](http://commercialoklahoma.com)

# 7725 CONNECT

7725 W RENO AVENUE  
OKLAHOMA CITY, OK 73127

## FOR SUBLEASE

± 24,988 - 185,228 SF



### PROPERTY HIGHLIGHTS

- YEAR BUILT: 1997
- FLOORS: 3
- PARKING: Ample  
*Free Surface*
- On-site gym, cafe and bank
- Located directly across from OKC Outlets on Reno Avenue west of Council Rd

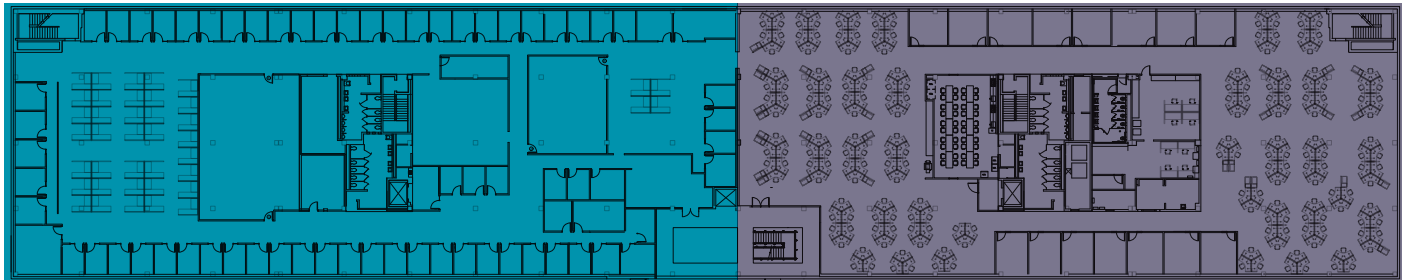

STE 230  
± 27,772 SF

STE 250  
± 27,772 SF

# 7725 CONNECT

7725 W RENO AVENUE  
OKLAHOMA CITY, OK 73127

## FOR SUBLEASE

± 24,988 - 185,228 SF



**STE 370**  
± 53,171 SF

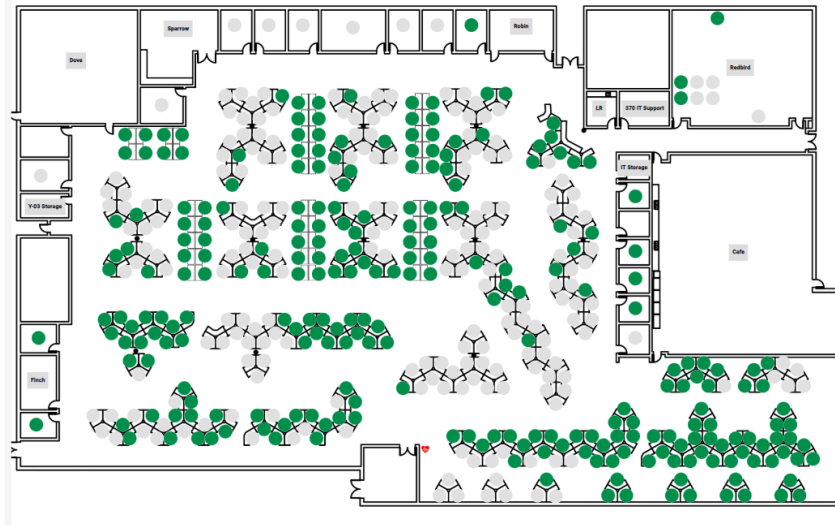

**STE 380**  
± 51,525 SF



**STE 385**  
± 24,988 SF

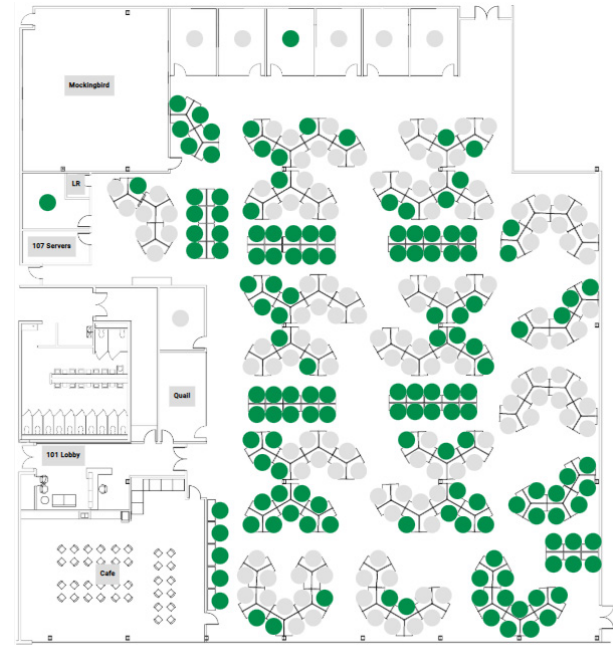

**TRAVIS MASON**  
+1 405 297 9924  
tmason@commercialoklahoma.com

**MICAH SHERMAN**  
+1 405 516 5088  
msherman@commercialoklahoma.com

**VIVENNE VOGLER**  
+1 405 754 5405  
vvogler@commercialoklahoma.com