



FOR LEASE

Downtown Flex Space

1325 W 7th Avenue
Eugene OR 97402

DETAILS

- Approximately 2,025 square feet on Polk Street and West 7th Avenue
- Accessed from Polk Street
- Open concept space with break room and private restroom
- On-site parking
- \$2,250 per month, modified gross

**Evans
Elder
Brown &
Seubert**

COMMERCIAL REAL ESTATE

CONTACT

Lilly Storment

lilly@eebcre.com

Stephanie Seubert

stephanie@eebcre.com

Jackson Seubert

jackson@eebcre.com

541.345.4860

Licensed in the State of Oregon.

Floor Plan

1325 West 7th Avenue | Eugene OR 97402

Evans
Elder
Brown &
Seubert

COMMERCIAL REAL ESTATE

CONTACT

**Lilly
Storment**

lilly@eebcre.com

**Stephanie
Seubert**

stephanie@eebcre.com

**Jackson
Seubert**

jackson@eebcre.com

541.345.4860

101 East Broadway
Suite #101
Eugene, OR 97401

Licensed in the
State of Oregon.

APPROXIMATELY 2,025 SQUARE FEET

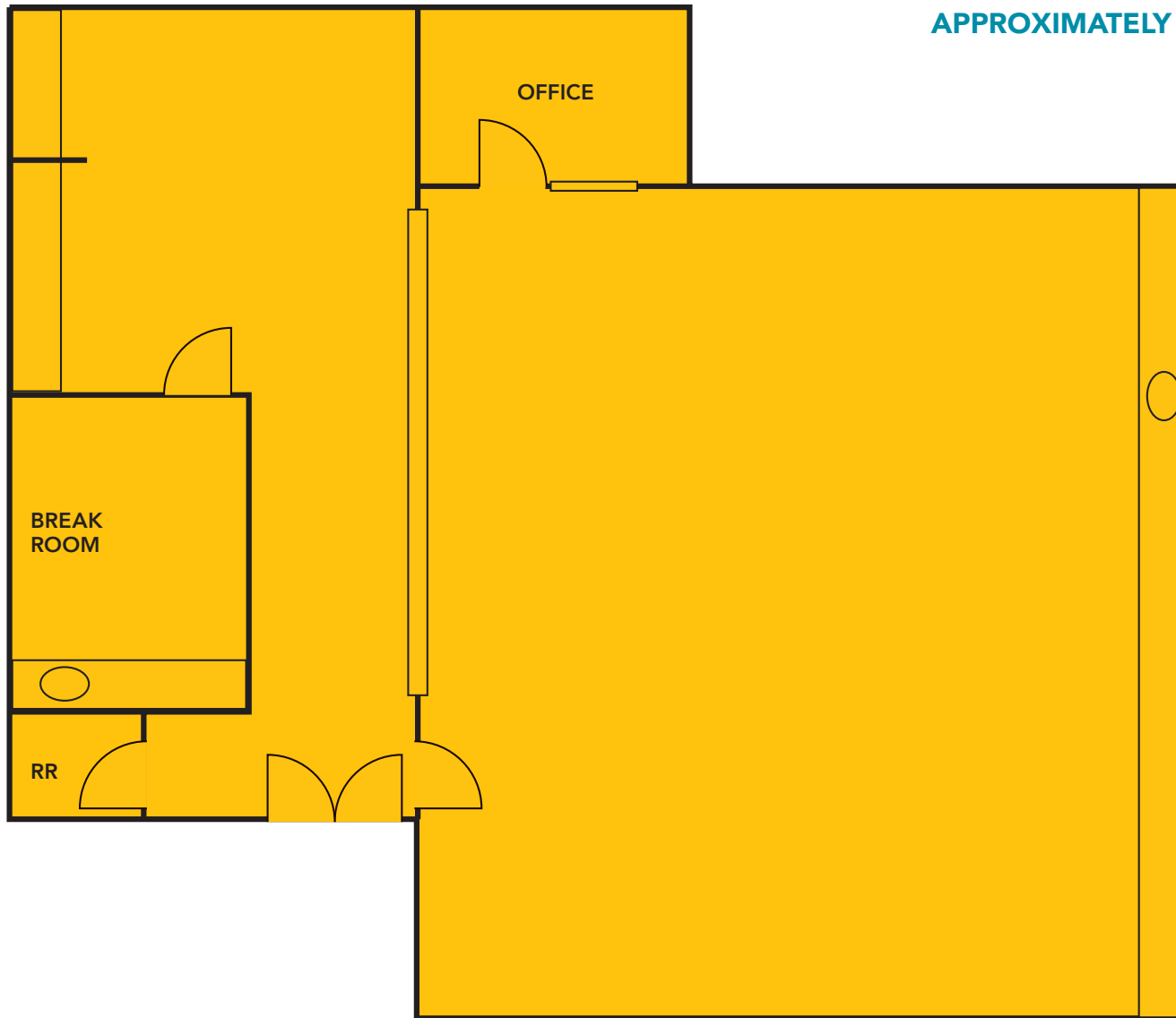

Photographs

1325 West 7th Avenue | Eugene OR 97402

Evans
Elder
Brown &
Seubert

COMMERCIAL REAL ESTATE

CONTACT

541.345.4860

101 East Broadway
Suite #101
Eugene, OR 97401

Licensed in the
State of Oregon.



The information in this package was gathered from sources deemed reliable, however Evans Elder Brown & Seubert makes no representation or warranty of the accuracy of the information. Any buyer or tenant considering a purchase or lease of this property should confirm any and all information relied upon in making the decision to purchase or lease prior to finalizing the transaction and bears the risk of all inaccuracies.

Location

1325 West 7th Avenue | Eugene OR 97402

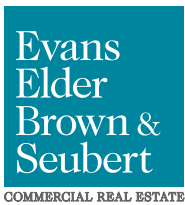
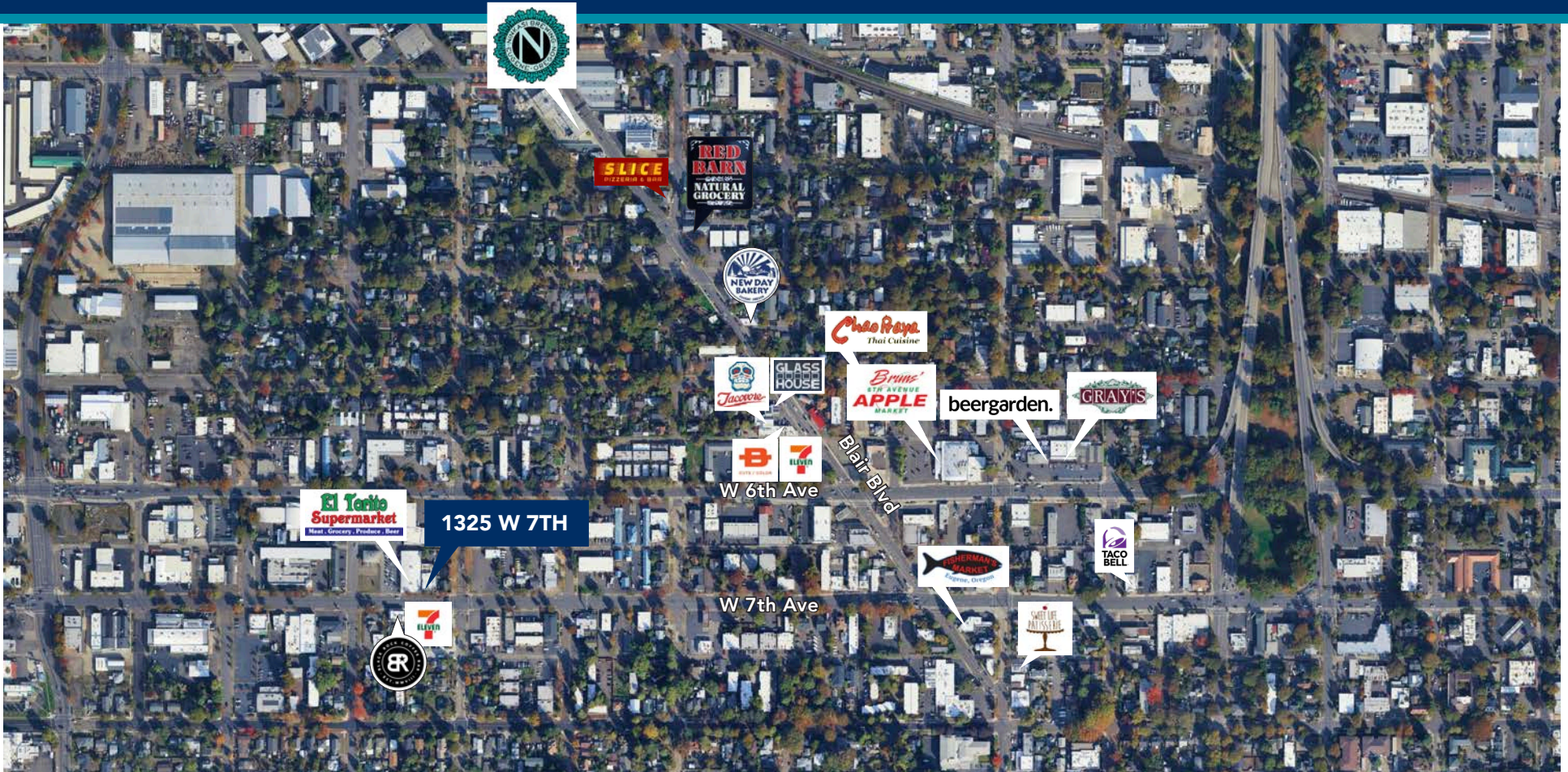

CONTACT

541.345.4860

Lilly Storment
lilly@eebcre.com

Stephanie Seubert
stephanie@eebcre.com

Jackson Seubert
jackson@eebcre.com