

FOR LEASE

433 SE Baseline Street, Hillsboro, Oregon 97123



PROPERTY DESCRIPTION

433 SE Baseline Street offers a rare opportunity to lease professional medical/dental office space in the heart of Hillsboro with excellent accessibility and strong visibility. This well-maintained property features a modern exterior, convenient on-site parking, and flexible layout potential ideal for service-oriented users. Located just minutes from OHSU - Tuality-Hillsboro Medical Center, Downtown Hillsboro, major arterials, and public transit, the property provides easy access for both clients and employees while positioning your business within one of Washington County's fastest-growing commercial corridors.

PROPERTY HIGHLIGHTS

- Well maintained building
- Ample on-site parking
- Strong visibility and signage opportunity

OFFERING SUMMARY

Lease Rate:	\$25.00/RSF/YR, NNN
Available SF:	2,793 +/-
Lot Size:	9,583 +/-

DEMOGRAPHICS	1 MILE	3 MILES	5 MILES
Total Households:	6,058	15,181	22,504
Total Population:	18,447	45,315	67,028
Average HH Income:	\$108,204	\$120,881	\$126,698

ADAM BEAN

President
Licensed in Oregon
C: 503.887.5100
O: 503.222.5100
adambean@dougbean.com

Doug Bean & Associates, Inc. | 1200 NW Naito Parkway #180 | Portland, OR 97209

DOUGBEAN.COM

Information contained herein has been obtained from others and is considered to be reliable. However, a prospective purchaser or lessee is expected to verify all information to their own satisfaction



Additional Photos

433 SE Baseline Street, Hillsboro, Oregon 97123



Lease Spaces

433 SE Baseline Street, Hillsboro, Oregon 97123



LEASE INFORMATION

Lease Type:	NNN	Lease Term:	Negotiable
Total Space:	2,793 RSF	Lease Rate:	\$25.00 RSF/YR

ADAM BEAN

President
Licensed in Oregon
C: 503.887.5100
O: 503.222.5100
adambean@dougbean.com

Doug Bean & Associates, Inc. | 1200 NW Naito Parkway #180 | Portland, OR 97209

DOUGBEAN.COM

Information contained herein has been obtained from others and is considered to be reliable. However, a prospective purchaser or lessee is expected to verify all information to their own satisfaction



Suite Plan: 2,793 SF (+/-)

433 SE Baseline Street, Hillsboro, Oregon 97123

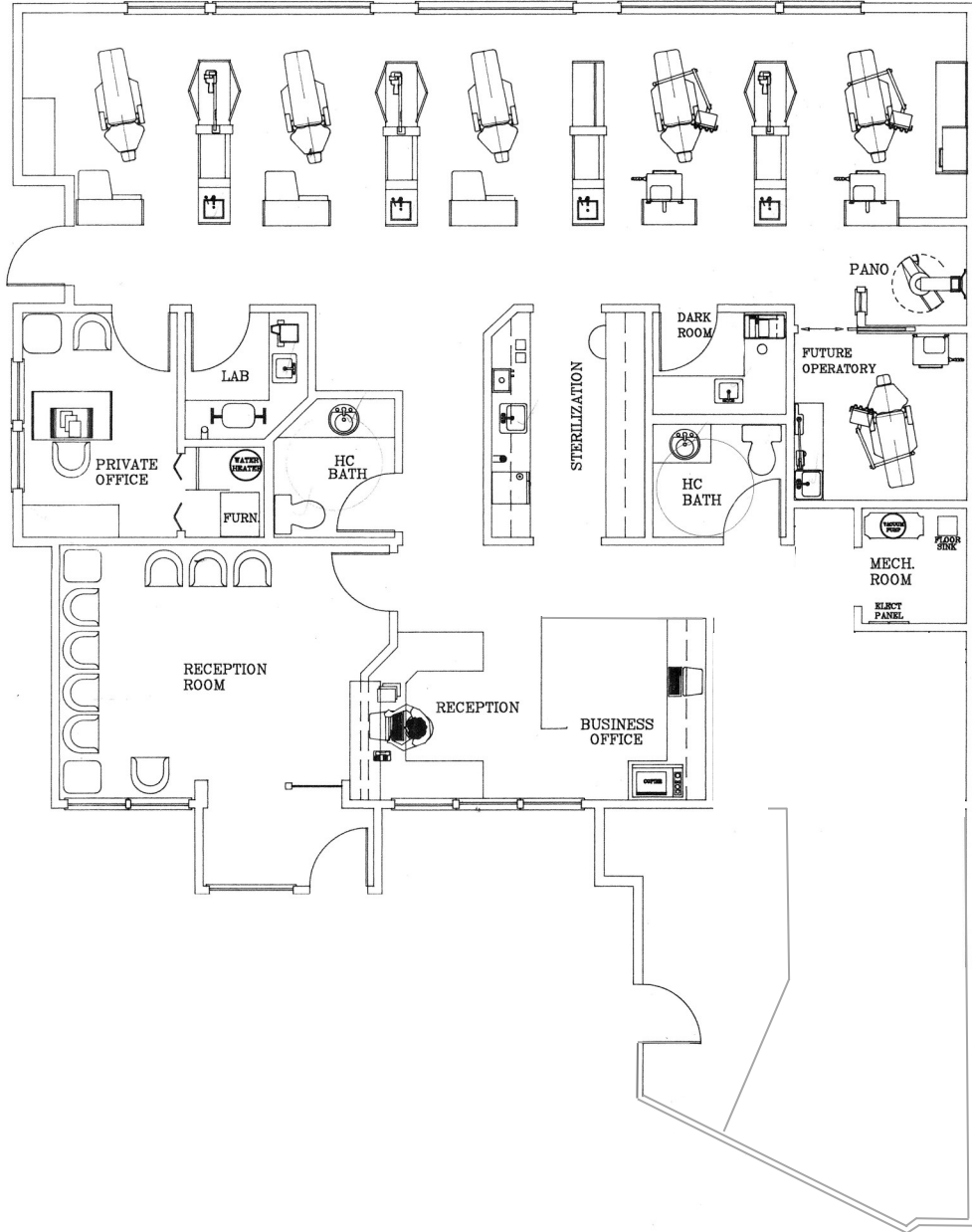

ADAM BEAN

President
Licensed in Oregon
C: 503.887.5100
O: 503.222.5100
adambean@dougbean.com

Doug Bean & Associates, Inc. | 1200 NW Naito Parkway #180 | Portland, OR 97209

DOUGBEAN.COM

Information contained herein has been obtained from others and is considered to be reliable. However, a prospective purchaser or lessee is expected to verify all information to their own satisfaction



Map

433 SE Baseline Street, Hillsboro, Oregon 97123



ADAM BEAN

President

Licensed in Oregon

C: 503.887.5100

O: 503.222.5100

adambean@dougbean.com

Doug Bean & Associates, Inc. | 1200 NW Naito Parkway #180 | Portland, OR 97209

DOUGBEAN.COM

Information contained herein has been obtained from others and is considered to be reliable. However, a prospective purchaser or lessee is expected to verify all information to their own satisfaction

