

# Retail Space Available

**Waite Park, MN**



**Sam Johnson**

Commercial Broker

C: 320-420-1177

E: [sam@parcel.properties](mailto:sam@parcel.properties)

**Tanner Nordlund**

Commercial Agent

C: 320-828-0395

E: [tanner@parcel.properties](mailto:tanner@parcel.properties)

# Summary



## Property Summary:

Property Type: Retail, Office

Building: Stone, stucco

Parking: 100+ onsite parking spots

Zoning: B3 - 2<sup>nd</sup> St S Commercial

## Outline:

Parcel Real Estate is pleased to provide the following leasing information for this 2,124sf unit at 171 7<sup>th</sup> Ave S, Waite Park.

Lease Rate: \$14 psf

Type: NNN

Term: Negotiable

CAM: \$5 psf

Feel free to reach out with any questions!

## ADDRESS:

171 7<sup>th</sup> Ave S  
Waite Park, MN

## USE:

Retail, office

## CONTACT:

### Sam Johnson

sam@parcel.properties  
320-420-1177  
parcel.properties

### Tanner Nordlund

tanner@parcel.properties  
320-420-1177  
parcel.properties

**Parcel**  
REAL ESTATE

# Available space



INH Retail Center- space highlighted in yellow is vacant- total 2124 st ft.

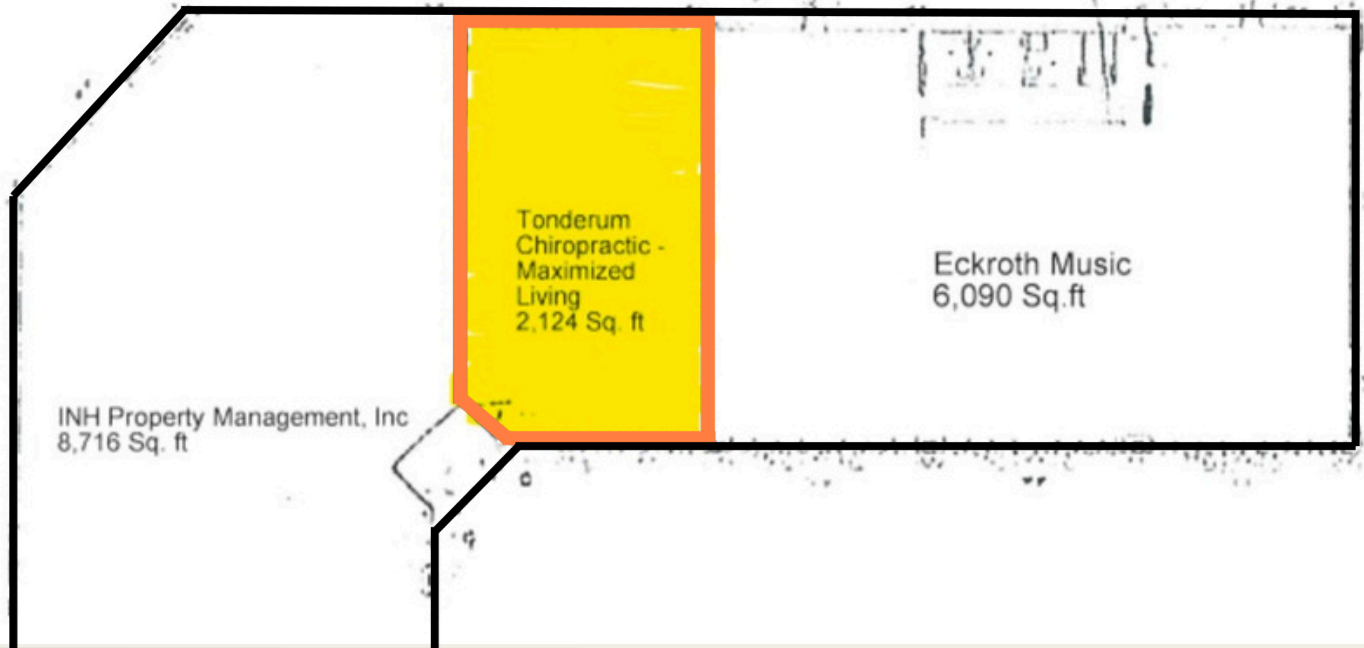

**SAM JOHNSON**  
BROKER, OWNER

## CONTACT

 320-420-1177

 sam@parcel.properties

 parcel.properties



**TANNER NORDLUND**  
Commercial Agent

## CONTACT

 320-828-0395

 tanner@parcel.properties

 parcel.properties

# Location

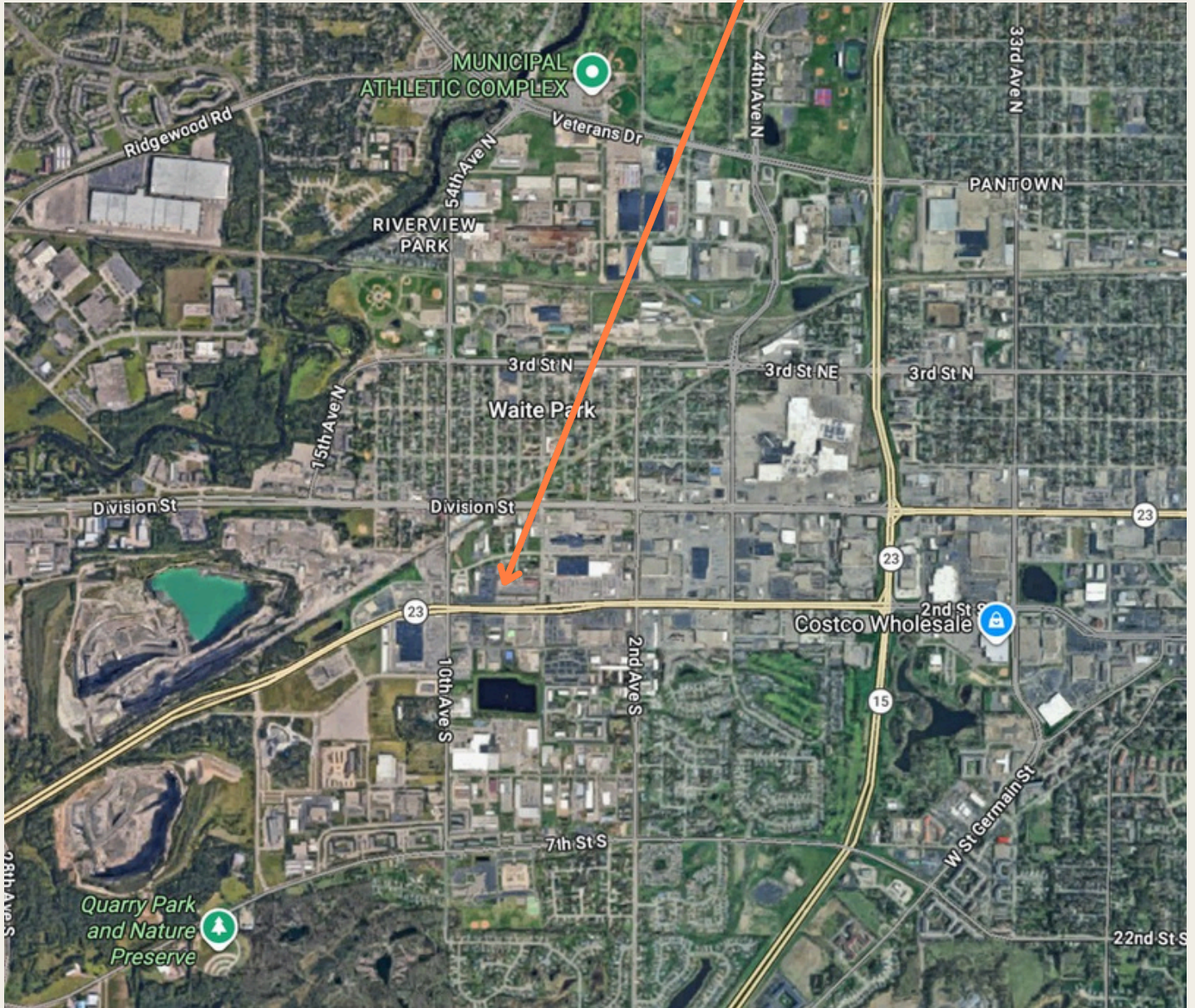

**SAM JOHNSON**  
BROKER, OWNER

## CONTACT

 320-420-1177

 sam@parcel.properties

 parcel.properties



**TANNER NORDLUND**  
Commercial Agent

## CONTACT

 320-828-0395

 tanner@parcel.properties

 parcel.properties

# Pictures



**SAM JOHNSON**  
BROKER, OWNER

## CONTACT

 320-420-1177

 sam@parcel.properties

 parcel.properties



**TANNER NORDLUND**  
Commercial Agent

## CONTACT

 320-828-0395

 tanner@parcel.properties

 parcel.properties

**Parcel**  
REAL ESTATE

**Thank  
You!**

**Let's Get  
In Touch**

**Contact us:**

sam@parcel.properties  
320-420-1177

tanner@parcel.properties  
320-828-0395

**Visit our website:**  
Parcel.Properties