

Industrial | For Lease

10170 Croydon Way, Suite G

Sacramento, CA 95827



CONTACT US:

ZAC SWEET, SIOR

Senior Vice President
C: +1 916 717 4768
zac.sweet@cbre.com
Lic. 01352800

TYLER HOWELL

Senior Associate
T: +1 916 781 4835
tyler.howell1@cbre.com
Lic. 02100245

COURTNEY LEE

Associate
C: +1 916 906 5544
courtney.lee@cbre.com
Lic. 02031694



Industrial Unit Available

10170 Croydon Way Suite G | Sacramento, CA 95827

For Lease

Property Information

- Total Area: ±28,100 Square Feet*
- Office Area: ±2,024 Square Feet
- Warehouse Area: ±26,076 Square Feet
- Up to ±30,000 Square Feet of Yard Area
- Clear Height: ±20 - 24 Feet
- Grade Level Doors: Seven (7)
- Dock High Doors: One (1)
- 300 Amps of Power* (Ability to expand to 1000 Amps)*
- Sprinklered
- Convenient Access to Hwy. 50
- Secured Complex

* Tenant to Independently Verify

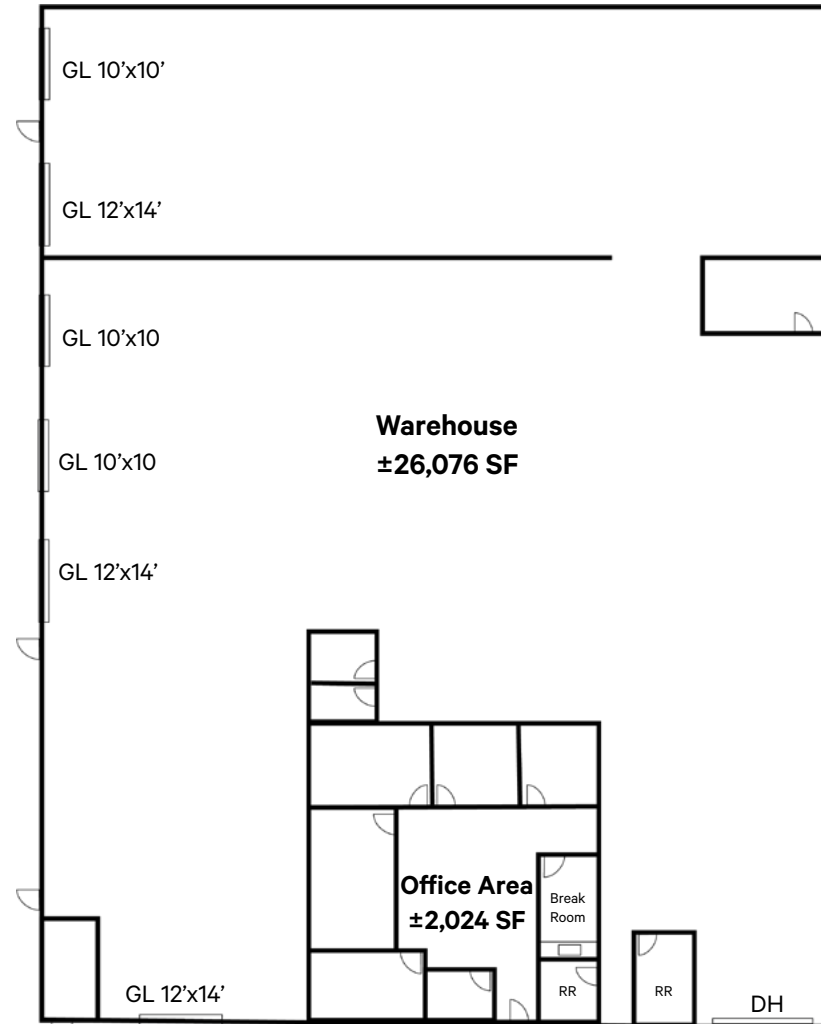

FLOOR PLAN NOT TO SCALE
GL: Grade Level Door
DH: Dock Level Door

Industrial Unit Available

10170 Croydon Way Suite G | Sacramento, CA 95827

For Lease

Aerial Maps

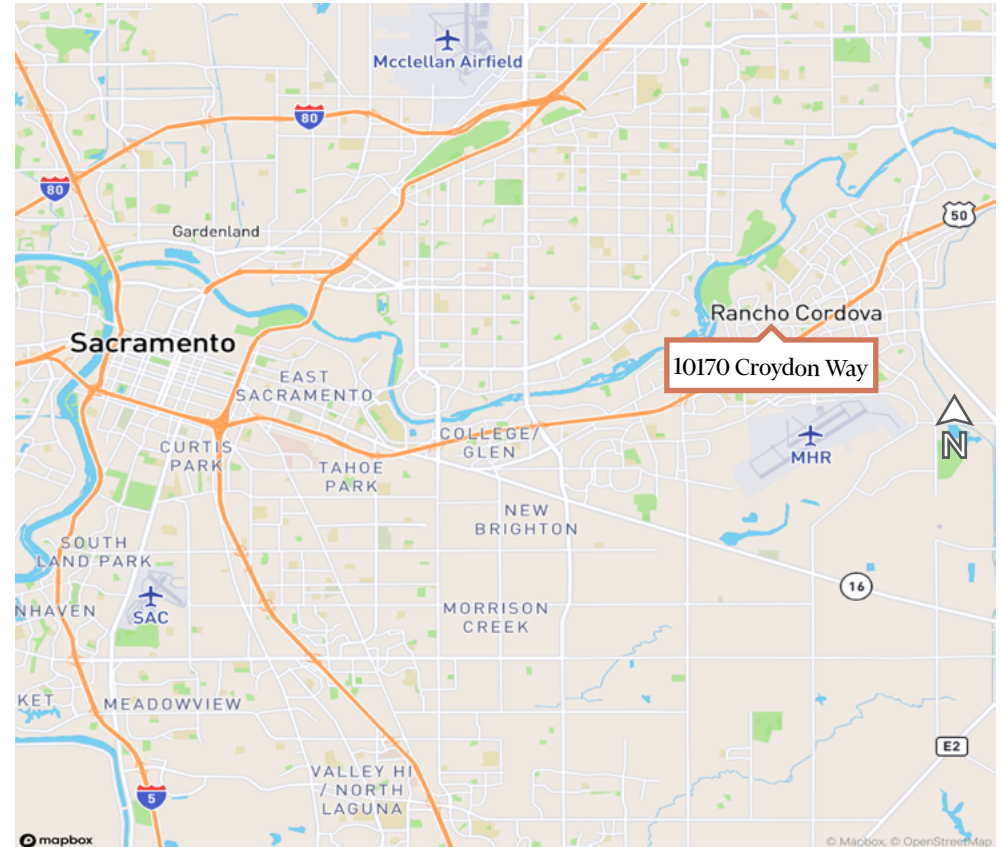

MAPS NOT TO SCALE

© 2025 CBRE, Inc. All rights reserved. This information has been obtained from sources believed reliable but has not been verified for accuracy or completeness. CBRE, Inc. makes no guarantee, representation or warranty and accepts no responsibility or liability as to the accuracy, completeness, or reliability of the information contained herein. You should conduct a careful, independent investigation of the property and verify all information. Any reliance on this information is solely at your own risk. CBRE and the CBRE logo are service marks of CBRE, Inc. All other marks displayed on this document are the property of their respective owners, and the use of such marks does not imply any affiliation with or endorsement of CBRE. Photos herein are the property of their respective owners. Use of these images without the express written consent of the owner is prohibited.