

3001 S. 23RD AVENUE
GREELEY, CO 80631

WAREHOUSE SPACE FOR SUBLEASE

PRICE REDUCED



Lease Rate: ~~\$4,000~~ \$3,000/Month/Gross
Includes Utilities



**CUSHMAN &
WAKEFIELD**

PROPERTY DETAILS



Dock high



Zoning C-H Greeley



Mezzanine space



**Located in high
retail traffic area**



**Ramp access with
double man door**



**16'8" clearance;
7'11" clearance in
the mezz area**



**Full truck
turnaround area
for easy access**

AVAILABLE

8,900 SF
TOTAL

4,000 SF
MEZZANINE

4,900 SF
1ST FLOOR

FLOOR PLAN

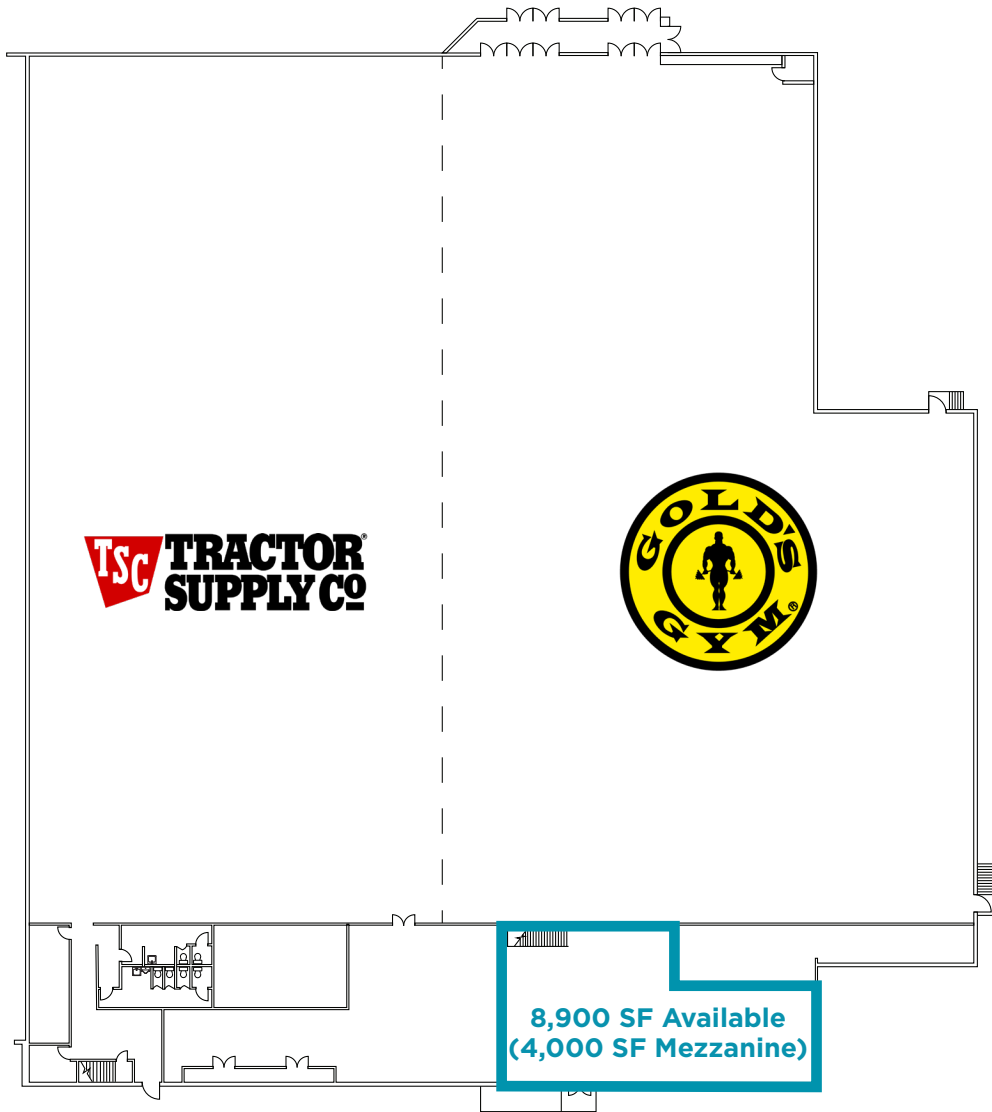



20TH STREET

47TH AVENUE



3001 S. 23rd Avenue
Greeley, CO 80631

37TH AVENUE

11TH AVENUE

	1 Mile	3 Miles	5 Miles
2024 Population	18,351	106,495	147,985
2029 Pop. Projection	21,602	125,403	147,985
2024 Households	6,684	38,155	52,628
Avg. Household Income	\$68,650	\$74,629	\$80,688
Source: CoStar, 2024			

FOR MORE INFORMATION PLEASE CONTACT:

JAMES ARNOLD
Senior Associate
+1 720 354 2059
james.arnold@cushwake.com

©2026 Cushman & Wakefield. All rights reserved. The information contained in this communication is strictly confidential. This information has been obtained from sources believed to be reliable but has not been verified. NO WARRANTY OR REPRESENTATION, EXPRESS OR IMPLIED, IS MADE AS TO THE CONDITION OF THE PROPERTY (OR PROPERTIES) REFERENCED HEREIN OR AS TO THE ACCURACY OR COMPLETENESS OF THE INFORMATION CONTAINED HEREIN, AND SAME IS SUBMITTED SUBJECT TO ERRORS, OMISSIONS, CHANGE OF PRICE, RENTAL OR OTHER CONDITIONS, WITHDRAWAL WITHOUT NOTICE, AND TO ANY SPECIAL LISTING CONDITIONS IMPOSED BY THE PROPERTY OWNER(S). ANY PROJECTIONS, OPINIONS OR ESTIMATES ARE SUBJECT TO UNCERTAINTY AND DO NOT SIGNIFY CURRENT OR FUTURE PROPERTY PERFORMANCE. PD-167167-V7

