

Bluff Plaza
2700 - 2716 28th Street, Boulder, CO

Prime Retail Space for Lease in Bluff Plaza

Michael-Ryan McCarty
mccarty@gibbonswhite.com
(303) 586-5939

Patrick Weeks
patrick@gibbonswhite.com
(303) 586-5935

www.gibbonswhite.com

Property Info & Gallery

View Map

Suite	Size	Lease Rate / sq. ft.
2714	1,800 sq. ft.	\$21.00 NNN
Expenses / sq. ft.		\$13.52*

**Not Including Utilities*

- High Visibility Retail & Turn-Key Boutique Medical & Wellness Space in Central Boulder's Core Shopping District
- **Suite 2714** - Former Chiropractic Clinic, Ideal for Specialized Medical Practice, Skincare Boutique, or Professional Services: Featuring a Bright, Open-Concept Treatment or Collaborative Floor Complemented by Two Dedicated Private Consultation Rooms, a Welcoming Reception Area & Functional Layout Designed for Seamless Patient Flow
- Incredible Parking Ratio over 5/1,000 sq. ft.
- Traffic Counts 35,534 Vehicles per Day on 28th Street

© 2026 Gibbons-White, Inc.

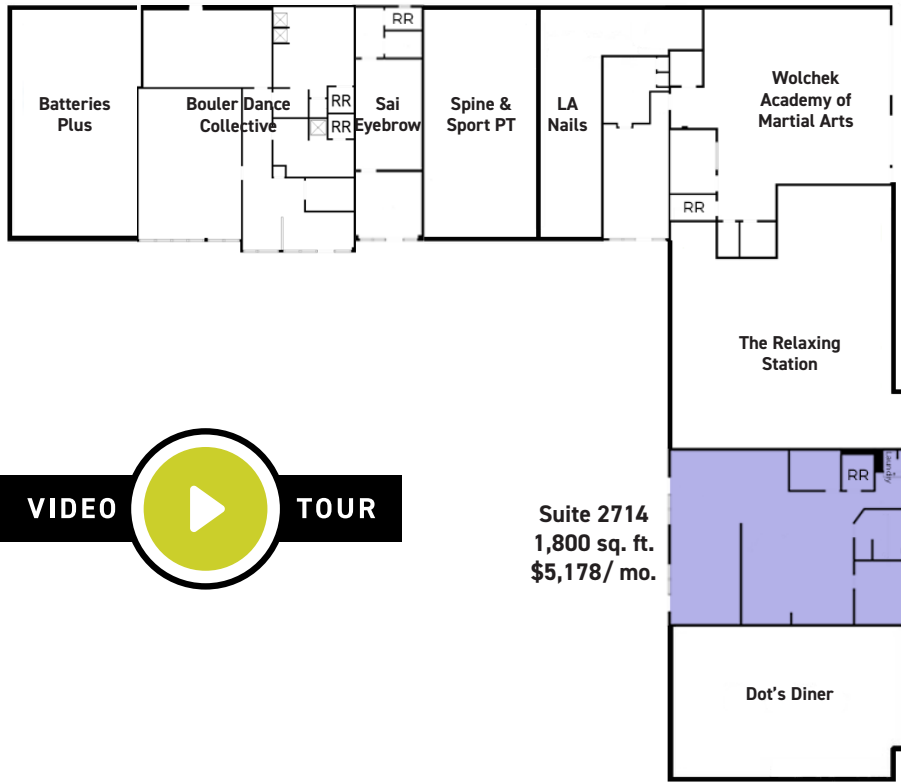

Suite 2714
1,800 sq. ft.
\$5,178/ mo.

