

THIS EXHIBIT IS RELEASED UNDER THE AUTHORITY OF NICHOLAS R. SANDLIN, P.E., TBPELS#124404, ON 9/15/2023, FOR THE PURPOSES OF REVIEW AND ARE NOT TO BE USED FOR CONSTRUCTION PRIOR TO APPROVAL BY THE APPLICABLE GOVERNMENT AUTHORITIES

THIS PLAN SET FOR REVIEW ONLY
NOT FOR CONSTRUCTION

SITE PLAN LEGEND	
	PROPOSED PROPERTY/PROJECT BOUNDARY LINE
	EXISTING R.O.W./PROPERTY LINE
	EXISTING EASEMENT LINE
	FIRE LANE
	PROPOSED CURB & GUTTER
	STREET CENTERLINE
	FENCE
	STRUCTURAL RETAINING WALL (BY OTHERS)
	PROPOSED CONCRETE SIDEWALK
	PROPOSED PARKING SPACES
	TRANSFORMER PAD
	SITE WALLS
	PHASING
	TAS ACCESSIBLE ROUTE
TAS ACCESSIBLE ROUTES MAY NOT EXCEED A CROSS SLOPE OF 1:50 (2%) OR EXCEED A RUNNING SLOPE OF 1:20 (5%) UNLESS DESIGNED AS A RAMP. THE MAXIMUM RUNNING SLOPE OF A RAMP IN NEW CONSTRUCTION IS 1:12 (8.33%). THE MAXIMUM RISE FOR ANY RAMP RUN IS 30 INCHES. REFER TO GRADING SHEET(S).	
	EX. WATER LINE
	EX. WASTEWATER
	EX. STORM SEWER LINE
	EX. FIRE HYDRANT
	EX. WATER METER
	EX. WASTEWATER MANHOLE
	FITTINGS AS NOTED
	GATE VALVE AS NOTED
	WW CLEAN OUT
	BACK FLOW PREVENTER
	PR. WATER LINE
	PR. FIRE LINE
	PR. WASTEWATER
	PR. STORM SEWER LINE
	PR. FIRE HYDRANT
	PR. WATER METER
	PR. WASTEWATER MANHOLE
	FLOW ARROW
	EX. UTILITY POLE

STATE OF TEXAS - PARCEL 23
DOCUMENT NUMBER 2013-00002035
B.C.O.P.R.

STATE OF TEXAS - PARCEL 25
DOCUMENT NUMBER 2011-20238
B.C.O.P.R.

IH 35
(ROW WIDTH VARIES)

LIFE ESTATE TO A.N. STANDARD
DOCUMENT NUMBER 2010 - 00035365
B.C.O.P.R.

FRED MICHAEL HENNINGER, ET UX -
NORTH TRACT
VOLUME 3152, PAGE 78
B.C.O.P.R.

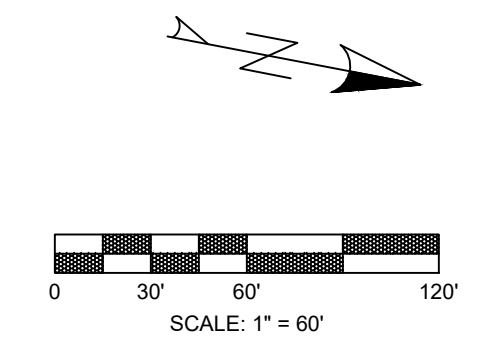
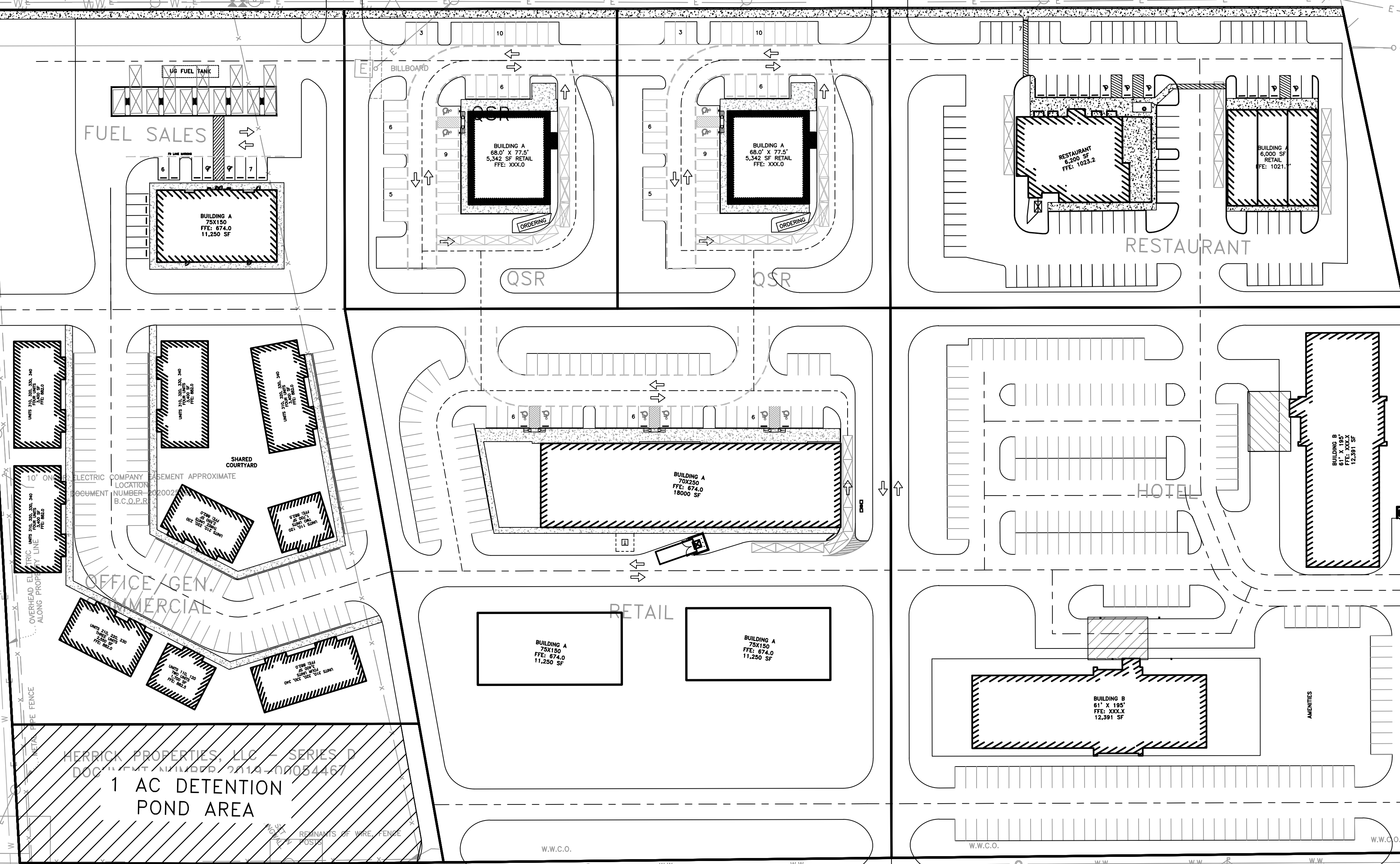

IF DRAWING BAR DOES NOT MEASURE 2"
THIS PRINT IS NOT TO SCALE

WARNING !!! CONTRACTOR TO FIELD VERIFY ALL EXIST. UTILITIES VERTICALLY AND HORIZONTALLY PRIOR TO CONSTRUCTION. THE CONTRACTOR IS TO CONTACT ENGINEER IF ANY EXISTING UTILITY INFORMATION DIFFERS FROM DATA SHOWN IN THE PLANS. CALL 811 BEFORE YOU DIG.

ENGINEERING | CONSULTING
SANDLIN
SERVICES, LLC

TBPELS FIRM #21356
4501 WHISPERING VALLEY DRIVE UNIT 27 AUSTIN, TX 78727

SITE PLAN EXHIBIT

LAMPASAS RIVER
COMMERCIAL

G:\Shared drives\Sandlin Services LLC\Sandlin Services Projects\Land Development\Division\01-0032-007 Lampasas River Commercial\CAD\Exhibits\2023\0005 - Lampasas River Comm - Turn Lane Exhibit.dwg-Model Plotted Oct 05, 2023 at 11:37am by [4+9] Last Saved by: Scott