

PETOSKEY TOWN CENTER



MID-AMERICA®
Real Estate-Michigan, Inc.

1305-1401 Spring Street / Petoskey, MI

FOR LEASE



RETAIL OPPORTUNITY

PETOSKEY TOWN CENTER



Address

1305 Spring Street
Petoskey, MI 49770



Availability

- 020: 12,150 SF
- 040: 4,000 SF
- 080: 1,600 SF
- 090: 1,600 SF
- 100: 6,400 SF
- 129: 31,896 SF
- 140: 53,360 SF

***Can Combine: 31,896 - 85,256 SF**

Features

Prominently located on Spring Street in the heart of Petoskey, the Petoskey Town Center is anchored by Hobby Lobby and Big Lots along with many other national and local users. The average household income is over \$95,000 within a five mile radius. The property sits in one of the largest tourist locations in Northern Michigan. Opportunities for small shop, junior box and big box leasing. Floor plans available for each unit, please request.

Co-Tenants



Demographics (2024)

	1 MILE	3 MILES	5 MILES
POPULATION	4,003	10,009	14,637
HOUSEHOLDS	1,992	4,766	6,635
AVG HOUSEHOLD INCOME	\$99,732	\$110,424	\$116,176
DAYTIME POPULATION	9,678	17,015	22,350

PETOSKEY TOWN CENTER

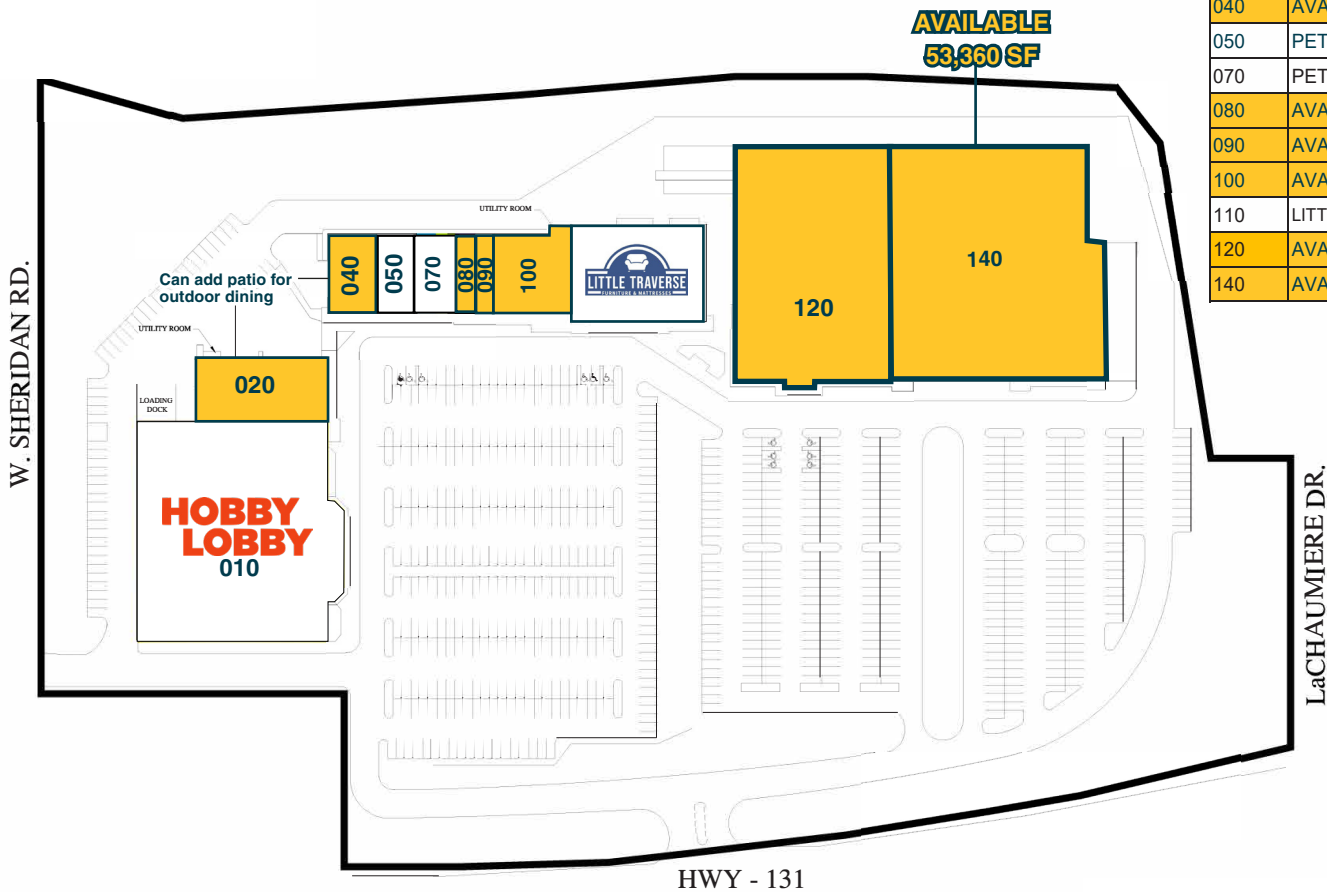

SPACE	NAME	SF
010	HOBBY LOBBY	42,241 SF
020	AVAILABLE	12,150 SF
040	AVAILABLE	4,000 SF
050	PETOSKEY BRIDAL	3,200 SF
070	PETOSKEY SEWING CENTER	3,200 SF
080	AVAILABLE	1,600 SF
090	AVAILABLE	1,600 SF
100	AVAILABLE	6,400 SF
110	LITTLE TRAVERSE FURNITURE & MATTRESS	14,000 SF
120	AVAILABLE	31,896 SF
140	AVAILABLE	53,360 SF

PETOSKEY TOWN CENTER

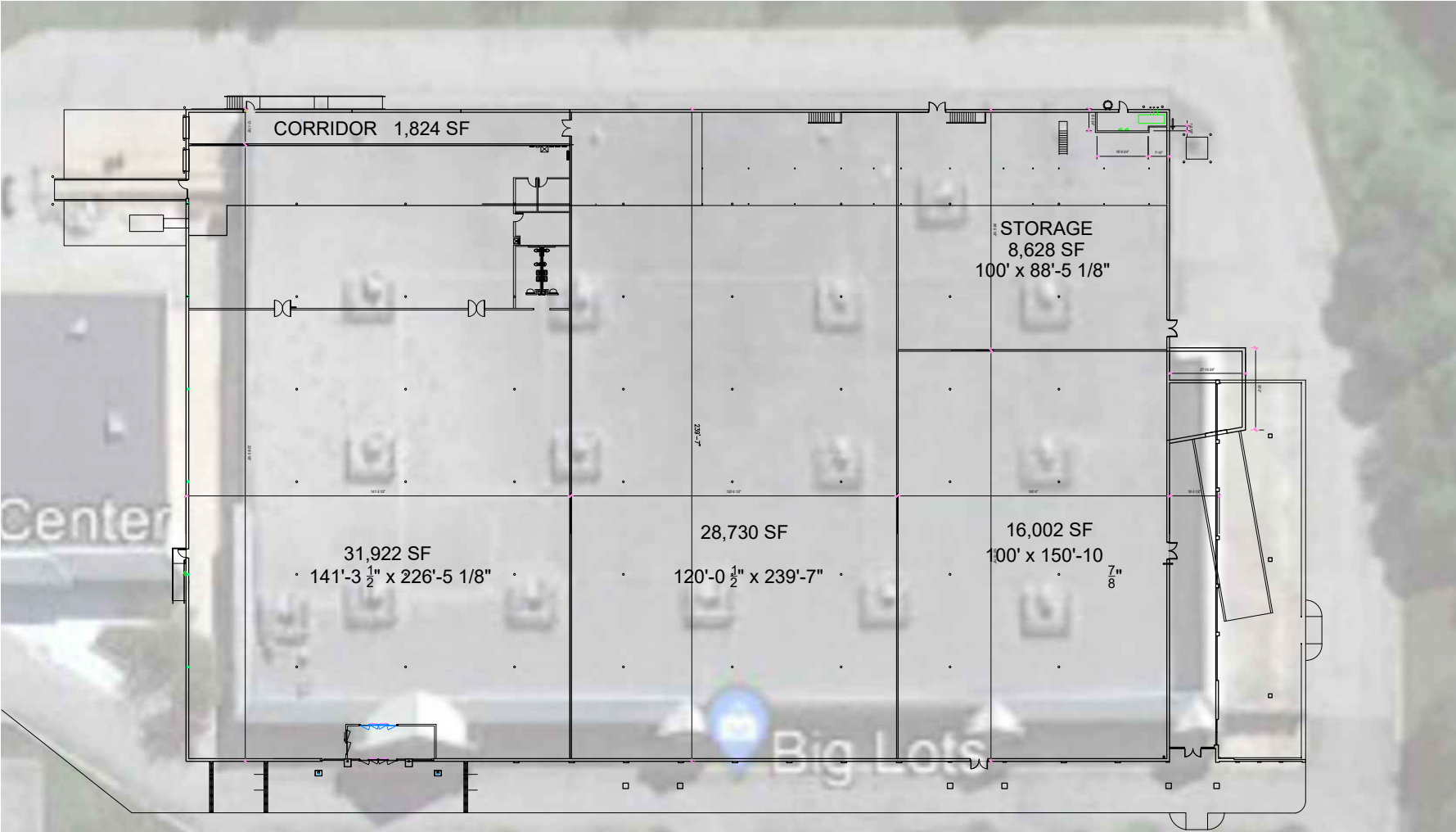

 LEASE PLAN
SCALE: 1/16" = 1'-0"

SITE PLAN - DEMISE OF FORMER K MART

PETOSKEY TOWN CENTER



AERIAL

PETOSKEY TOWN CENTER



Lindsey
Shaw

Mid-America Real Estate -
Michigan, Inc.

T: 248.855.6800

LShaw@MidAmericaGrp.com

Karen
Gargaro

Mid-America Real Estate -
Michigan, Inc.

T: 248.855.6800

KGargaro@MidAmericaGrp.com



38500 Woodward Ave, Suite 100
Bloomfield Hills, Michigan 48304
248.855.6800

MidAmericaGrp.com

CONTACT