



**COLDWELL BANKER
COMMERCIAL**
BROKERS
OF THE VALLEY

38 Executive Court Napa, CA



Industrial Space for Lease

Property Details

- ±20,000 SF Building
- ±6,580 SF Premises
- ±4,890 Warehouse with Roll-Up Door
- ±1,600 SF Office Space
- 4 Private Offices
- Break Room & Two Restrooms
- Good Parking

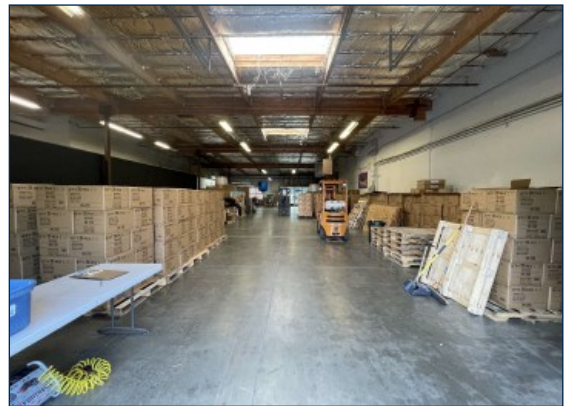

\$1.40 SF/Mo. MG ~ Zoning: Industrial Park (IP)



Michael Moffett
License #00946472
707.479.1976
mmoffett@cnapavalley.com

1775 Lincoln Ave.
Napa, CA 94558

Cathy D'Angelo Holmes

License #01355085
707.304.3338
cholmes@cnapavalley.com





**COLDWELL BANKER
COMMERCIAL**
BROKERS
OF THE VALLEY

38 Executive Court Napa, CA

FLOORPLAN

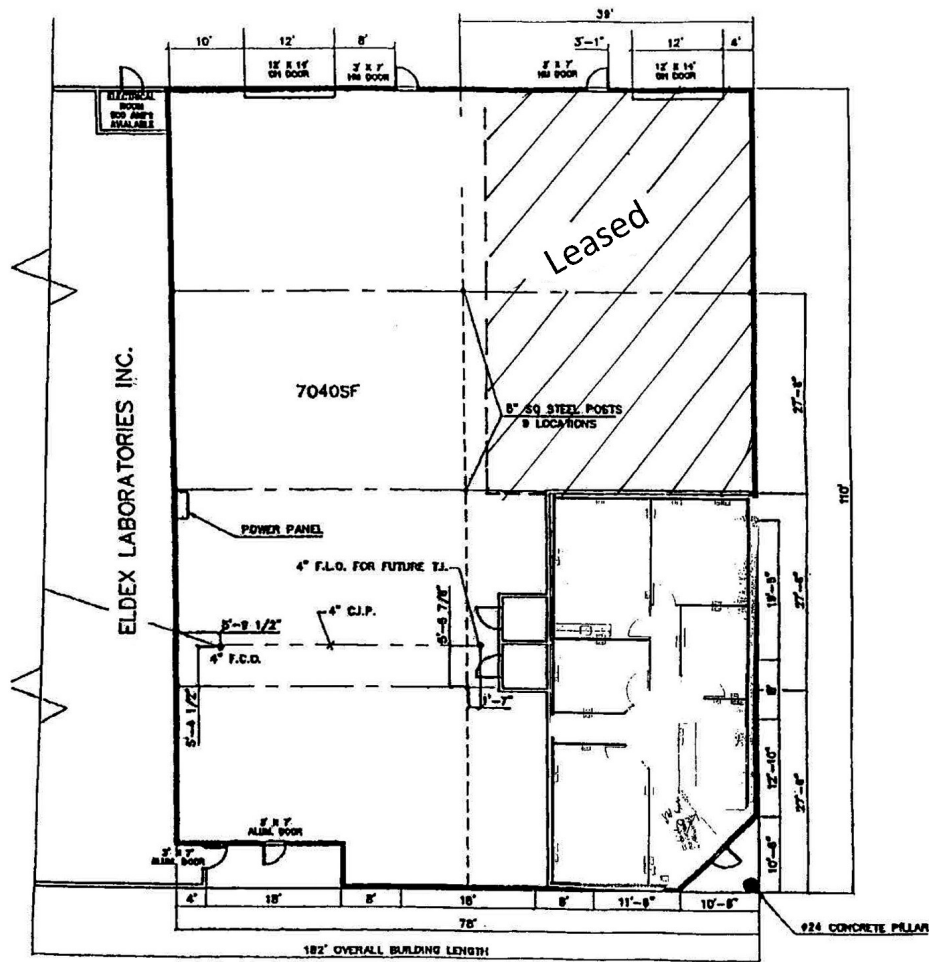

36-38 EXECUTIVE COURT

Napa, CA 94558
ELDEX BUILDING



Michael Moffett
License #00946472
707.479.1976
mmoffett@cnapavalley.com

1775 Lincoln Ave.
Napa, CA 94558

Cathy D'Angelo Holmes

License #01355085
707.304.3338

cholmes@cnapavalley.com

