

1355 W. 52nd Ave

Denver, CO 80221

40,000 SF Sublease Available in Central Denver

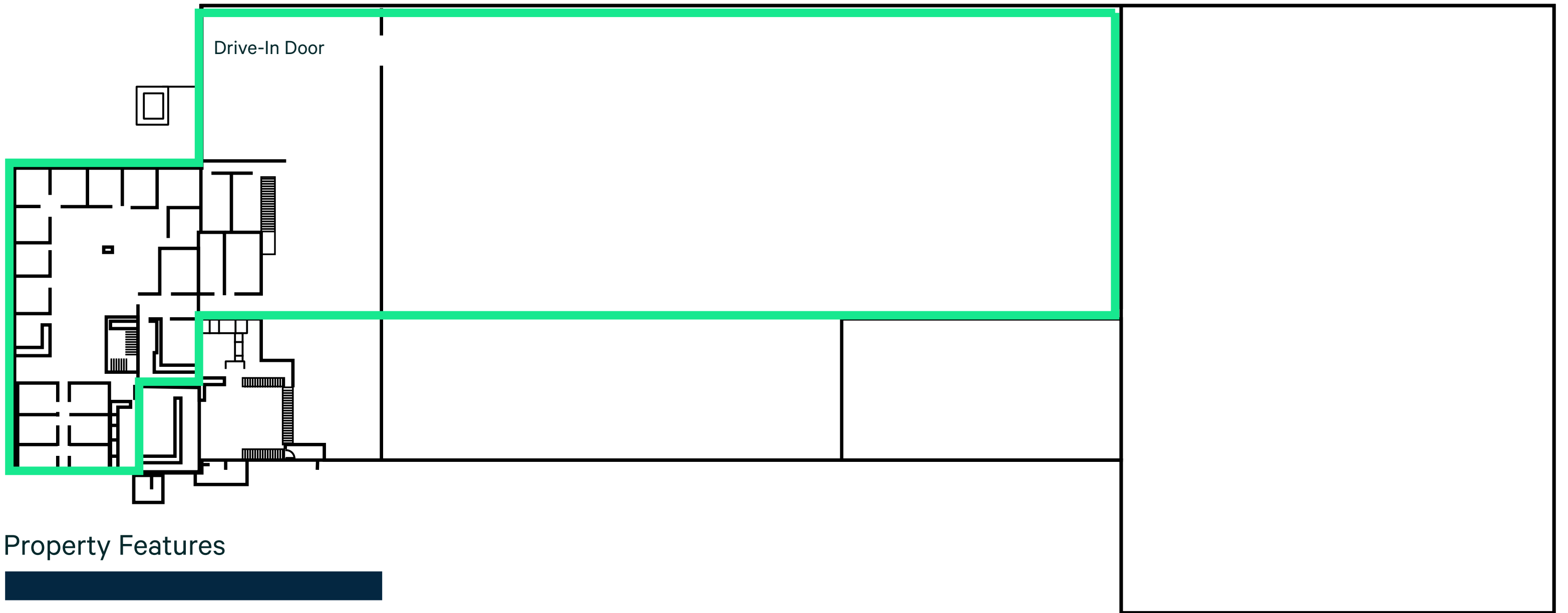



Property Features

AVAILABLE SF	40,000 SF
LOADING	1 oversized drive-in door
CLEAR HEIGHT	±20'-6" - 34'
YEAR BUILT	1999
SPRINKLERS	Yes
SUBLEASE TERM	Term through March 31, 2030
SUBLEASE RATE	\$5.95/SF Gross





Excellent access to I-70, I-25 & I-76



Central Denver location



Oversized Drive-in loading door



Building is sprinklered



±20'-6" - 34' clear height

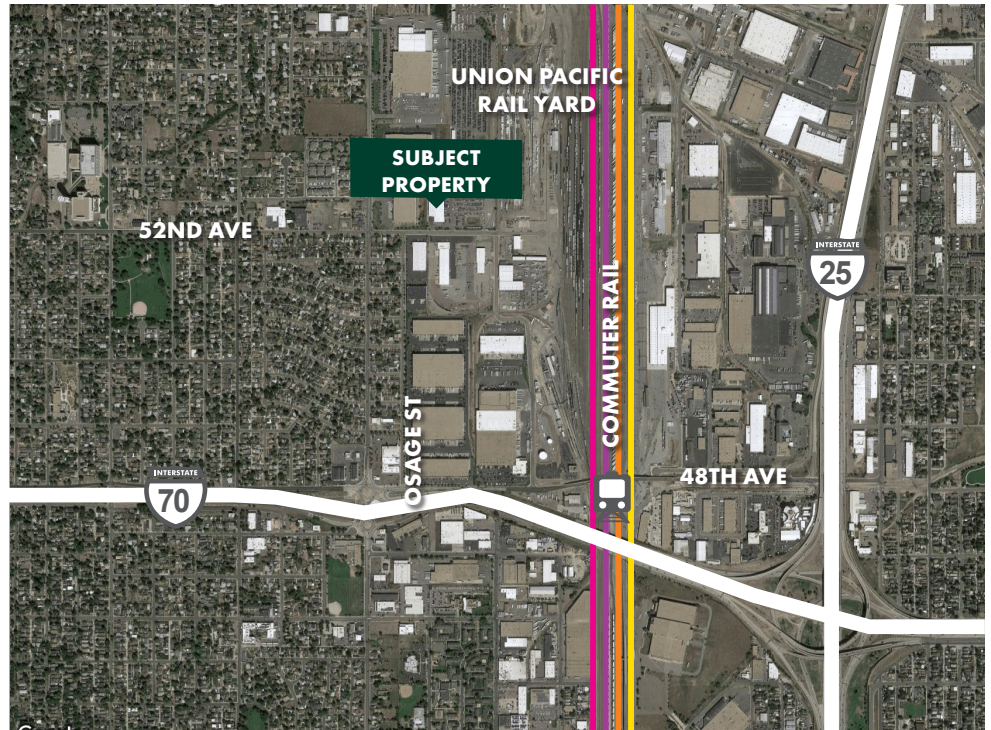

Contact Us

Matt Kawulok

First Vice President
+1 720 528 6353
matt.kawulok@cbre.com

Mike Camp

Executive Vice President
+1 720 528 6313
mike.camp@cbre.com

© 2026 CBRE, Inc. All rights reserved. This information has been obtained from sources believed reliable, but has not been verified for accuracy or completeness. You should conduct a careful, independent investigation of the property and verify all information. Any reliance on this information is solely at your own risk. CBRE and the CBRE logo are service marks of CBRE, Inc. All other marks displayed on this document are the property of their respective owners, and the use of such logos does not imply any affiliation with or endorsement of CBRE. Photos herein are the property of their respective owners. Use of these images without the express written consent of the owner is prohibited.