

FOR SUBLEASE

PRIME LAB & OFFICE SPACE

26 Landsdowne Street, Cambridge, MA

APPROXIMATELY 4,000-14,700 SF ON THE 1ST FLOOR



AVAILABLE
IMMEDIATELY



FELXIBLE TERM,
THROUGH SEP 28



PARKING RATIO:
1.5/1,000 SF



26 LANDSDOWNE STREET

FIRST FLOOR PLAN | ~4,000-14,700 SF SPACE AVAILABLE



OFFICE SPACE



BIOLOGY LAB

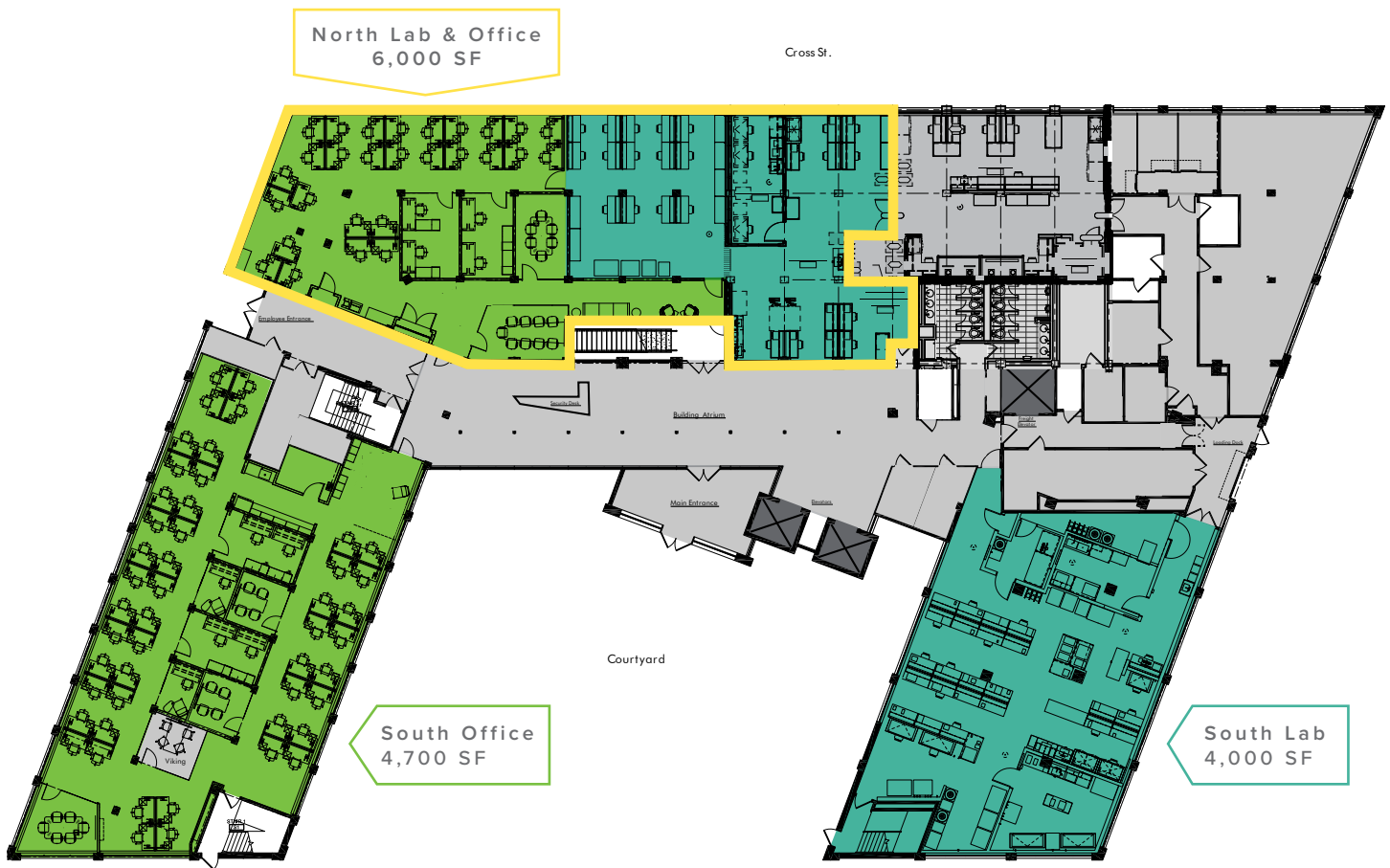

SOUTH OFFICE & LAB DETAILS: 8,700 SF

- South Office: 4,700 SF**
- + 48 Workstations
 - + 1 Small Conference Room
 - + 3 Huddle Rooms
 - + 2 Double Private Offices
 - + 2 Single Private Offices
 - + Kitchen/Cafe
- South Lab: 4,000 SF**
- + 1 Tissue Culture Room
 - + 2 Six Foot Fume Hoods
 - + 20 Lab Benches

NORTH OFFICE & LAB DETAILS: 6,000 SF

- North Office: 3,200 SF**
- + 28 Workstations
 - + 1 Large Conference Room
 - + 1 Medium Conference Room
 - + 2 Double Private Offices
- North Lab: 2,800 SF**
- + 1 Tissue Culture Room
 - + 1 Six Foot Fume Hood
 - + 25 Lab Benches

SHARED LAB SERVICES:

- + DENS Facility Services
- + Glasswash & Autoclave
- + Loading Dock oversight for daily shipping/receiving needs

LIFE SCIENCE CLUSTER



AMENITY MAP

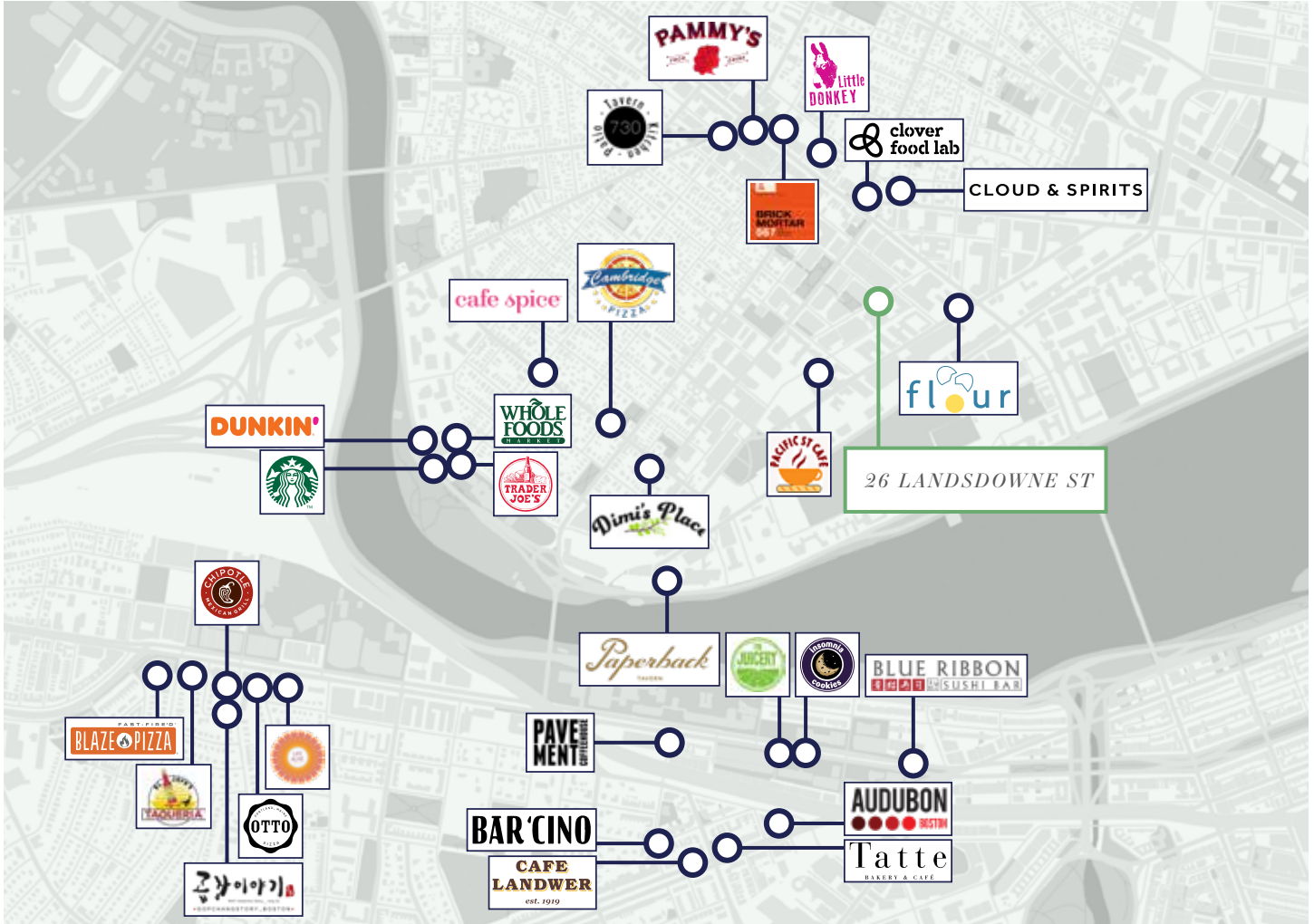

PLEASE CONTACT:

Jon Varholak

Vice Chairman
+1 617 439 8688

jon.varholak@cbre.com

Eric Smith

Vice Chairman
+1 617 933 0176

eric.smith2@cbre.com

McKenna Repko

Senior Vice President
+1 617 936 2295

mckenna.repko@cbre.com

Lauren Drakeley

Associate
+1 617 912 6944

lauren.drakeley@cbre.com

© 2024 CBRE, Inc. All rights reserved. This information has been obtained from sources believed reliable, but has not been verified for accuracy or completeness. You should conduct a careful, independent investigation of the property and verify all information. Any reliance on this information is solely at your own risk. CBRE and the CBRE logo are service marks of CBRE, Inc. All other marks displayed on this document are the property of their respective owners, and the use of such logos does not imply any affiliation with or endorsement of CBRE. Photos herein are the property of their respective owners. Use of these images without the express written consent of the owner is prohibited.

