

FOR SUBLEASE

CBRE

2 ST. CLAIR AVENUE WEST

2ND FLOOR

Private area with 23 sit stand desks, and access to amenities



BRIAN PORTER*
Senior Vice President
416 847 3242
Brian.Porter@cbre.com

JENNIFER RYDER*
Vice President
416 815 2351
Jennifer.Ryder@cbre.com

*Sales Representative

CBRE LIMITED, Real Estate Brokerage
145 King Street West, Suite 1100
Toronto, ON | M5H 1J8 | www.cbre.ca

SHARED SPACE SUBLEASE

Fully furnished built out space with 23 desks.
Access to boardrooms, kitchen, banquette,
and game lounge.

Availability Details

Term	12 months
Available	Immediately
Asking Rent	Contact listing Agent



Lounge



Boardrooms



Kitchen



Shared Office Space

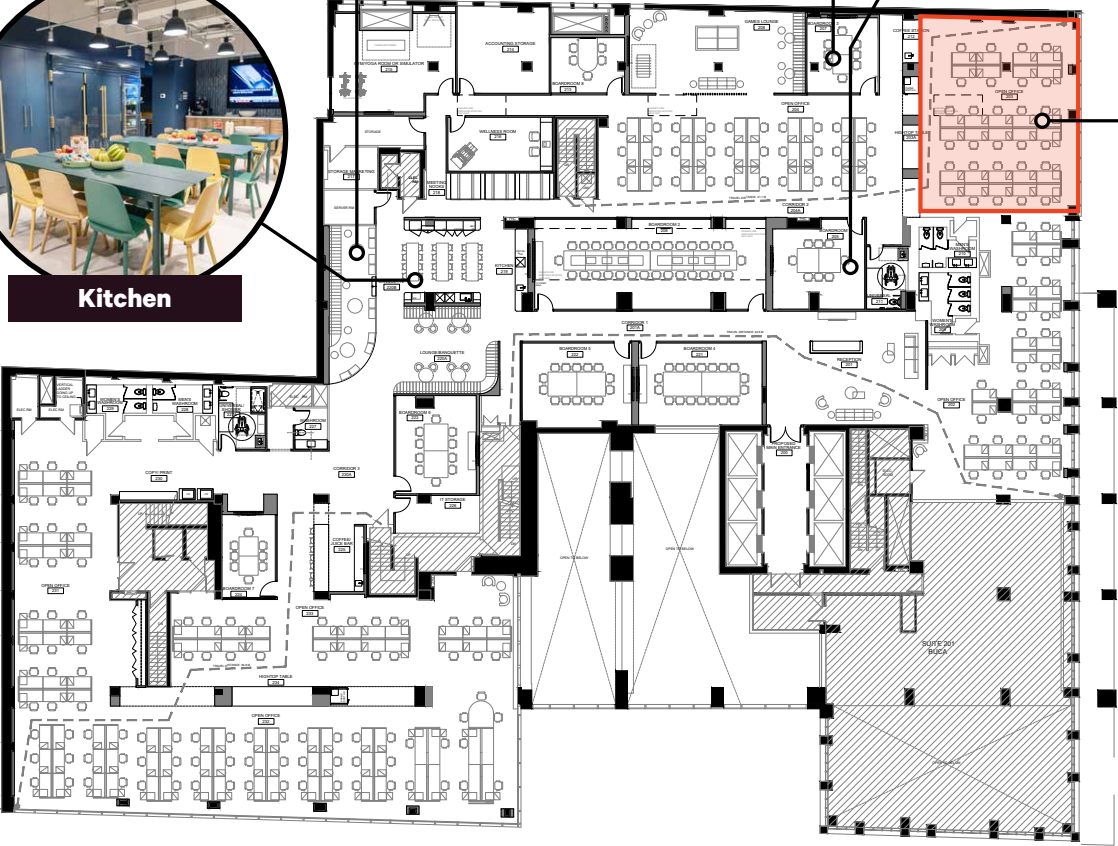

AMENITY MAP

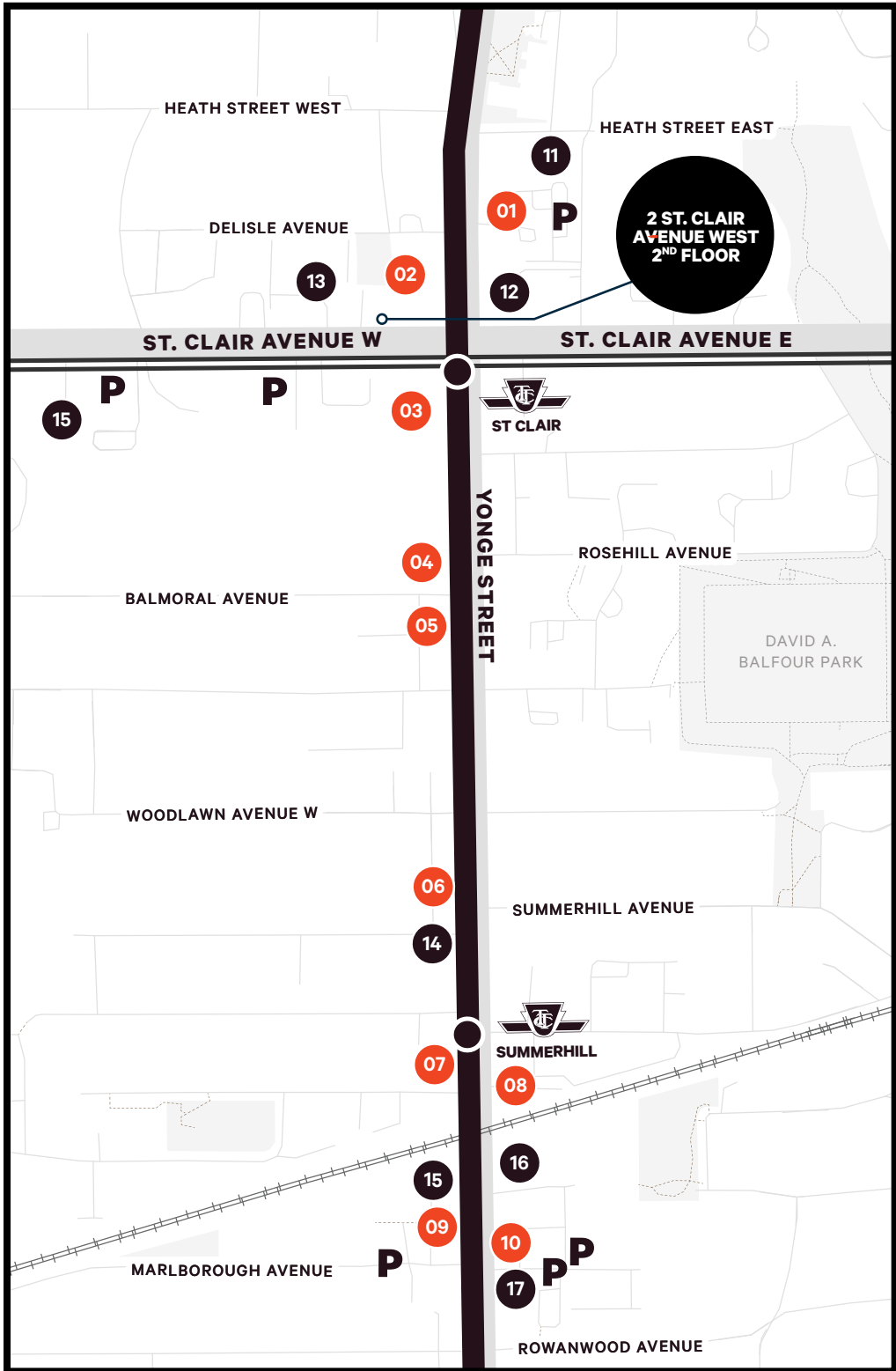

Food & Drinks

01. Starbucks
Ultra Restaurant
La Barista Cafe
Pizza Pizza
Tim Hortons
02. Lil E Coffee Cafe
Cucina Buca
Grandma loves you
03. Holy Chuck
Zelden's Deli and Desserts
Pizzaiolo
Mary Be Kitchen
The Bagel House
Union Social Eatery
Mary Be Kitchen
Kiva's Bagel Bar
04. Capocaccia Trattoria
Boccone Deli & Pizza
05. Barnsteiner's
06. Nutbar
Umami Poke
Taline
07. Impact Kitchen
Kibo Sushi - Summerhill
08. Sash
09. Sorrel
Manita Rosedale
10. Nadège Patisserie
Terroni
Bar Centrale

Shopping

11. Shoppers Drugmart
12. TD Canada Trust
Loblaws
Roots
Marquess Jewellers
13. LCBO
The Market by Longos
14. New Balance Toronto
15. The Detox Market
Walking On A Cloud
16. LCBO
17. Running Room

	Subway Line Station
	Streetcar
	Parking

2 ST. CLAIR AVENUE WEST

2ND FLOOR

BRIAN PORTER*

Senior Vice President

416 847 3242

Brian.Porter@cbre.com

JENNIFER RYDER*

Vice President

416 815 2351

Jennifer.Ryder@cbre.com

*Sales Representative

CBRE

CBRE Limited, Real Estate Brokerage, 145 King Street West, Suite 1100, Toronto, Ontario Canada, M5H 1J8 +1 416 362 2244, www.cbre.ca

This disclaimer shall apply to CBRE Limited, Real Estate Brokerage, and to all other divisions of the Corporation; to include all employees and independent contractors ("CBRE"). The information set out herein, including, without limitation, any projections, images, opinions, assumptions and estimates obtained from third parties (the "Information") has not been verified by CBRE, and CBRE does not represent, warrant or guarantee the accuracy, correctness and completeness of the Information. CBRE does not accept or assume any responsibility or liability, direct or consequential, for the Information or the recipient's reliance upon the Information. The recipient of the Information should take such steps as the recipient may deem necessary to verify the Information prior to placing any reliance upon the Information. The Information may change and any property described in the Information may be withdrawn from the market at any time without notice or obligation to the recipient from CBRE. CBRE and the CBRE logo are the service marks of CBRE Limited and/or its affiliated or related companies in other countries. All other marks displayed on this document are the property of their respective owners. All Rights Reserved.