



## 25 YOUELL STREET, FOOTSCRAY VIC 3011

### SENSATIONAL OPEN PLAN NEW YORK STYLE WAREHOUSE SUITABLE FOR A MULTITUDE OF USES.

Set in the great location just off Whitehall street with great Access into the Warehouse and ample off Street Parking. - Warehouse 250 sqmtrs approx with extremely high ceilings - 50 sqmtr office - Easy access to Footscray and Dynon Roads and the new Western Distributor Call today for further details and inspection. **For more information please visit our website.**

Disclaimer: In preparing this brochure, Nicholas Scott and it's related franchisees has relied in good faith upon information provided by others and has made all reasonable efforts to ensure that the information is correct. The accuracy of the information provided to you (whether written or verbal) cannot be guaranteed. If you are considering this property, you must make all enquiries necessary to satisfy yourself that all information is accurate.

## FOR RENT

Contact Agent



Nicholas Skapoulas - 0418 371

558

nicholas@nicholasscott.com.au

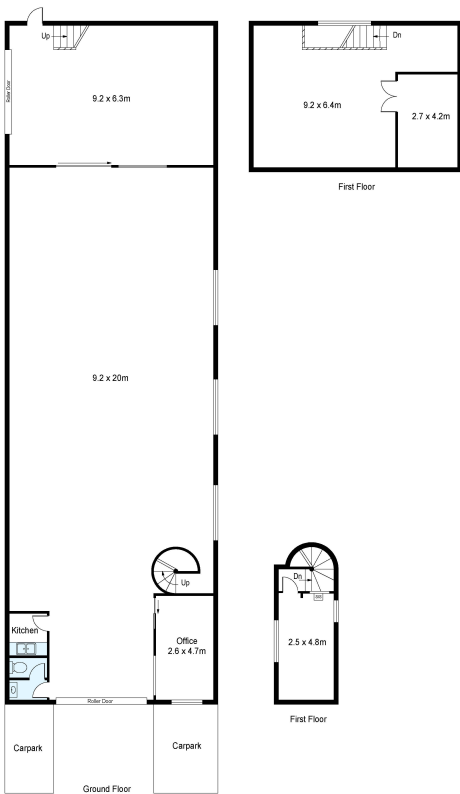

Scale in metres indicative only. Dimensions are approximate. All information contained herein is gathered from sources we believe to be reliable. However we cannot guarantee its accuracy and interested persons should rely on their own enquiries.



25 Youell Street, Footscray