

# FOR LEASE

# 8,900 SF

INDUSTRIAL UNIT  
PRICING | \$1.10 NNN

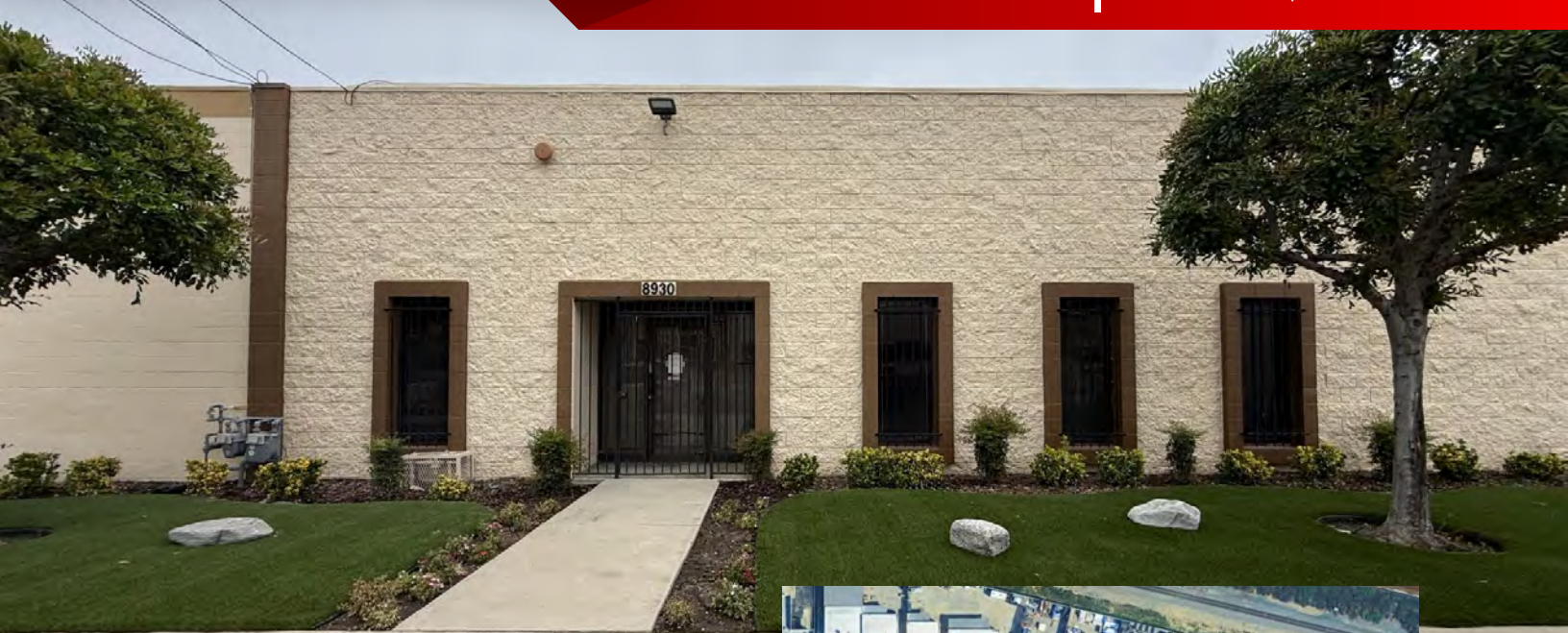







8930

**QUARTZ AVENUE**

NORTHRIDGE, CA

## PROPERTY HIGHLIGHTS

-  PRIDE OF OWNERSHIP & TROPHY UNIT
-  AMAZING NORTHRIDGE LOCATION
-  CLEAR SPAN WAREHOUSE
-  14' MINIMUM CLEARANCE
-  MINIMAL OFFICE SF
-  2 GROUND LEVEL DOORS
-  SHARED YARD W/ 2:1000 PARKING

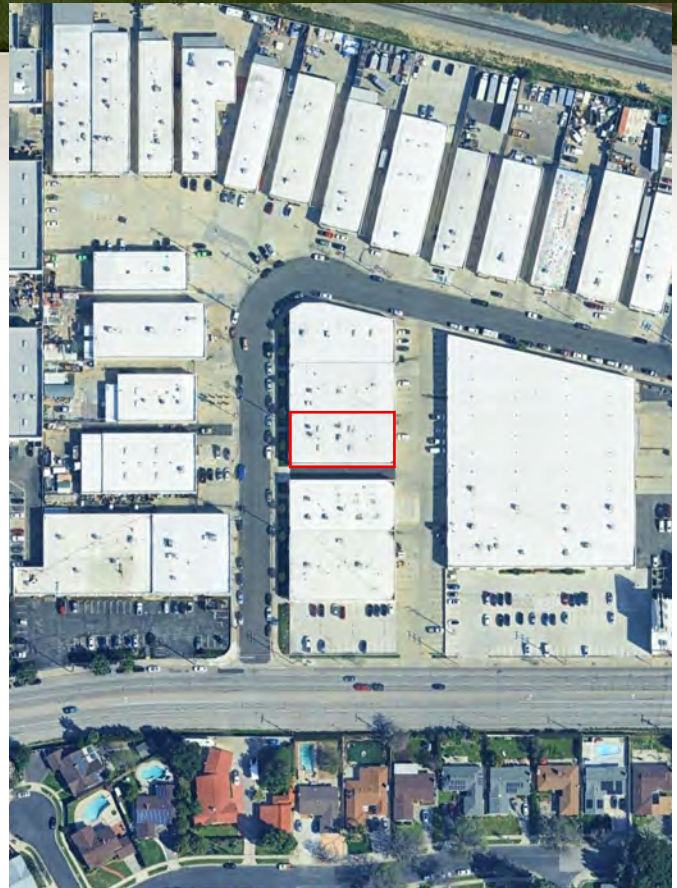

[spectrumcre.com](http://spectrumcre.com) | 818.252.9900

**SPECTRUM**  
COMMERCIAL REAL ESTATE, INC.



**RON KASSAN**



Executive Vice President  
818.512.5001  
[ron@availablewarehouses.com](mailto:ron@availablewarehouses.com)  
CA DRE Lic. #01063078

**ART MINASSIAN**



Senior Vice President  
818.634.3722  
[art@availablewarehouses.com](mailto:art@availablewarehouses.com)  
CA DRE Lic. #02026662

No warranty, express or implied, is made as to the accuracy of the information contained herein. This information is submitted subject to errors, omission, change of price, rental or other conditions, withdrawal without notice, and is subject to any special listing conditions imposed by our principals. Cooperating brokers, buyers, tenants and other parties who receive this document should not rely on it, but should use it as a starting point of analysis, and should independently confirm the accuracy of the information contained herein through a due diligence review of the books, records, files and documents that constitute reliable sources of the information described herein. Spectrum Commercial Real Estate, Inc. CA DRE #02042805

8930

# QUARTZ AVENUE

NORTHRIDGE, CA

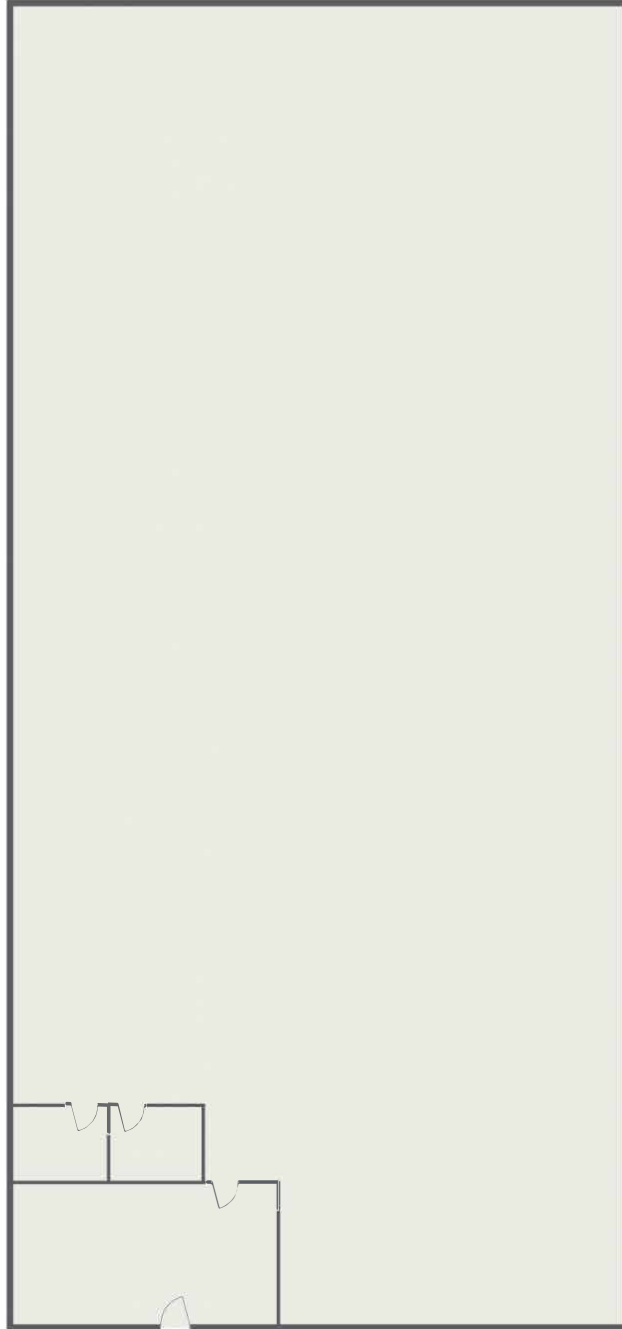

[spectrumcre.com](http://spectrumcre.com) | 818.252.9900

**SPECTRUM**  
COMMERCIAL REAL ESTATE, INC.



## RON KASSAN

*Executive Vice President*  
818.512.5001  
[ron@availablewarehouses.com](mailto:ron@availablewarehouses.com)  
CA DRE Lic. #01063078



## ART MINASSIAN

*Senior Vice President*  
818.634.3722  
[art@availablewarehouses.com](mailto:art@availablewarehouses.com)  
CA DRE Lic. #02026662



No warranty, express or implied, is made as to the accuracy of the information contained herein. This information is submitted subject to errors, omission, change of price, rental or other conditions, withdrawal without notice, and is subject to any special listing conditions imposed by our principals. Cooperating brokers, buyers, tenants and other parties who receive this document should not rely on it, but should use it as a starting point of analysis, and should independently confirm the accuracy of the information contained herein through a due diligence review of the books, records, files and documents that constitute reliable sources of the information described herein. Spectrum Commercial Real Estate, Inc. CA DRE #02042805